

# Sutton Court Road

Uxbridge • • UB10 9HT  
PCM: £2,000 PCM



coopers  
est 1986



A recently refurbished, three bedroom semi detached house situated located on the ever popular Oak Farm Estate offering access to a number of local amenities including local shops, Hillingdon's Metropolitan/Piccadilly line train station and a number of highly regarded local schools. The A40/ M40 with its links to London and the Home Counties are a short drive away.

Immaculate Condition

Three Bedrooms

Semi Detached

Driveway Parking

Private Rear Garden

Close To High Regarded Local Schools

Easy Access To Hillingdon Station

Council Tax Band D

Dining Area

Gas Central Heating

Available Date

11th June 2024

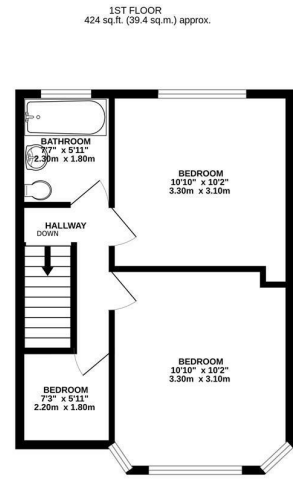
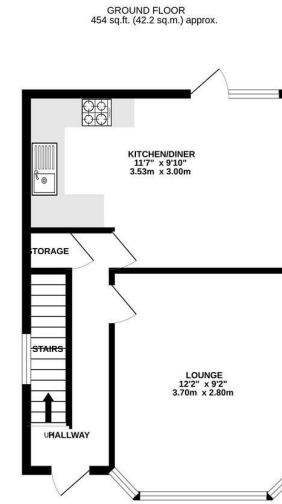

TOTAL FLOOR AREA: 878 sq.ft. (81.5 sq.m.) approx.  
Whilst every attempt has been made to ensure the accuracy of the floorplan contained here, measurements of rooms, windows, doors and any other items are approximate and no responsibility is taken for any error, omission or mis-statement. This plan is for illustrative purposes only and should be used as such by any prospective purchaser. The windows, doors and appliances shown have not even been used and no guarantee as to their operability or efficiency can be given.  
Made with Metronom CO234



01895 230 103

109 Hillingdon Hill, Hillingdon Village,  
Middlesex, UB10 0JQ  
propertymanagement@coopersresidential.co.uk

CoopersResidential.co.uk

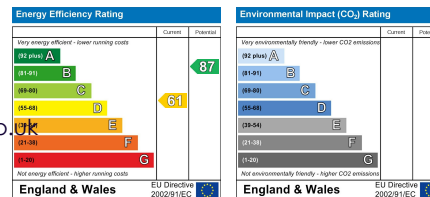

Important Notice: These particulars, whilst believed to be accurate are set out as a general outline only for guidance and do not constitute any part of an offer or contract. Intending purchasers should not rely on them as statements or representation of fact, but must satisfy themselves by inspection or otherwise has the authority to make or give any representation or warranty in respect of the property.

coopers  
est 1986