



HAMPSTEAD GARDENS

Temple fortune
London NW11



Two double bedrooms
£549,950
EPC Rating: C

A bright and beautifully presented two double bedroom ground floor garden flat situated within walking distance of Golders Green Tube station, Temple Fortune high end shopping facilities as well as Golders Greens local amenities and the Hampstead Heath.



The property comprises open plan living room/kitchen area with double doors leading to rear garden, Principal bedroom, bedroom two, family bathroom. There is potential for a rear extension to the property (subject to planning permission) and there is a patio rear garden.
Sole Agent.



- Two double bedrooms
- Spacious living room/kitchen Area
- Luxury family bathroom
- Private Rear garden
- Walking distance of Golders Green tube Station
- Close Proximity to Temple Fortune High End Shops and Hampstead Heath
- Sole Agent





Temple Fortune

Temple Fortune is an affluent and vibrant area situated in the London Borough of Barnet in the Northwest corner of Greater London. It borders Golders Green to the south, Hendon to the west and Finchley to the east. This charming community orientated area is a popular choice for families and professionals with multiple parks, playgrounds, and green spaces for children to explore, as well as a bustling shopping scene with plenty of independent shops, grocers, and cafes to choose from.

Additionally, the area has a range of primary schools, nurseries, and excellent transport links, making it easy to commute to various parts of the city. Temple Fortune is a fantastic location for those seeking a peaceful escape from the hustle and bustle of central London.



Floorplan

Approximate gross internal area

74.84 sqm / 805.45 sqft

The floor plan is not to scale and measurements and areas shown are approximate and therefore should be used for illustrative purposes only. The plan has been prepared in accordance with the RICS code of Measuring Practice and whilst we have confidence that the information, it must not be relied on. Maximum widths and lengths are represented on the floor plan. If there is any aspect of particular importance, you should carry out or commission your own inspection of the property.

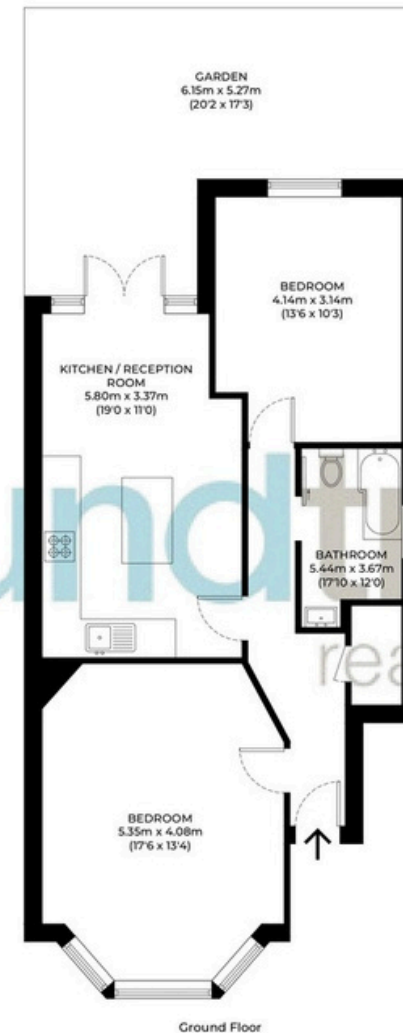

020 8203 2111
www.theroundtree.com

To register your interest:

020 8203 2111

sales@theroundtree.com

theroundtree.com

1 Sentinel Square, Brent Street Hendon, NW4 2EL



General: While we endeavor to make our sales particulars fair, accurate and reliable, they are only a general guide to the property and, accordingly, if there is any point which is of particular importance to you, please contact the office and we will be pleased to check the position for you, especially if you are contemplating travelling some distance to view the property. Measurements: These approximate room sizes are only intended as general guidance. You must verify the dimensions carefully before ordering carpets or any built-in furniture. Services: Please note we have not tested the services or any of the equipment or appliances in this property, accordingly we strongly advise prospective buyers to commission their own survey or service reports before finalizing their offer to purchase. THESE PARTICULARS ARE ISSUED IN GOOD FAITH BUT DO NOT CONSTITUTE REPRESENTATIONS OF FACT OR FORM PART OF ANY OFFER OR CONTRACT. THE MATTERS REFERRED TO IN THESE PARTICULARS SHOULD BE INDEPENDENTLY VERIFIED BY PROSPECTIVE BUYERS OR TENANTS. NEITHER ROUNDTREE NOR ANY OF ITS EMPLOYEES OR AGENTS HAS ANY AUTHORITY TO MAKE OR GIVE ANY REPRESENTATION OR WARRANTY WHATEVER IN RELATION TO THIS PROPERTY.