

roundtree

real estate



roundtree
real estate

Westchester Drive, Hendon NW4

£825,000



4



2



y

Freehold



BRITISH
PROPERTY
AWARDS

2022

★★★★★

GOLD WINNER

ESTATE AGENT
IN NW4



BRITISH
PROPERTY
AWARDS

2022 - 2023

★★★★★

GOLD WINNER

LETTING AGENT
IN NW4

A fresh approach to your property journey...

A stunning four bedroom town house arranged over three floors boasting modern and spacious accommodation throughout, a private patio leading to the communal gardens and off-street parking to the front.



- Four Double Bedrooms
- Two Bathrooms (One Ensuite)
- Spacious Living Room
- Large Kitchen/Dining room
- TV Room
- Ground floor Cloakroom
- Driveway with Off Street Parking
- Private Patio
- Chain Free
- Sole Agent





Extending to 1914sq.ft (177.83 sq. m) the property internally on the ground floor comprises a well presented fitted kitchen open to dining room with doors leading out to private patio, there is a further reception room, storage room and WC.



The first floor incorporates a light and airy living room overlooking the gardens and the master bedroom with generously sized ensuite. The second floor hosts a further three double bedrooms and family bathroom. The property is situated moments from a range of shops and amenities that can be found in Hendon. Chain Free. Sole Agent.

FLOOR PLAN



Westchester Drive, London NW4 1RD

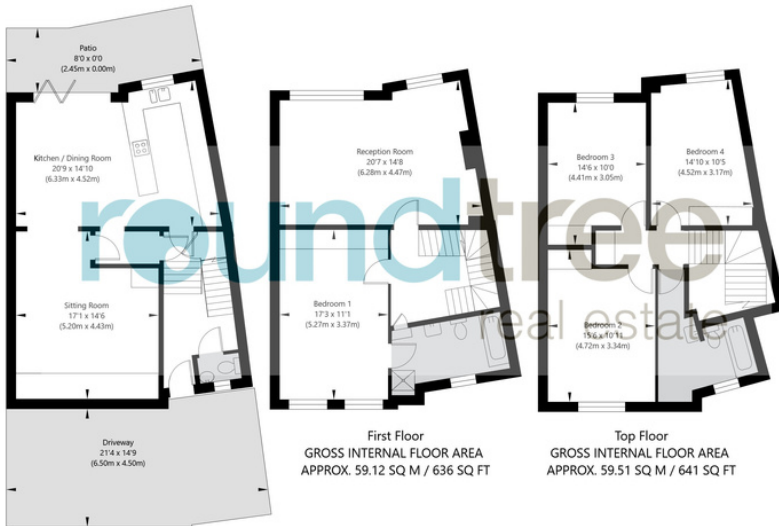

APPROXIMATE GROSS INTERNAL FLOOR AREA 177.83 SQ M / 1914 SQ FT
 THIS FLOOR PLAN IS FOR ILLUSTRATIVE PURPOSES ONLY AND
 SHOULD BE USED FOR THIS PURPOSE BY PROSPECTIVE APPLICANTS AS ITS NOT TO SCALE.

(c) AMBERSHORE PIX LIMITED / PHOTO - VIDEO - FLOOR PLANS / 0800 999 1577 / WWW.AMERSHOREPIX.CO.UK

EPC

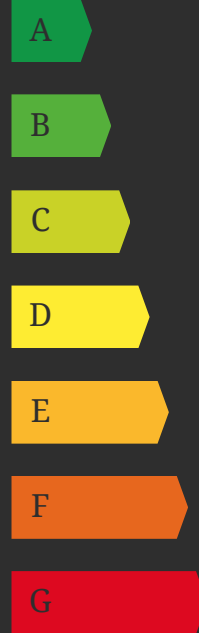

C

1 Sentinel Square, Brent Street
 Hendon, NW4 2EL

020 8203 21111

mail@theroundtree.com

theroundtree.com

Selling your home?

If you are considering selling your home please contact us today for your no obligation free market appraisal.

Our dedicated and friendly team will assist you.

Get in touch today!



General: While we endeavor to make our sales particulars fair, accurate and reliable, they are only a general guide to the property and, accordingly, if there is any point which is of particular importance to you, please contact the office and we will be pleased to check the position for you, especially if you are contemplating travelling some distance to view the property. Measurements: These approximate room sizes are only intended as general guidance. You must verify the dimensions carefully before ordering carpets or any built-in furniture. Services: Please note we have not tested the services or any of the equipment or appliances in this property, accordingly we strongly advise prospective buyers to commission their own survey or service reports before finalizing their offer to purchase. THESE PARTICULARS ARE ISSUED IN GOOD FAITH BUT DO NOT CONSTITUTE REPRESENTATIONS OF FACT OR FORM PART OF ANY OFFER OR CONTRACT. THE MATTERS REFERRED TO IN THESE PARTICULARS SHOULD BE INDEPENDENTLY VERIFIED BY PROSPECTIVE BUYERS OR TENANTS. NEITHER ROUNDTREE NOR ANY OF ITS EMPLOYEES OR AGENTS HAS ANY AUTHORITY TO MAKE OR GIVE ANY REPRESENTATION OR WARRANTY WHATSOEVER IN RELATION TO THIS PROPERTY.

A fresh approach to your property journey...