

BOND & SHERWILL



The Granary, Cross Oak Lane

Situated on impressive grounds in the Cross Oak Lane Conservation Area this three-bedroom, detached bungalow was built circa 1930 by the renowned architect, Blunden Shadbolt.

The interior of this character property benefits from wood beams, bay windows and an impressive fireplace in the dual-aspect living room. Additional rooms include master bedroom with fitted wardrobes, two further good-size bedrooms, one of which has a vaulted ceiling, a welcoming entrance hall, porch, dual-aspect dining room, contemporary kitchen, modern shower room and utility room.

A gated driveway leads to off-street parking for multiple vehicles and two joined garages with a workshop. The beautiful grounds which surround this impressive property include a summer house, apple tree and views over countryside.

Salfords Railway Station offers swift and easy access to a variety of destinations including London Bridge, London Victoria, Brighton & Gatwick Airport, while the A23 provides easy access to the South Coast and Gatwick Airport. Local shops include Sainsbury's Local and additional supermarkets along with further shopping opportunities, restaurants and gyms across Redhill & Crawley. The local area is renowned for its attractive countryside and miles of good walking and riding country. There is a number of local sports clubs and leisure facilities including the nearby Spa and Gym at Nutfield Priory.

Guide-Price: £775,000 - £800,000

BOND & SHERWILL

The Granary, Cross Oak Lane

Porch



Entrance Hall

The entrance hall includes electric heater and cupboard housing hot water cylinder.

Master Bedroom

The master bedroom is dual-aspect and includes fitted wardrobes, double-glazed leaded-light effect window, double-glazed three-casement leaded-light effect window and electric heater.



Bedroom Two

Bedroom two is dual-aspect and includes double-glazed leaded-light effect feature bay window, double-glazed three-casement leaded-light effect window and electric heater.



Bedroom Three

Bedroom three includes double-glazed two-casement leaded-light effect window, vaulted ceiling and electric heater.



These particulars are intended to give a fair description of the property but their accuracy cannot be guaranteed, and they do not constitute an offer of contract. Intending purchasers must rely on their own inspection of the property. None of the above appliances/services have been tested by ourselves. We recommend purchasers arrange for a qualified person to check all appliances/services before legal commitment.

BOND & SHERWILL

The Granary, Cross Oak Lane

Shower Room

The shower room includes shower area with shower head and wall-fixed controls, low-level W.C, wash-hand basin, two-casement double-glazed opaque window, chrome heated towel rail, extractor fan, tiled floor and tiled walls.



Living Room

The living room is dual-aspect and includes feature fireplace with brick surround, parquet flooring, two electric heaters, double-glazed two casement leaded-light effect window and double-glazed leaded-light effect feature bay window.



Dining Room

The dining room is dual-aspect and includes three double-glazed leaded-light effect windows, three-casement double-glazed leaded-light effect window and wooden flooring.



Kitchen

The kitchen includes base-level units with work surface area, under-mount sink with drainer & stainless-steel mixer tap, four-ring electric hob, oven with extractor hood, electric heater, wooden flooring, double-glazed three-casement leaded-light effect window, cupboard and pantry featuring double-glazed opaque window.



These particulars are intended to give a fair description of the property but their accuracy cannot be guaranteed, and they do not constitute an offer of contract. Intending purchasers must rely on their own inspection of the property. None of the above appliances/services have been tested by ourselves. We recommend purchasers arrange for a qualified person to check all appliances/services before legal commitment.

BOND & SHERWILL

The Granary, Cross Oak Lane

Utility Room

The utility room is dual-aspect and includes base-level units with work surface area, wooden flooring, space for washing machine, space for tumble dryer, space for American-style fridge-freezer, and double-glazed leaded-light effect window.



Garage One

Garage one includes up & over door, three windows and two internal windows.



Workshop

Garage Two

Garage two includes up & over door, three windows and two internal windows.



Grounds

The grounds include a summer house, range of trees including an apple tree, water tap, power points and a gated driveway offering off-street parking.



These particulars are intended to give a fair description of the property but their accuracy cannot be guaranteed, and they do not constitute an offer of contract. Intending purchasers must rely on their own inspection of the property. None of the above appliances/services have been tested by ourselves. We recommend purchasers arrange for a qualified person to check all appliances/services before legal commitment.

BOND & SHERWILL

The Granary, Cross Oak Lane

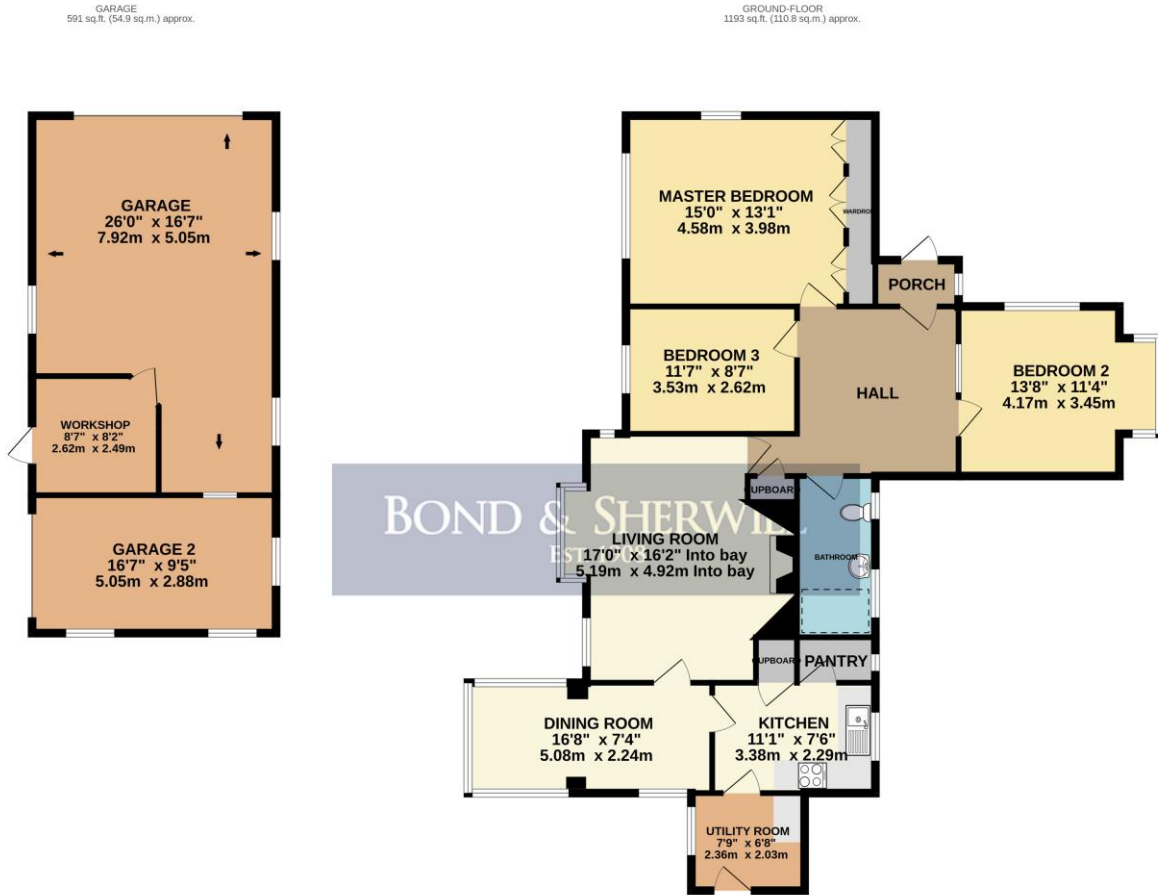

TOTAL FLOOR AREA : 1784 sq.ft. (165.7 sq.m.) approx.
 Whilst every attempt has been made to ensure the accuracy of the floorplan contained here, measurements of doors, windows, rooms and any other items are approximate and no responsibility is taken for any error, omission or mis-statement. This plan is for illustrative purposes only and should be used as such by any prospective purchaser. The services, systems and appliances shown have not been tested and no guarantee as to their operability or efficiency can be given.
 Made with Metropix ©2024

Energy Performance Certificate

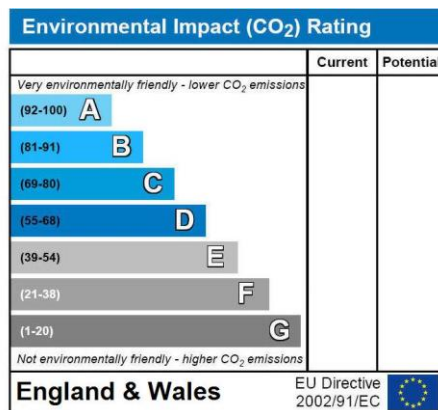
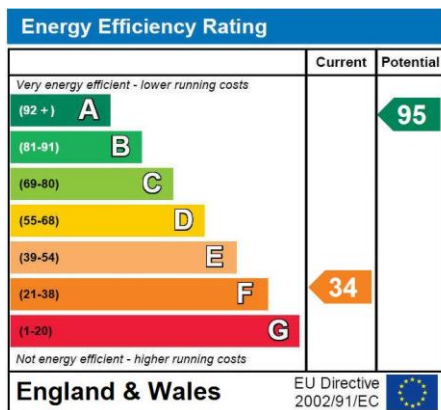

These particulars are intended to give a fair description of the property but their accuracy cannot be guaranteed, and they do not constitute an offer of contract. Intending purchasers must rely on their own inspection of the property. None of the above appliances/services have been tested by ourselves. We recommend purchasers arrange for a qualified person to check all appliances/services before legal commitment.