



Adelaide Crescent, Hove, BN3 2JH
Asking Price £585,000

Adelaide Crescent, Hove, BN3 2JH

Very spacious Regency mansion apartment located on one of Brighton & Hove's premier addresses, affording picturesque views across Adelaide Crescent gardens to the sea.

The Property

The majestic Adelaide Crescent wraps around acres of beautifully kept gardens opposite Hove Lawns and the seafront. To the front of the property, with stunning views over Adelaide Crescent gardens, Hove Lawns and out to sea are the lounge and second bedroom. The lounge is of very generous proportions and offers marble fireplace lots of space for lounge furniture, alongside space for a large table and chairs. The bedroom also has a marble fireplace and a range of built in wardrobes/cupboards. To the rear is the kitchen with wooden work surface and fronted cupboards. The main bedroom also has a marble fireplace and plenty of space for a large bed and furniture. The bathroom is conveniently located next to the main bedroom.

The Location

This property is located on the western side of Adelaide Crescent between Kingsway & Palmeira Square. This amazing location affords easy access to the seafront/Hove Lawns (0.1 miles), Waitrose Supermarket (0.7 miles), The King Alfred Leisure Centre (0.7 miles), Hove Railway Station (1 mile), Churchill Square Shopping Centre (0.9 miles), The Brighton Centre (0.9 miles), The North Laine (1 mile), St Ann's Well Gardens (0.5 miles), The Theatre Royal (1.3 miles), Hove County Cricket Ground (0.4 miles), George Street with its cafes and shops (0.6 miles). There are plenty of transport links in and out of Brighton & Hove.



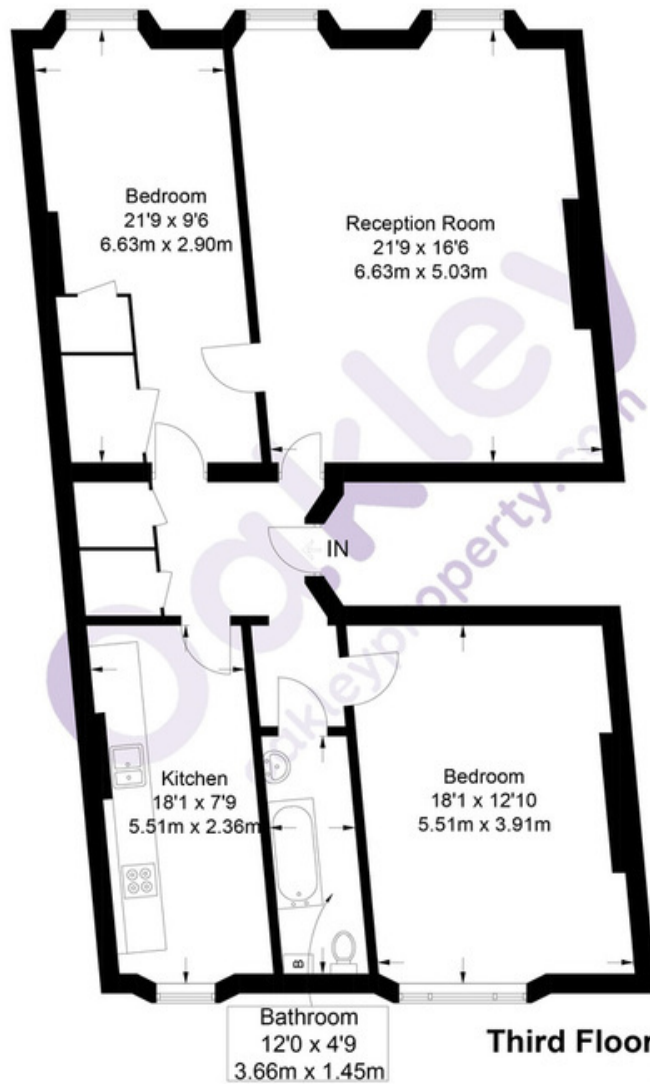

Approximate Gross Internal Area = 1125 sq ft / 104.5 sq m

Illustration for identification purposes only, measurements are approximate, not to scale. © Oakley Property 2022



Energy Performance Certificate

Score	Energy rating	Current	Potential
92+	A		
81-91	B		34 B
69-80	C	76 C	
55-68	D		
39-54	E		
21-38	F		
1-20	G		

Agents Notes

Tenure- Leasehold
145 years remaining on the lease
Service Charge- £170 Per month
Sinking Fund - £145 Per month
Ground Rent- £50 Per annum
Council Tax- D



These details have been produced in good faith and are believed to be accurate based upon the information supplied but they are not intended to form part of a contract. All statements contained in these particulars as to this property are made without responsibility on the part of Oakley, the vendors or lessors and are NOT to be relied on as statements or representations of fact. Any intending purchasers must satisfy themselves by inspection or otherwise as to the correctness of each of the statements contained in these particulars. The vendors, Oakley and any person who work in their employment do not have any authority to make or give any representation or warranty. The floor plan is for illustrative purposes only and the accuracy cannot be relied upon or guaranteed and no responsibility is taken for an error, omission or mis-statement. The total floor area shown has been taken from the EPC.



Oakley

Your Sussex Property Expert

Brighton & Hove Office
01273 688 881
3-6 North Road, Brighton BN1 1YA
www.oakleyproperty.com
brighton@oakleyproperty.com

We also have offices in:
Shoreham by Sea
Lewes Town & Country
The London Office



A new way of marketing property

Get in touch to book a viewing or valuation of your own property

