



**31 Newton Court, Haywards Heath, RH16 3BL**

**£1,495 PCM**



Accommodation

Floor Plan

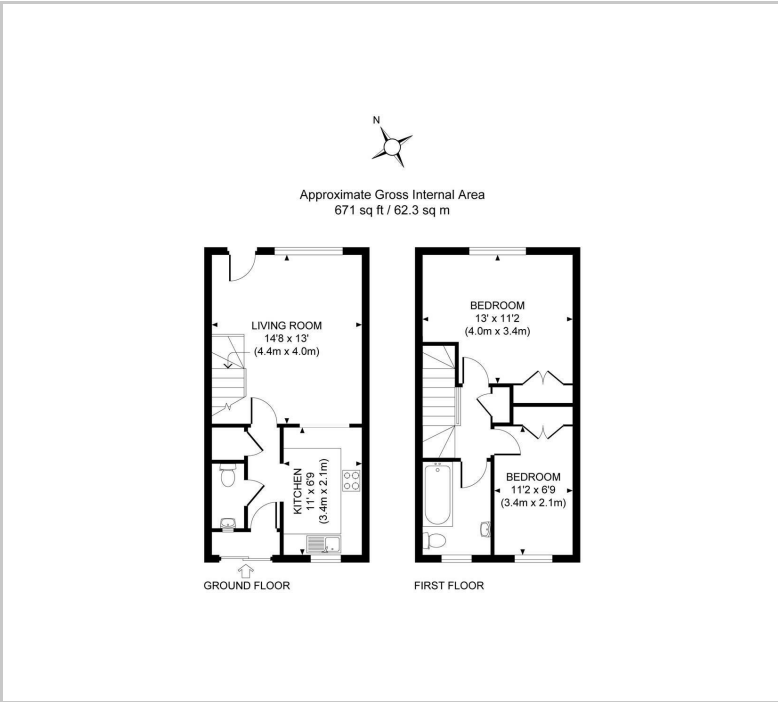

This superb two-bedroom home offers stylish and comfortable living in a prime Haywards Heath location. Recently redecorated throughout in neutral tones, the property is beautifully presented and ready to move into.

The ground floor features a bright and spacious living room, a modern and well-designed kitchen complete with white goods, and the convenience of a ground-floor cloakroom/WC. Upstairs, there are two well-proportioned bedrooms and a contemporary family bathroom with a shower over bath.

Gas-fired central heating and double-glazed windows ensure warmth and energy efficiency, while outside, the low-maintenance garden with a pleasant decked patio provides the perfect space to relax.

Newton Court is ideally situated just a short walk from Haywards Heath mainline station and The Broadway, offering an array of popular restaurants and bars. Please note, residents parking is available on a limited basis with no allocated space.

This fantastic home won't be available for long and an early viewing is highly recommended!



Area Map

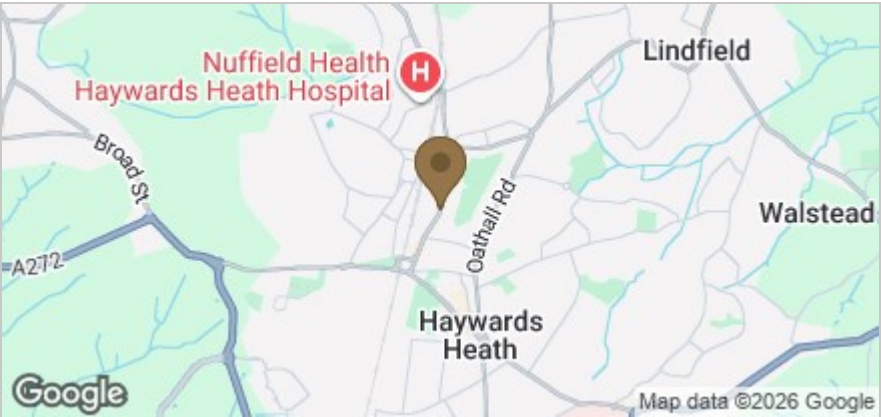

Energy Efficiency Graph

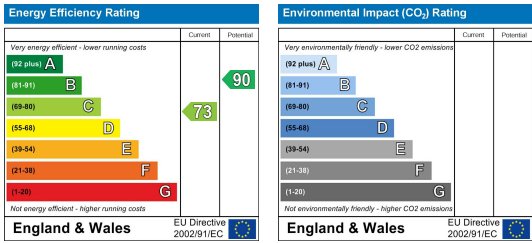

These particulars, whilst believed to be accurate are set out as a general outline only for guidance and do not constitute any part of an offer or contract. Intending purchasers should not rely on them as statements of representation of fact, but must satisfy themselves by inspection or otherwise as to their accuracy. No person in this firm's employment has the authority to make or give any representation or warranty in respect of the property.