



Gibside Court, Highgrove Estate, Gateshead **£190,000**







Gibside Court, Highgrove Estate, Gateshead

£190,000

Property Description

A beautifully presented three bedroom property in a sought after location. Nicely decorated throughout and ready to move into. Benefiting from double glazing and gas fired central heating the property briefly comprises, entrance porch, lounge/diner, kitchen, conservatory and to the first floor there are three bedrooms and the family bathroom/wc. Externally there are gardens to the front and rear and a driveway leading to integral garage provides off street parking. A copy of the EPC will be available on request. EPC Grade D

Our View

A property which will appeal to many due to its location on a quiet cul de sac. It is tastefully decorated throughout and is an ideal family home with spacious living accommodation and three good sized bedrooms, the master benefiting from fitted wardrobes. It has the added benefit of a conservatory to the rear. Book a viewing early to avoid disappointment

Location

Highgrove estate is a sought after area with easy access to a range of amenities in Whickham and Newcastle City centre and the Metro Centre is a short distance away. There are a range of schools for all ages with the Emmanuel college situated in walking distance.



EPC Rating Awaited
For full EPC please contact the branch

Ground Floor
Floor Size: 57.6 m², 620.5 ft²

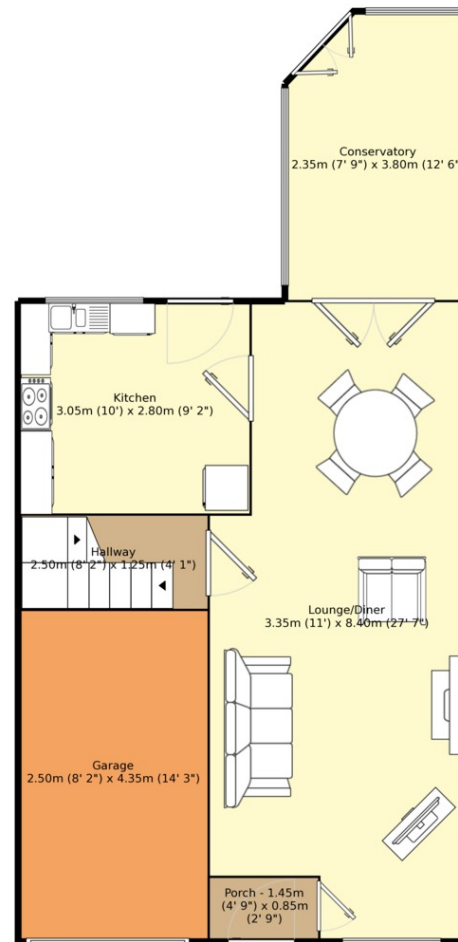

First Floor
Floor Size: 39.9 m², 429.1 ft²

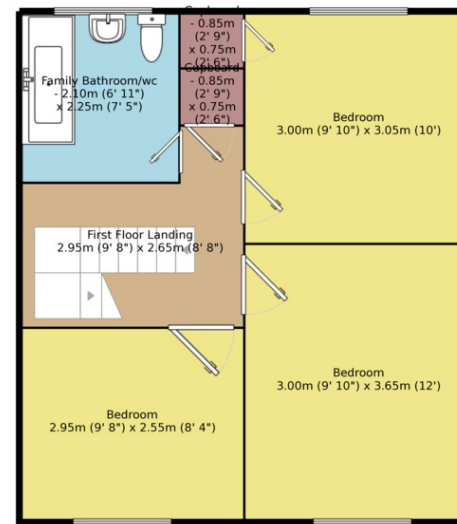

Measurements are approximate. Not to scale. For illustrative purposes only.

IMPORTANT NOTE TO PURCHASERS: We endeavour to make our sales particulars accurate and reliable, however, they do not constitute or form part of an offer or any contract and none is to be relied upon as statements of representation or fact. The services, systems and appliances listed in this specification have not been tested by us and no guarantee as to their operating ability or efficiency is given. All measurements have been taken as guide to prospective buyers only, and are not precise. Floor plans where included are not to scale and accuracy is not guaranteed. If you require clarification or further information on any points, please contact us, especially if you are travelling some distance to view. Fixtures and fittings other than those mentioned are to be agreed with the seller.

Your Move is a trading name of your-move.co.uk, registered in England at Newcastle House, Albany Court, Newcastle Business Park, Newcastle upon Tyne NE4 7YB (number 01864469).

*Calls may be recorded and/or monitored for training and/or security purposes.

Bishop Court Front Street, Whickham, Newcastle
Upon Tyne, NE16 4JQ

0191 488 7968 * whickham@your-move.co.uk

