



Ann Cordey
ESTATE AGENTS

13 Beechside, Staindrop, Darlington, DL2 3PE
Offers In The Region Of £475,000



13 Beechside, Staindrop, Darlington, DL2 3PE

Nestled in the charming village of Staindrop, This three bedroomed detached bungalow provides a peaceful and private setting. The exquisite styling and design offers a luxurious living experience. And as you step into the property, you are greeted by a sense of space and elegance that permeates every corner.

The immaculate presentation and tasteful decor create a warm and inviting atmosphere, the dual-aspect reception room is at the centre of the home, offering ample natural light and a perfect space to relax or entertain guests.

The bespoke kitchen and dining area is a true showstopper, boasting high-end fixtures, innovative design, quality AEG appliances and a fixed dining table with chairs. The various ambient light setting make it ideal for hosting memorable dinner parties or enjoying casual family meals.

There are two very generous double bedrooms, and a well proportioned third bedroom currently used as a dressing room. These are serviced by a stunning shower room, with electronic control Mira shower. The room is completely tiled with Porcelanosa tiles, illuminated inset display shelves, wall hung Villeroy and Boch WC with a Porcelanosa hand basin positioned within a useful vanity storage cabinet. There is also a separate cloaks/wc.

Externally the property sits in immaculately kept gardens to both the front and rear. The front having a lawned area with mature border that provide colour and interest throughout the year. There is a single side gate leading into the very private rear garden, which again has a manicured lawn with paved pathway and patio seating area, which is a perfect place to take in views of the well established garden. The borders are well stocked with an abundance of small trees, shrubs, plants and flowers all against the characterful grade II listed stone wall. The south facing garden is a beautiful and private area in which to enjoy the outdoors. The driveway allows for off street parking and the original garages have been converted into space for the kitchen.

Staindrop is a beautiful Teesdale village with established shops, including a Post Office and small supermarket, and well regarded primary and secondary schools. Regular bus routes service the village, and there is ease of access to Darlington, Durham City, and the market towns of Barnard Castle and Bishop Auckland via road links. The village also enjoys the benefits of living in close proximity to the Raby Castle Estate and visitor attraction. The local town of Barnard Castle with its independent shops, riverside walks and the renowned Bowes Museum is just 5 miles distant.

The property is warmed by gas central heating and is fully double glazed and is a home that would suit a host of buyers. Viewing is highly recommended.

TENURE: FREEHOLD

COUNCIL TAX: D

RECEPTION HALLWAY

The striking composite entrance door opens into a welcoming reception hallway which has an attractive and practical oak engineered wood floor. The hallway leads to the lounge, and all three bedrooms, shower room/wc and utility room. There is also access to a handy cloaks/wc.

CLOAKS/WC

Fitted with a modern suite with low level wc and handbasin positioned within a grey gloss vanity unit.

LOUNGE

24'6" x 12'9" (7.48 x 3.91)

The dual aspect reception room is of a generous size yet promotes a cosy feeling. Immaculately decorated with cornice to the ceiling and two designer radiators. Enjoying views of the garden to the rear and to the front aspect. The engineered wood floor has been continued through from the hallway and there is access from this lounge to the kitchen & dining area.

KITCHEN & DINING AREA

17'11" x 17'5" (5.48 x 5.31)

Breathtaking design and meticulous planning has brought this showstopping room to life. Extending the accommodation into the original garage area has allowed for a spacious open plan kitchen and dining area. The bespoke high-end cabinets are complimented by the quality silestone worksurfaces with undermount sink with Franke swan neck tap.

The integrated appliances are all by AEG and include two double electric ovens, dual induction hob with a gas burning ring, a microwave, dishwasher and fridge freezer. The well planned kitchen is all soft closing with large pull our larder cabinet and plate warmer. The matching table is fixed and pivoted to allow for repositioned with handy storage to its base. A further large walk in storage cupboard to this room houses the central heating boiler.

The room has two windows overlooking the rear garden with a door leading out and has a range of variable ambient light settings to the ceiling, cupboards and plinths. Put simply, a beautiful place to cook, eat and entertain.

UTILITY ROOM

9'7" x 6'3" (2.94 x 1.91)

A handy addition to the home, with two rows of cabinets for storage and textured sink with wood effect work surfaces and a window to the rear.

REAR PORCH

Fitted with a floor cabinet, work surface and plumbing for an automatic washing machine. There is a door leading out to the garden.



BEDROOM ONE

13'8" x 12'11" (4.19 x 3.94)

The principal bedroom of the home is a well proportioned double bedroom over looking the front aspect.

BEDROOM TWO

13'8" x 11'1" (4.19 x 3.40)

A further double bedroom, enjoying pleasant views through sliding patio doors of the rear garden.

BEDROOM THREE

9'8" x 8'8" (2.95 x 2.65)

A useful bedroom to the front aspect and having a built in storage cupboard.

SHOWER ROOM/WC

The stunning shower room has been designed with both function and style. Having a large walk-in shower cubicle with an electronic Mira shower. The hand basin is positioned within a useful vanity storage unit. There are illuminated display recesses to the fully tiled walls and soft ambient lighting.

EXTERNALLY

Externally the property sits in immaculately kept gardens to both the front and rear. The front having a lawned area with mature borders that provide colour and interest throughout the year. The paved driveway allows for off street parking for two vehicles.

There is a single side gate leading into the very private rear garden, which again has a manicured lawn with paved pathway and patio seating area, which is a perfect place to take in views of the well established garden. The borders are well stocked with an abundance of small trees, shrubs, plants and flowers all against the characterful grade II listed stone wall. The south facing garden attracting a great deal of the summer sunshine is a beautiful and private area in which to enjoy the outdoors with an arbour and greenhouse.



GROUND FLOOR

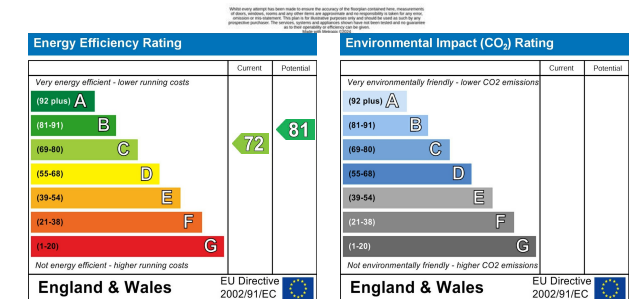
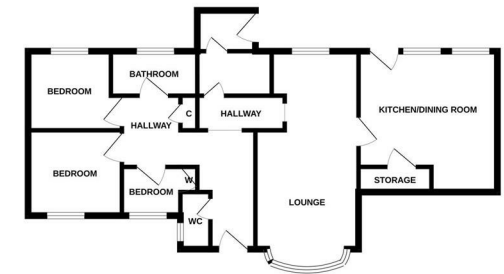

YOUR HOME IS AT RISK IF YOU DO NOT KEEP UP REPAYMENTS ON A MORTGAGE OR OTHER LOANS SECURED ON IT.

These particulars do not constitute, nor constitute part of, an offer or contract. An intending purchaser must satisfy himself by inspection or otherwise as to the correctness of each of the statements contained in these particulars. The vendor does not make or give, and neither Ann Cordey, or any other person in their employment has any authority to make or give any representation or warranty whatever in relation to this property. All measurements are approximate.



13 Duke Street, Darlington, County Durham, DL3 7RX
Tel: 01325 488433
Email: sales@anncordey.com
www.anncordey.com



