



32 Kirkfield View, Livingston Village

Offers Over £235,000



32 Kirkfield View

Livingston Village, Livingston

Corner Plot Three-bedroom Detached Bungalow with delightful conservatory. Bedroom Three formed by conversion of Garage and currently used as a home office. Beautiful secluded and tranquil rear garden for peaceful living. Monobloc Driveway. Council Tax band: TBD

Tenure: Freehold

- Three Bedroom Detached Bungalow set within enviable corner plot location
- Fully enclosed rear garden which enjoys tree-lined privacy
- Monobloc Driveway Parking
- Spacious Conservatory
- Bedroom Three created by conversion of existing garage
- Peaceful secluded location
- Traditional style Bathroom with cast-iron slipper bath
- Kitchen fitted with range of base and wall cabinetry



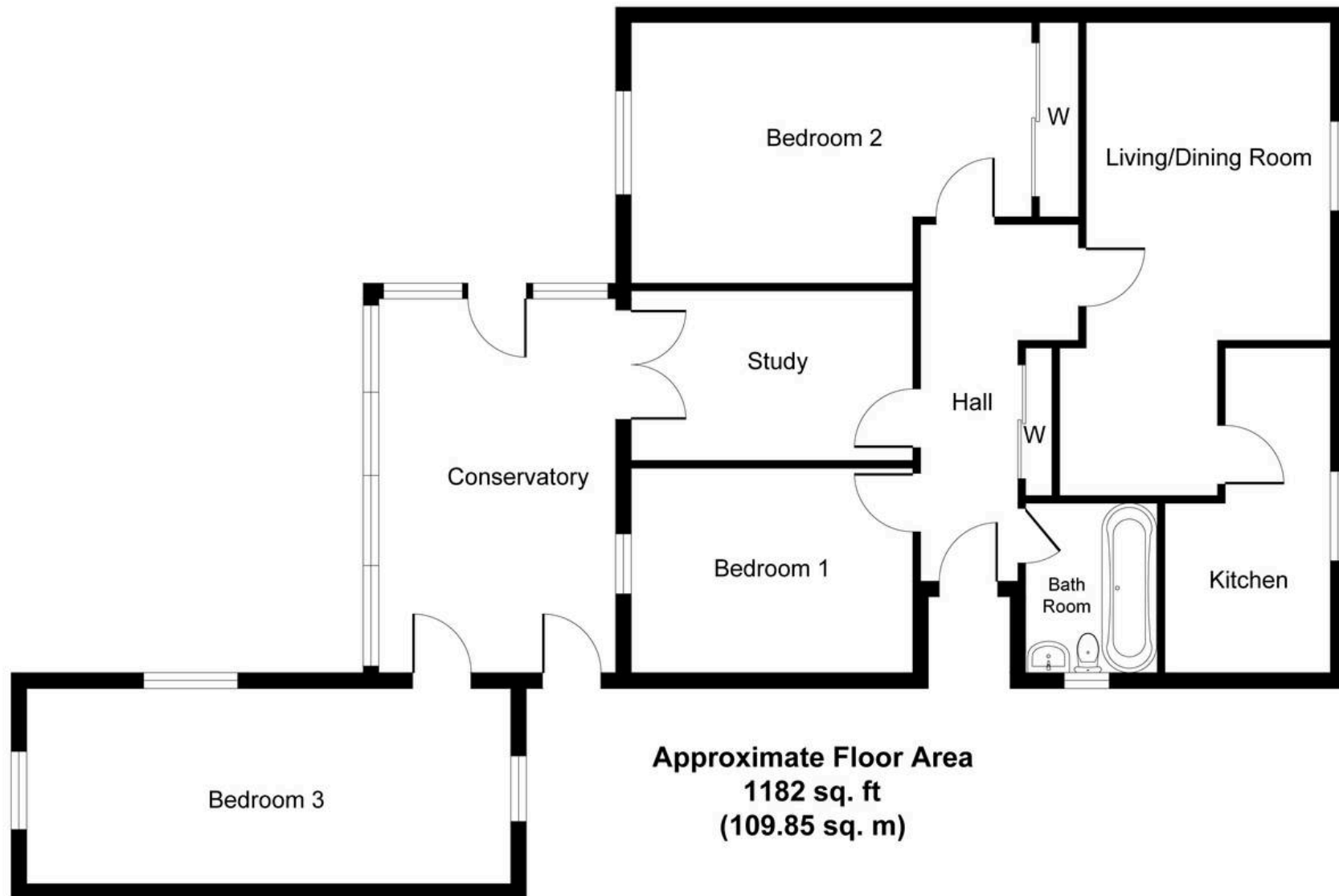

Whilst every attempt has been made to ensure the accuracy of the floor plan contained here, measurements of doors, windows, rooms and any other items are approximate and no responsibility is taken for any error, omission, or mis-statement. The measurements should not be relied upon for valuation, transaction and/or funding purposes. This plan is for illustrative purposes only and should be used as such by any prospective purchaser or tenant.

The services, systems and appliances shown have not been tested and no guarantee as to their operability or efficiency can be given.

Copyright V360 Ltd 2025 | www.houseviz.com



KnightBain Estate Agents

Knightbain, 4 Greendykes Road, Broxburn - EH52 5AG

01506 852000

info@knightbain.co.uk

www.knightbain.co.uk/

