



91 Croft Park Crescent, Whitburn

Offers Over £218,000



91 Croft Park Crescent

Whitburn, Bathgate

Stunning 3-bed semi-detached house in desirable area. Built in 2021 by Taylor Wimpey, this "Baxter" home offers modern design, integrated appliances, 3 bedrooms, family bathroom, luxury touches, W/C, and ideal commute location. Perfect blend of style and functionality.

Council Tax band: D

Tenure: Freehold

- Stunning 3 Bed Semi Detached House
- Built In 2021
- A "Baxter" Home by Taylor Wimpy
- Fully Landscaped Rear Garden
- Impeccable Design Throughout
- Modern Kitchen With Integrated Appliances
- Downstairs W/C
- Beautiful Family Home
- Ideally Located For Commuting to Edinburgh & Glasgow
- Close To Local Amenities



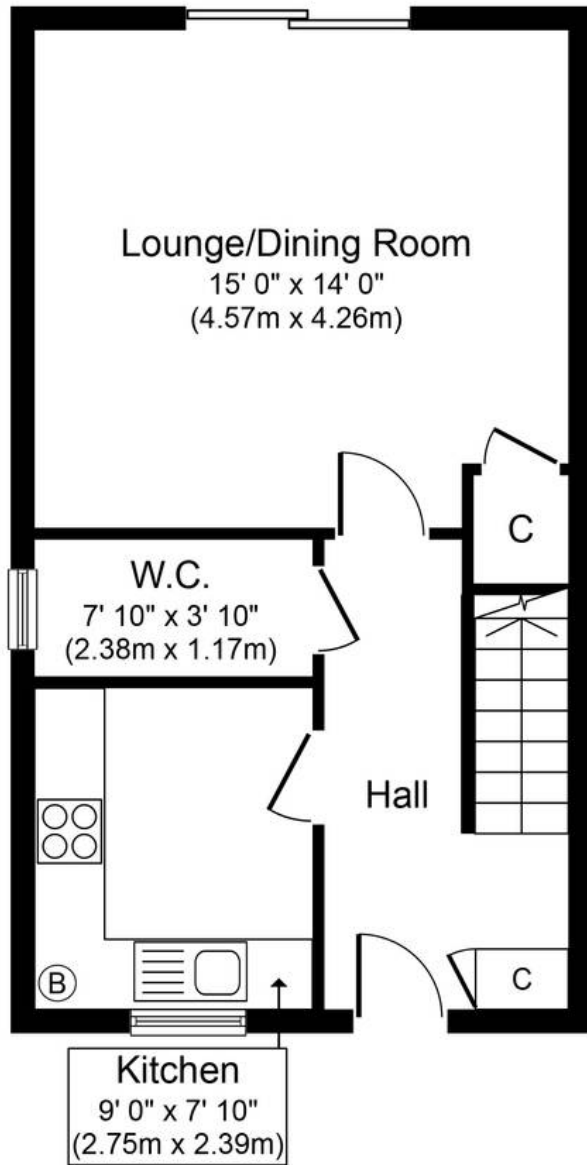

Ground Floor
Approximate Floor Area
412 sq. ft.
(38.3 sq. m.)

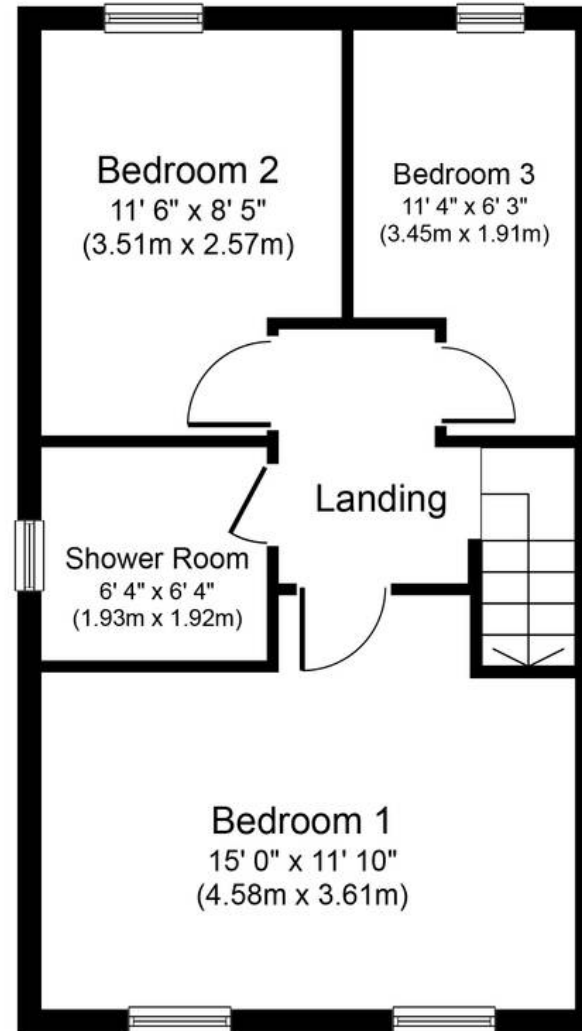

First Floor
Approximate Floor Area
412 sq. ft.
(38.3 sq. m.)

Whilst every attempt has been made to ensure the accuracy of the floor plan contained here, measurements of doors, windows, rooms and any other items are approximate and no responsibility is taken for any error, omission, or mis-statement. The measurements should not be relied upon for valuation, transaction and/or funding purposes. This plan is for illustrative purposes only and should be used as such by any prospective purchaser or tenant. The services, systems and appliances shown have not been tested and no guarantee as to their operability or efficiency can be given.



KnightBain Estate Agents

Knightbain, 4 Greendykes Road, Broxburn - EH52 5AG

01506 852000

info@knightbain.co.uk

www.knightbain.co.uk/

