



64 Almondell Road, Broxburn

Offers Over £143,000



64 Almondell Road

Broxburn

Charming two bedroom house with modern kitchen, ample storage, and freshly decorated throughout. Private front and fully enclosed south facing rear garden as well as off street parking. Convenient location with no onward chain. Ideal for first-time buyers or investors.

Council Tax band: B

Tenure: Freehold

- Modern Kitchen With Space For Dining
- Front And Rear South Facing Garden
- Ideal Starter Home
- No Onward Chain
- Property suited to Buy to Let Investors
- Move In Condition
- Excellent Location Close To Amenities
- Abundance Of Storage Throughout
- Gas Central Heating
- Freshly Decorated Throughout



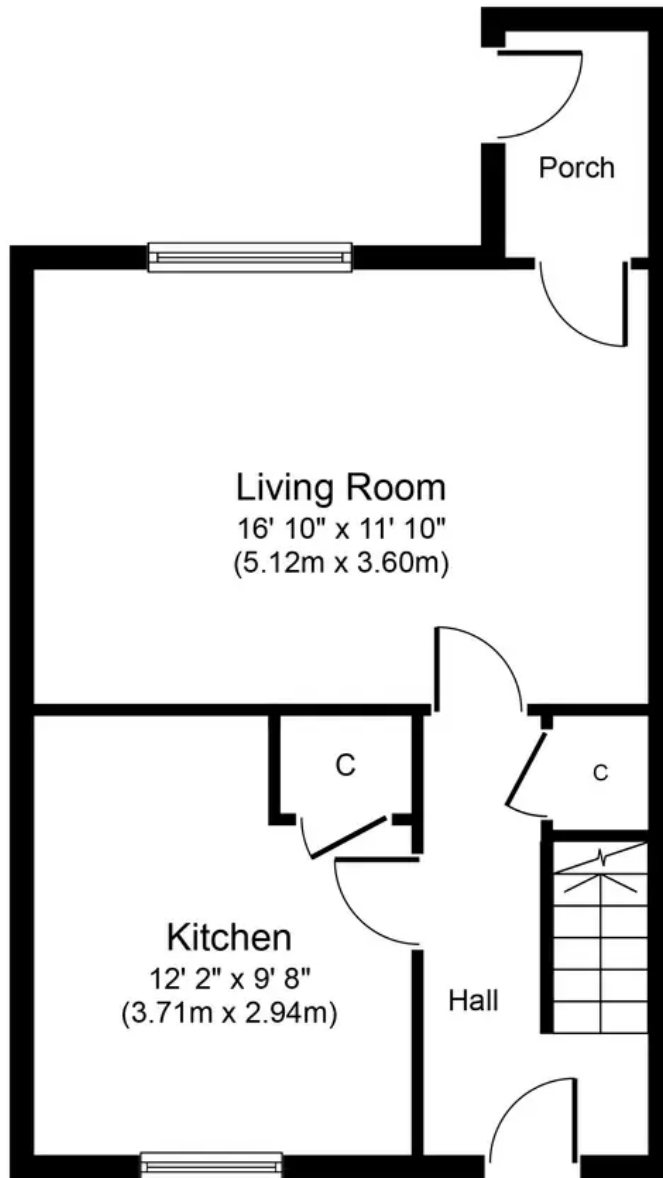

Ground Floor
Approximate Floor Area
439 sq. ft.
(40.8 sq. m.)

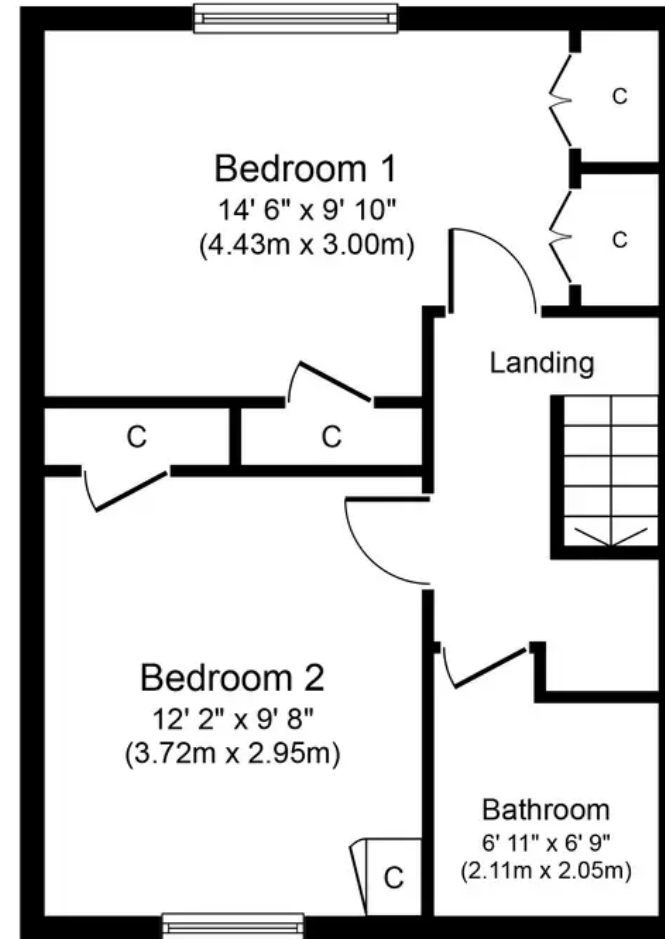

First Floor
Approximate Floor Area
413 sq. ft.
(38.4 sq. m.)

Whilst every attempt has been made to ensure the accuracy of the floor plan contained here, measurements of doors, windows, rooms and any other items are approximate and no responsibility is taken for any error, omission, or mis-statement. The measurements should not be relied upon for valuation, transaction and/or funding purposes. This plan is for illustrative purposes only and should be used as such by any prospective purchaser or tenant. The services, systems and appliances shown have not been tested and no guarantee as to their operability or efficiency can be given.



KnightBain Estate Agents

Knightbain, 4 Greendykes Road, Broxburn - EH52 5AG

01506 852000

info@knightbain.co.uk

www.knightbain.co.uk/

