



Northfield Crescent, Bingley, West Yorkshire **£140,000**







Northfield Crescent, Bingley, West Yorkshire

£140,000

Property Description

Your Move are pleased to present this two bedroom semi-detached property to market. This property is located in the popular location of Cottingley. Starting from the ground floor the property comprises of a large living room with french doors leading to the garden and the kitchen. To the first floor we have two double bedrooms which also offers additional storage space and the bathroom. Externally the property has a driveway used for parking and to the rear of the property we have a large garden with huge potential. The property also offers a storage outbuilding and utility room attached to the side of the property. EPC RATING - D

Our View

This is a fantastic opportunity to purchase this two bedroom semi-detached property with ample space throughout. This property is open to first time buyers, investors and even people looking to downsize who are wanting a large garden. Early viewing is highly recommended to avoid disappointment

Location

Cottingley is a suburban village within West Yorkshire, situated between Shipley and Bingley, offering local shops, schooling and public houses. It is perhaps best known for the Cottingley Fairies, which appeared in a series of photographs taken there during the early 20th century.



Two Bedroom
For full EPC please contact the branch

Ground Floor
Floor Size: 33.3 m², 358.7 ft²

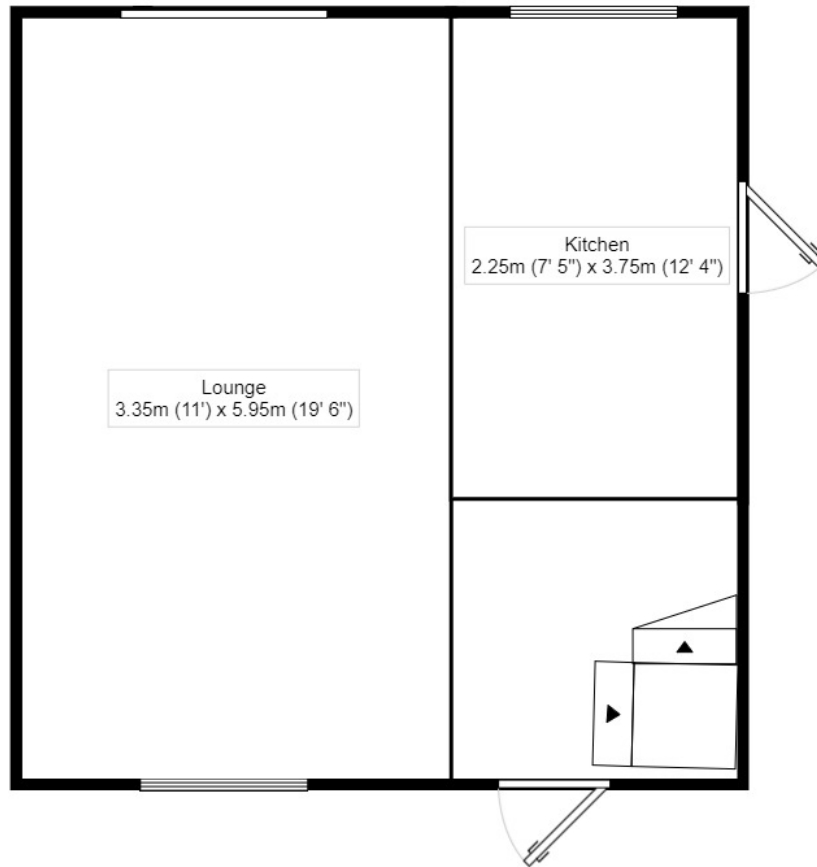

First Floor
Floor Size: 33.6 m², 361.7 ft²

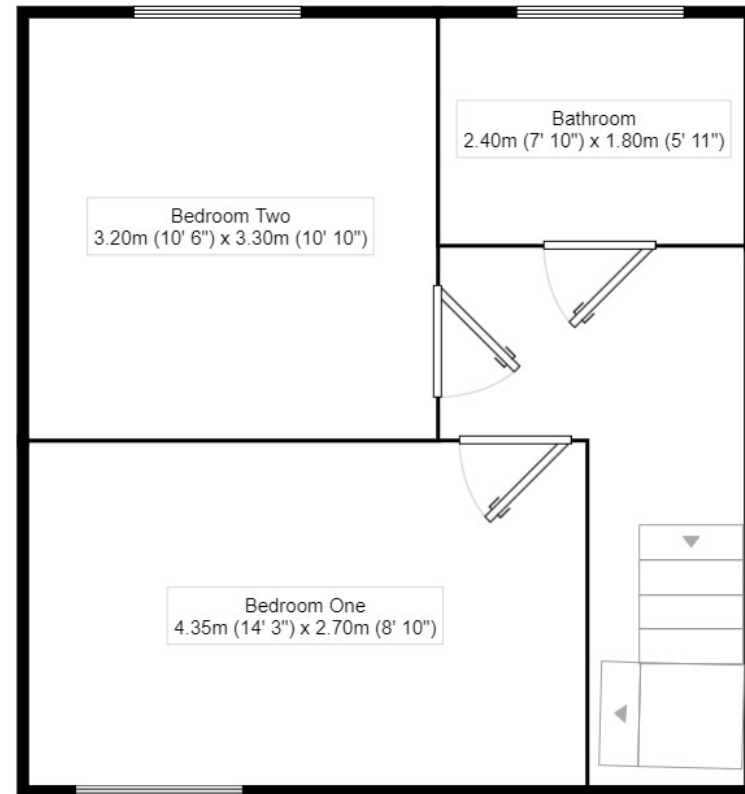

Measurements are approximate. Not to scale. For illustrative purposes only.

IMPORTANT NOTE TO PURCHASERS: We endeavour to make our sales particulars accurate and reliable, however, they do not constitute or form part of an offer or any contract and none is to be relied upon as statements of representation or fact. The services, systems and appliances listed in this specification have not been tested by us and no guarantee as to their operating ability or efficiency is given. All measurements have been taken as guide to prospective buyers only, and are not precise. Floor plans where included are not to scale and accuracy is not guaranteed. If you require clarification or further information on any points, please contact us, especially if you are travelling some distance to view. Fixtures and fittings other than those mentioned are to be agreed with the seller.

The Your Move branch is operated by National Home Move Limited which is independently owned and operated under a licence from your-move.co.uk Limited. National Home Move Limited is registered in England and Wales with company number 11805074, registered office: 5 Brooklands Place, Brookland Road, Sale, United Kingdom, M33 3SD. VAT Reg No: 315255523.

*Calls may be recorded and/or monitored for training and/or security purposes.

6 North Street, Keighley, West Yorkshire, BD21
3SE

01535 605733 * Keighley@your-move.co.uk

