

OVER
30
YEARS OF
MOVING
PEOPLE

**ATWELL
MARTIN**
ESTATE AGENTS



Boydell Close, Swindon SN5 5QT

Offers over £210,000

****NO ONWARD CHAIN**** Atwell Martin are pleased to offer this TWO Bedroom, End Of Terrace House for sale, tucked away on a quiet cul-de-sac in the popular area of SHAW, Swindon.



The Location

Boydell Close is located in Shaw to the West of Swindon and not far from Lydiard Millicent and Lydiard Country Park.

The property is situated within a short walk of excellent schools and Shaw Village Centre which has great local amenities including shop, chemist, dentist, vets, Doctors surgery and public house/restaurant.

The larger West Swindon/Asda shopping centre is only a short distance away as is the Shaw Ridge Leisure Complex both of which offer an array of shops, a supermarket, cinema complex and a number of pubs / restaurants. The M4 J16 is a two minute drive which provides access to the East and West and the Town Centre with mainline Rail Station is only a ten minute drive.

The Property

An end of terrace two bedroom home in the popular Shaw area to the West of Swindon.

The accommodation comprises; Entrance hall, living room, newly fitted kitchen diner. The first floor offers a large main bedroom, a good sized second bedroom and fitted bathroom.

Outside

Gravel driveway parking area to front and further allocated parking space. Low maintenance rear garden, with gated access, timber shed.



▼ Ground Floor

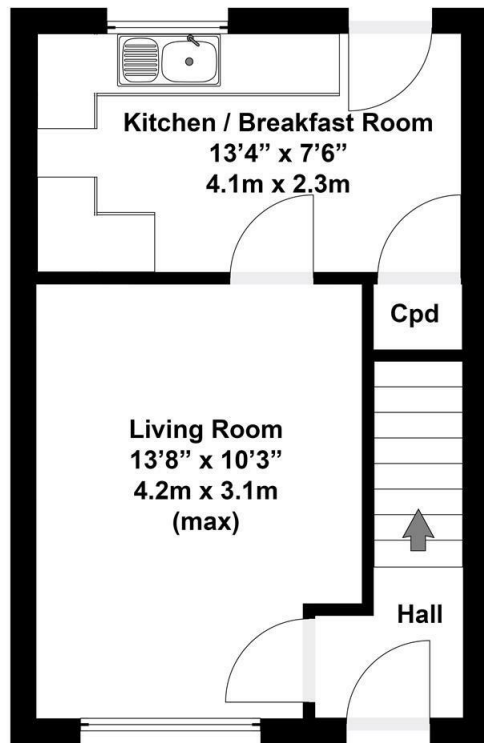

▼ 1st Floor

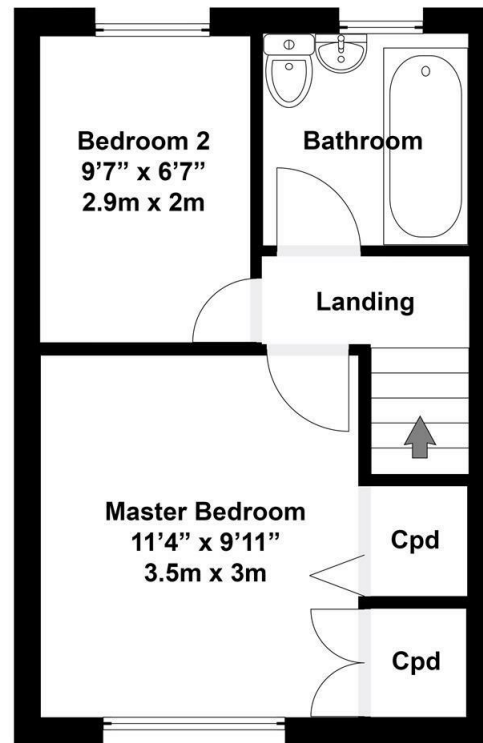

N.B. Whilst care has been taken with this floor plan to reflect an accurate likeness of the property it should only be used as an approximation for illustrative purposes only, specifically no guarantee is given and all should not be relied on solely as a basis of valuation. Plan not to scale.

Total area approx: 545 sq ft / 51 sq m

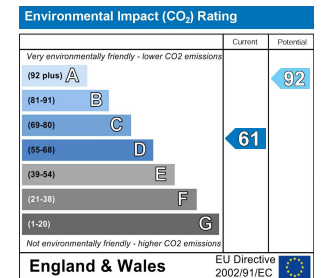
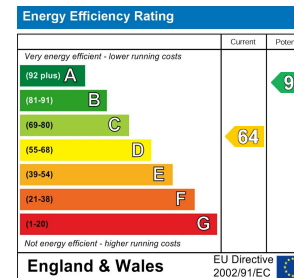

Email: res.calne@atwellmartin.co.uk

Tel: 01249 813813

The particulars are set out as a general outline only for the guidance of intended purchasers or lessees, and do not constitute, any part of a contract. Nothing in these particulars shall be deemed to be a statement that the property is in good structural condition or otherwise nor that any of the services, appliances, equipment or facilities are in good working order. Purchasers should satisfy themselves of this prior to purchasing.

