

7 Helyar Close | Glastonbury | BA6 9LQ

FREEHOLD

£245,000

PROPERTY SUMMARY



Offering spacious accommodation throughout this three bedroom mid terrace property has come to the market, conveniently positioned within a level and short walk of the historic town centre. The property comprises: entrance hall, downstairs shower room, kitchen/diner, living room with wood burner, sunroom, three bedrooms and a bathroom. Outside, there is front and rear garden. A early viewing is highly recommended. This property is being offered with no onward chain.

Entrance Hall

Doors leading to shower room and kitchen.

Kitchen/Diner

17'6x9'3 (5.33mx2.82m)

A range of wall, drawer and base units with laminate work surface over. Stainless steel sink with drainer and mixer tap over. Integrated electric oven and gas hob. Space and plumbing for a washing machine. Large under stairs storage cupboard with houses the fridge/freezer. UPVC double glazed windows front. Radiator. Through way into living room.

Shower Room

Walk in shower cubicle, mains power shower. Heated towel rail. WC. Pedestal wash hand basin. Tiled floor. UPVC obscure double glazed window to side.

Living Room

17'7x11'6 (5.36mx35.36m)

Radiator. Wood burning stove. Double glazed sliding doors to sunroom.

Sunroom

14'7x5'8 (4.45mx1.73m)

Radiator. Window to rear. Sliding doors leading on to rear garden.

Landing

Doors leading to bedroom one, two, three and family bathroom. Storage cupboard.

Bedroom One

11'7x10'5 (3.53mx3.18m)

Radiator. Built in wardrobes. UPVC double glazed window to rear.



Mid Terrace Property

Kitchen/Diner

Living Room

Sunroom

Downstairs Shower Room

Three Bedrooms

Bathroom

Front And Rear Gardens

Gas Central Heating



INTERESTED IN THIS
PROPERTY
Need to sell first?

Please call us on
01458 888 020

to arrange

A FREE

MARKET APPRAISAL

MORTGAGE ADVICE

Would you like to have advice
from a fully qualified Mortgage
Consultant with access to the
mortgage market?

**Tor Finance will assess your
needs and recommend the
most suitable mortgage
product available to you.**

Please call us on
01458 888 020 ext 3
to arrange
**A FREE INITIAL
CONSULTATION**

Your property may be repossessed if
you do not keep up repayments on
your mortgage



Bedroom Two

9'4x10'6 (2.84mx3.20m)

Radiator. Built in wardrobe. UPVC double glazed window to front.

Bedroom Three

8'6x6'9 (2.59mx2.06m)

Radiator. UPVC double glazed window to rear.

Bathroom

Three piece suite, low level WC, pedestal wash hand basin and panelled bath with shower over. Tiling wall to floor. Glass shower screen. Heated towel rail. UPVC double glazed obscure window to front.

Rear Garden

Laid to lawn, borders with various plants, shrubs and bushes enclosed with wooden fencing. Shed. Gate providing rear access.

Front Garden

Pathway leading to front door. Various, plants, trees and bushes.

Disclaimer

Important Notice: Tor Estates, its clients and any joint agents give notice that 1: They are not authorised to make or give any representations or warranties in relation to the property either here or elsewhere, either on their own behalf or on behalf of their client or otherwise. They assume no responsibility for any statement that may be made in these particulars. These particulars do not form part of any offer or contract and must not be relied upon as statements or representations of fact. 2: Any areas, measurements or distances are approximate. The text, photographs and plans are for guidance only and are not necessarily comprehensive. It should not be assumed that the property has all necessary planning, building regulation or other consents and Tor Estates have not tested any services, equipment or facilities. Purchasers must satisfy themselves by inspection or otherwise.

GROUND FLOOR 121.7 sq. m.
(1310 sq. ft.)

1ST FLOOR 95.8 sq. m.
(1031 sq. ft.)

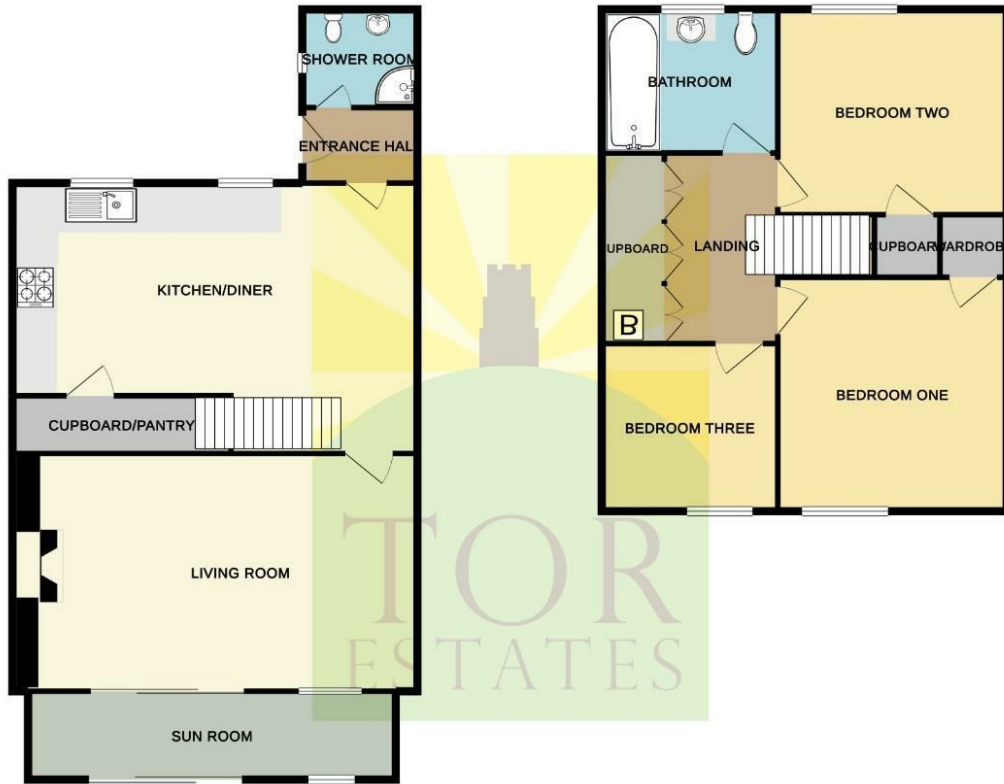

TOTAL FLOOR AREA: 217.5 sq. m. (2341 sq. ft.) approx.
While every attempt has been made to ensure the accuracy of the floorplan, contained items, measurements of doors, windows, rooms and any other items are approximate and no responsibility is taken for any error, omission or mis-statement. This plan is for illustrative purposes only and should be used as such by any prospective purchaser. The fixtures, systems and appliances shown have not been tested and no guarantee as to their operability or efficiency can be given.
Made with Metropix ©2019

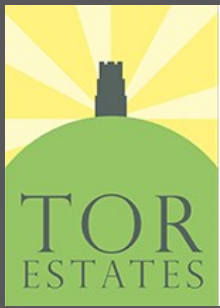
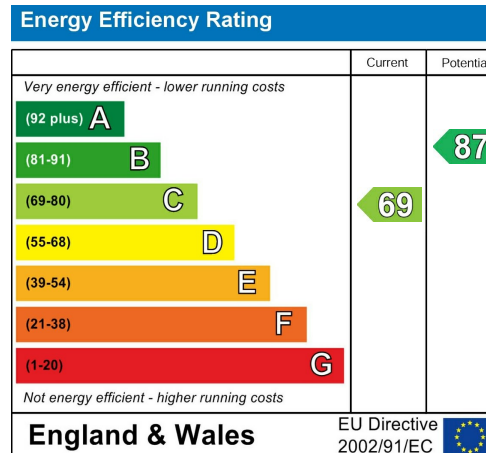

LETTINGS

Call us today for more information

- Vacant Management
- Tenant Find
- Full Management
- Refurbishment Management
- Block Management
- Commercial Lets

01458 888020

20 High Street
Glastonbury
BA6 9DU

73 High Street
Street
BA16 0EG

www.torestates.co.uk

info@torestates.co.uk
lettings@torestates.co.uk
mortgages@torestates.co.uk

