



Ruxley Court, Swanley Close, Eastbourne, East Sussex **Guide £110,000**







Ruxley Court, Swanley Close, Eastbourne, East Sussex

Guide £110,000

Property Description

Guide Price £110,000 to £120,000. Your Move Eastbourne are delighted to market this CHAIN FREE one bedroom ground floor flat in a popular retirement development. The property is available to those of retirement age only. The accommodation comprises hallway, lounge, kitchen, bedroom with wardrobe and bathroom. There is additional storage in the hallway and an outside cupboard. The flat is available with no on going chain. Internal viewing recommended. EPC grade C. A copy of the full EPC will be available on request from the branch office.

Our View

If you're looking to retire in style, you've found your new home.

Location

Ruxley Court is a popular retirement development of flats situated close to the Langney Shopping Centre and main Bus Routes. Langney is a popular modern residential area situated approximately 3.5miles from Eastbourne Town Centre. Langney benefits from its own shopping centre containing a range of stores. Langney also offers good connection to local bus routes serving the Eastbourne Town Centre, surrounding area and Hampden Park with its mainline railway station. Langney is situated approximately 1.5miles from Eastbourne Seafront and beaches.



Retirement Flat
For full EPC please contact the branch

Ground Floor
Floor Size: 44.6 m², 479.8 ft²

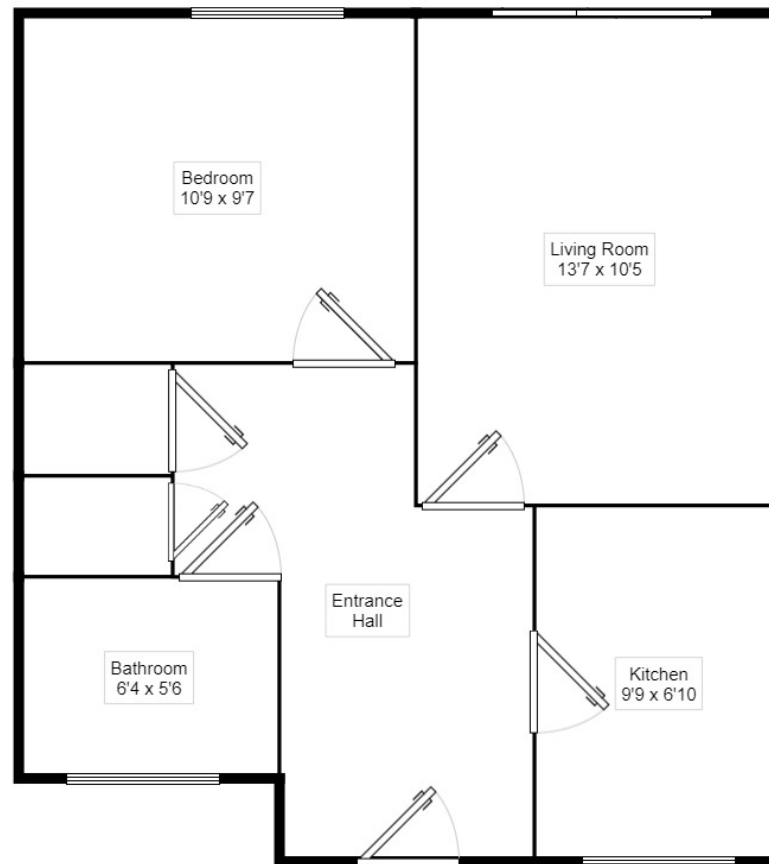

Measurements are approximate. Not to scale. For illustrative purposes only.

IMPORTANT NOTE TO PURCHASERS: We endeavour to make our sales particulars accurate and reliable, however, they do not constitute or form part of an offer or any contract and none is to be relied upon as statements of representation or fact. The services, systems and appliances listed in this specification have not been tested by us and no guarantee as to their operating ability or efficiency is given. All measurements have been taken as guide to prospective buyers only, and are not precise. Floor plans where included are not to scale and accuracy is not guaranteed. If you require clarification or further information on any points, please contact us, especially if you are travelling some distance to view. Fixtures and fittings other than those mentioned are to be agreed with the seller.

The Your Move branch is operated by National Home Move Limited which is independently owned and operated under a licence from your-move.co.uk Limited. National Home Move Limited is registered in England and Wales with company number 11805074, registered office: 5 Brooklands Place, Brookland Road, Sale, United Kingdom, M33 3SD. VAT Reg No: 315255523.

*Calls may be recorded and/or monitored for training and/or security purposes.

40 Beatty Road, Eastbourne, East Sussex, BN23
6DG

01323 727778 * eastbourne@your-move.co.uk

