



£1,350 Per Calendar Month
22 Marine Close, West Wittering, Chichester, West Sussex PO20 8HG





1



2



2



C



A

Entrance Hall

Cloakroom/shower

With access from either Bedroom Two or the Hall. Half tiled with fully tiled double glass, shower cubicle. Semi-recessed wash basin with cupboards below. Low level WC with recessed cistern, chrome towel rail/radiator, shaver point.

Lounge/Dining Room/Kitchen

Beech laminate flooring, with cream coloured cupboard units with granite work surfaces with inset sink. Built-in electric oven with ceramic hob and cooker hood over. Integrated fridge/freezer, automatic washing machine and dishwasher. Wall mounted 'Worcester' gas fired central heating boiler, radiator.

Bedroom 2

Full height double glazed doors to rear garden. Radiator. Door into cloak/shower room.

Bedroom 1

A spacious room with dressing area, two radiator, access to eaves storage space.

Bathroom

Part tiled, panelled bath with centre positioned mixer taps with shower attachment, semi-recessed hand basin with cupboard under, low level WC, chrome towel rail/radiator.

Outside & General

Pretty front garden with small lawn and specimen shrub border. Pedestrian access to a small rear garden laid with a paved area which can be accessed from Bedroom two. b>ONE ALLOCATED CAR SPACE. b/>





**Flat 3, The Mariners, 22 Marine Close,
West Wittering, Chichester, PO20 8HG**

APPROX. GROSS INTERNAL FLOOR AREA 735 SQ FT 68.2 SQ METRES (EXCLUDES RESTRICTED HEAD HEIGHT)

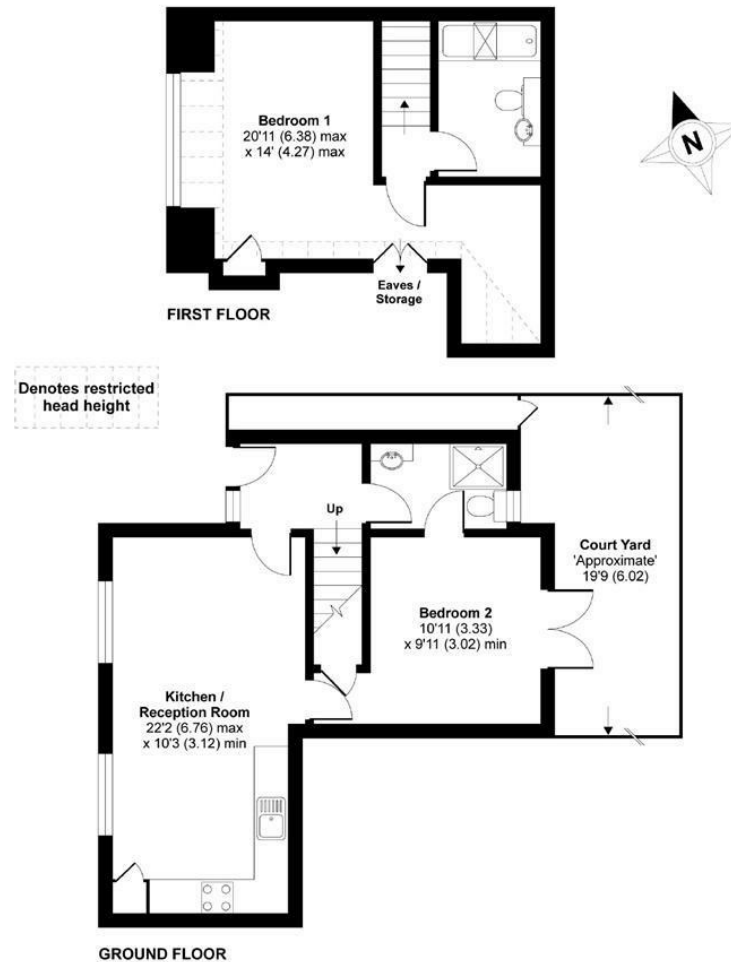

Whilst every attempt has been made to ensure the accuracy of the floor plan contained here, measurements of doors, windows and rooms are approximate and no responsibility is taken for any error, omission or misstatement. These plans are for representation purposes only as defined by RICS Code of Measuring Practice and should be used as such by any prospective purchaser. Specifically no guarantee is given on the total square footage of the property if quoted on this plan. Any figure given is for initial guidance only and should not be relied on as a basis of valuation.

Copyright nichecom.co.uk 2016 Produced for Baileys REF : 77034

Working in co-operation with the owners we have tried to be accurate and informative in the presentation of our property details. Baileys would advise that no representations or warranties are made or given in respect of the condition of any items mentioned in the Sales Particulars. If however, you are not sure about a particular point please contact us to verify the information. This is especially important if viewing the property involves travelling some distance.