



21 Greencroft Avenue, Ruislip

Ruislip

£700,000



LAWRENCE RAND

21 Greencroft Avenue

Ruislip, Ruislip

An extended four-bedroom, two-bathroom semi-detached bungalow is situated in a quiet residential road close to the area's array of amenities and transport links and is within the catchment area of several highly regarded schools including Newnham Nursery, Infant and Junior schools. No onward chain. Council Tax band: F

Tenure: Freehold

EPC Energy Efficiency Rating: D

EPC Environmental Impact Rating: D

- Semi-detached bungalow
- Four bedrooms
- Master en-suite
- Two Bathrooms & guest WC
- Utility room
- Quiet residential road
- Convenient location
- Great transport links







Greencroft Avenue, Ruislip, Middlesex, HA4

Approximate Area = 1517 sq ft / 140.9 sq m

Outbuilding = 320 sq ft / 29.7 sq m

Total = 1837 sq ft / 170.6 sq m

For identification only - Not to scale

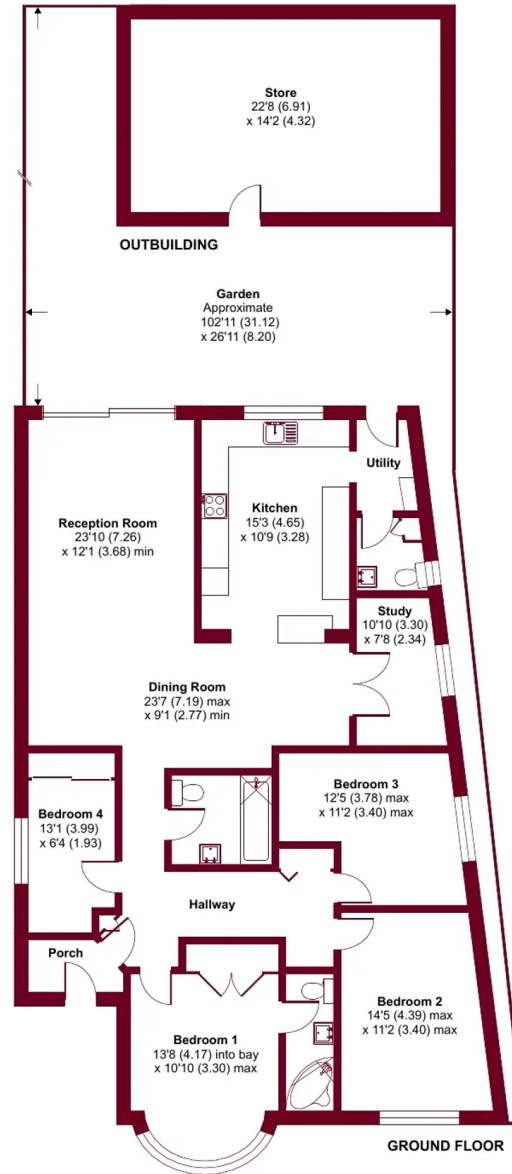

Floor plan produced in accordance with RICS Property Measurement Standards incorporating International Property Measurement Standards (IPMS2 Residential). © nlcheom 2022. Produced for Lawrence Rand. REF: 931518



Lawrence Rand

Lawrence Rand, 106 Victoria Road - HA4 0AL

01895 632211

Info@lawrence-rand.co.uk

www.lawrence-rand.co.uk/



LAWRENCE RAND