



4 St. Lawrence Drive, Pinner

Pinner

£920,000



LAWRENCE RAND

4 St. Lawrence Drive

Pinner, Pinner

Situated in this most sought after location within the Eastcote Park Estate, this rarely available three bedroom detached family home. With benefits including garage own drive, beautiful private rear garden, potential to extend (stpp) and no upper chain.

Council Tax band: F

Tenure: Freehold

EPC Energy Efficiency Rating: E

EPC Environmental Impact Rating: E

- Detached house
- NO UPPER CHAIN
- Three bedrooms
- Potential to extend (stpp)
- Highly regarded schooling
- Large secluded garden
- Close to Eastcote amenities
- Generous off street parking
- Great transport links
- Spacious rooms







St. Lawrence Drive, Pinner, Middlesex, HA5

Approximate Area = 1132 sq ft / 105.1 sq m (includes garage)

For identification only - Not to scale

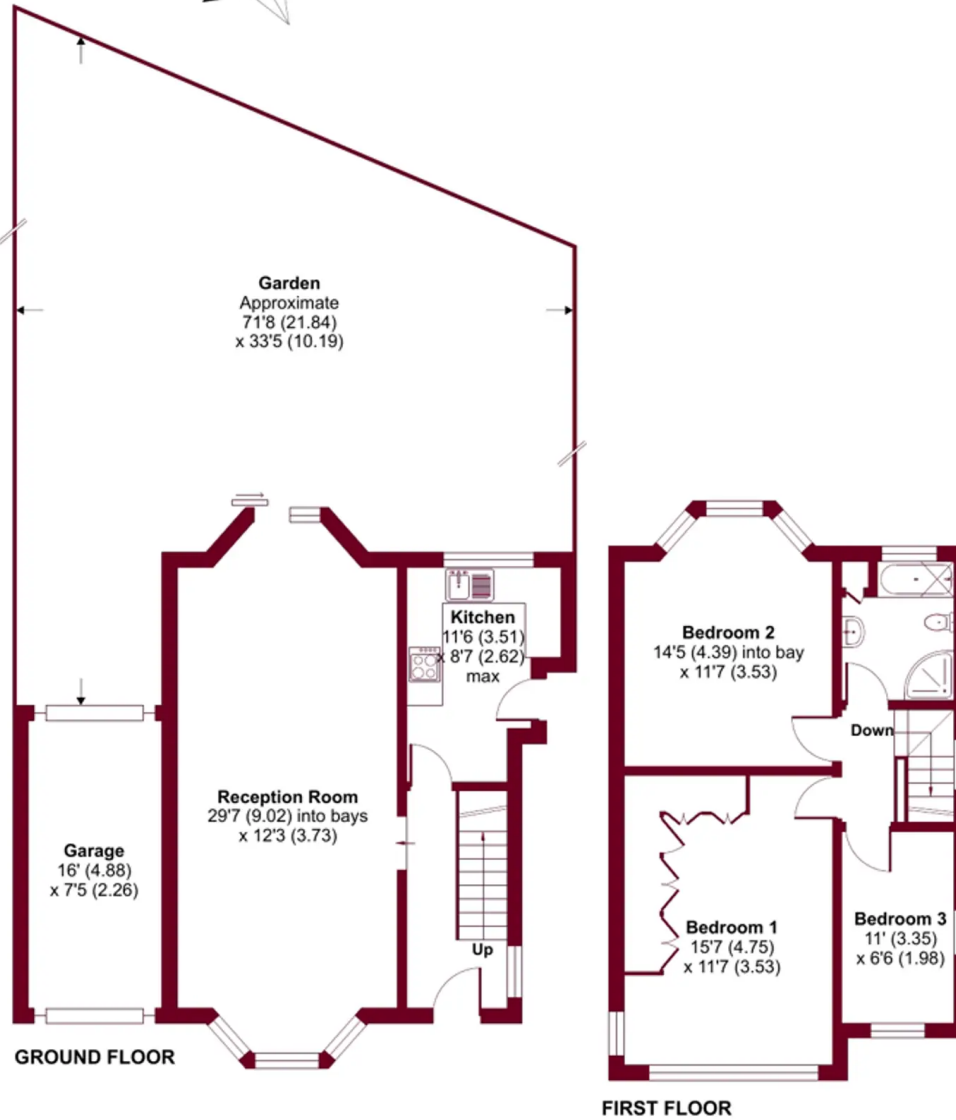



Lawrence Rand

Lawrence Rand, 106 Victoria Road - HA4 0AL

01895 632211

Info@lawrence-rand.co.uk

www.lawrence-rand.co.uk/



LAWRENCE RAND