



**328 Church Road, Northolt**

Northolt

**£500,000**



**LAWRENCE RAND**

# 328 Church Road

Northolt, Northolt

Council Tax band: D

Tenure: Freehold

EPC Energy Efficiency Rating: D

EPC Environmental Impact Rating: D

- 3 Bedroom End Terrace House
- Excellent Condition Throughout
- Modern Kitchen
- Modern Bathroom
- Good Size Garden
- Ample Driveway Parking
- Close to Transport Facilities







**Approximate total area<sup>(1)</sup>**

762.28 ft<sup>2</sup>  
70.82 m<sup>2</sup>

**Reduced headroom**

13.01 ft<sup>2</sup>  
1.21 m<sup>2</sup>

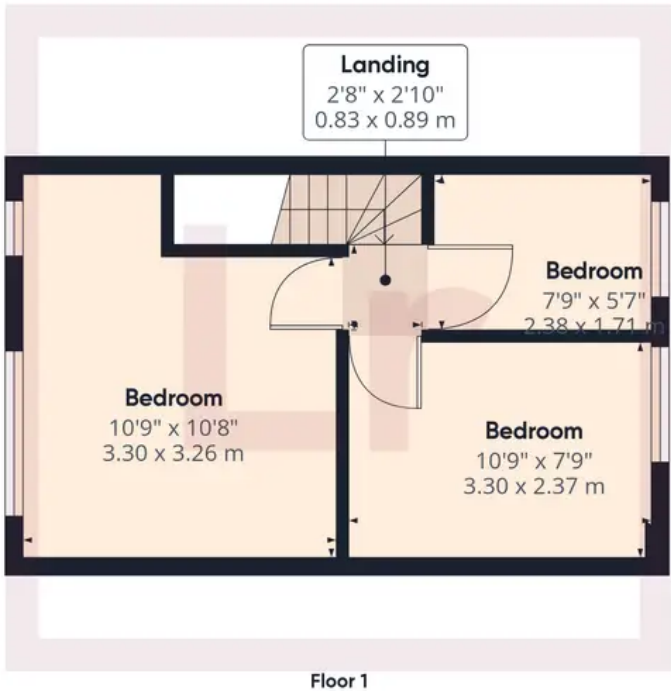

(1) Excluding balconies and terraces

☒ Reduced headroom  
(below 1.5m/4.92ft)

While every attempt has been made to ensure accuracy, all measurements are approximate, not to scale. This floor plan is for illustrative purposes only.



## Lawrence Rand

Lawrence Rand, 106 Victoria Road - HA4 0AL

01895 632211

[Info@lawrence-rand.co.uk](mailto:Info@lawrence-rand.co.uk)

[www.lawrence-rand.co.uk/](http://www.lawrence-rand.co.uk/)



**LAWRENCE RAND**