



Flat 12, Jameston Lodge, 36 Pembroke Road

Ruislip

£95,000

Lr LAWRENCE RAND

Flat 12

Jameston Lodge, Ruislip

'Shared ownership retirement flat' A stunning one bedroom retirement apartment (over 55's) situated on the first floor of this modern development in the heart of Ruislip in very close proximity to Ruislip's multiple shopping and transport facilities. The property is being sold as either 100% ownership or 1/3 shared ownership.

Council Tax band: C

Tenure: Leasehold

EPC Energy Efficiency Rating: B

EPC Environmental Impact Rating: B

- Retirement apartment
- Stunning condition
- Open plan living
- Modern Shower-room and Kitchen
- Long lease





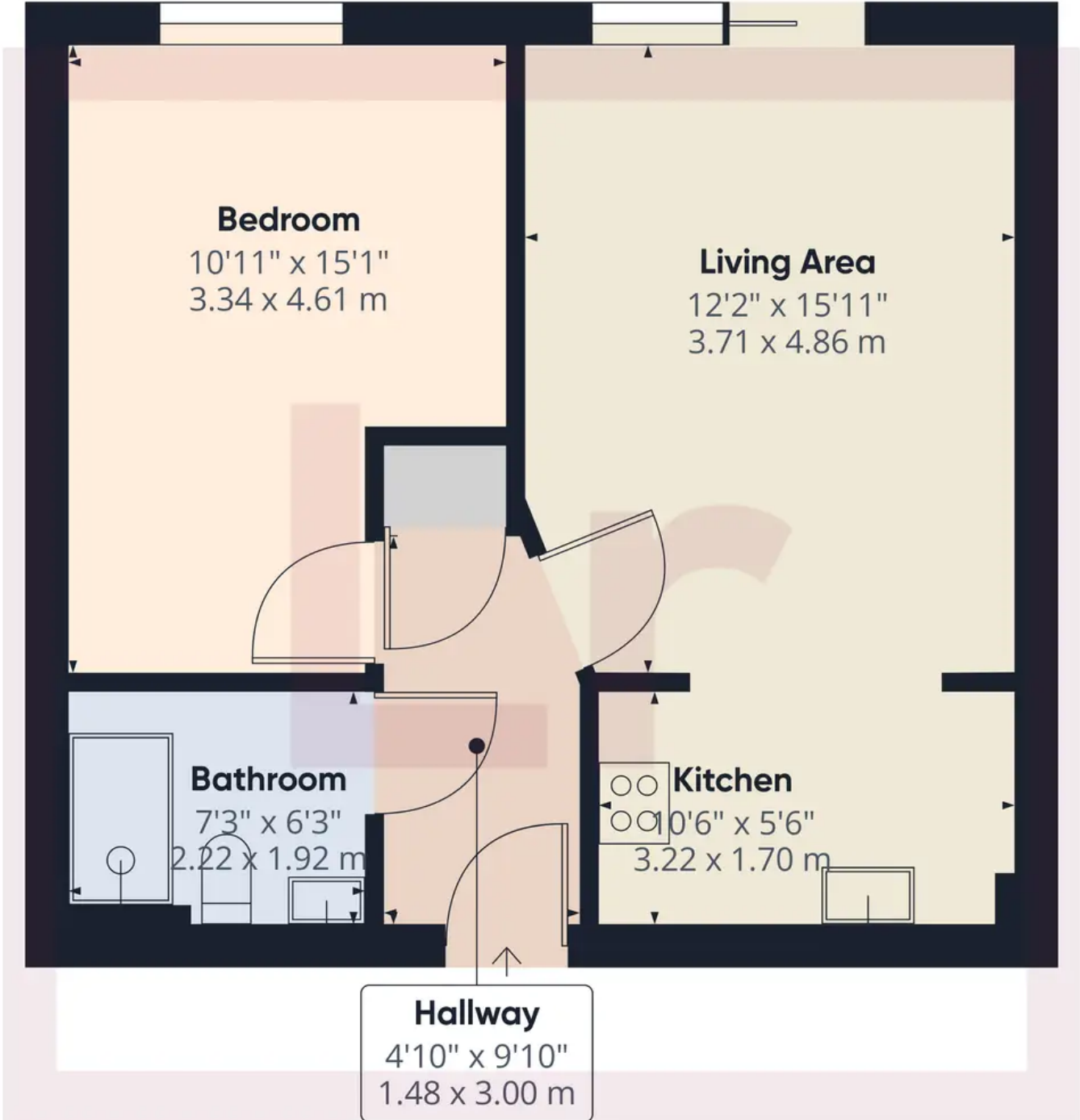

Approximate total area⁽¹⁾
499.33 ft²
46.39 m²

(1) Excluding balconies and terraces

While every attempt has been made to ensure accuracy, all measurements are approximate, not to scale. This floor plan is for illustrative purposes only.



Lawrence Rand

Lawrence Rand, 106 Victoria Road - HA4 0AL

01895 632211

Info@lawrence-rand.co.uk

www.lawrence-rand.co.uk/



LAWRENCE RAND