



YOUR MOVE
— Roebuck Residential —
WWW.YOUR-MOVE.CO.UK

Sovereign Court, Bradford, West
Yorkshire

£55,000

Sovereign Court, Bradford, West Yorkshire

£55,000

DESCRIPTION

EPC Rating: C Viewing is highly recommended to appreciate this delightful ground floor apartment situated in this popular residential area, close to good local amenities and with excellent commuter access to Leeds and Bradford. The well presented accommodation briefly comprises a hallway with built in store and linen cupboard, living kitchen with integrated appliances, double bedroom and a bathroom. With double glazing and electric wall heaters. EPC=C PLEASE NOTE - ** CASH BUYERS ONLY **

HALLWAY

With built in store and linen cupboard.

LIVING ROOM/KITCHEN

Open plan living kitchen. Fitted with an attractive range of wall and base units with coordinating work top space over, inset sink unit, electric oven and hob, integrated fridge and freezer, plumbing for washer. (please note appliances have not been tested).

BEDROOM

Double bedroom.

BATHROOM

Fitted suite comprising WC, wash hand basin, panelled bath with shower screen and shower over. Heated towel rail.

EXTERNALLY

Allocated parking space

AGENTS NOTE

** CASH BUYERS ONLY ** Lease Date: 8 June 2007
Commencement Date: 1 January 2006 Lease Term: 999
Years Remaining: 983 Ground Rent in Lease: £200.00
Service Charge: £705.86 paid annually

FLOOR PLAN

DIMENSIONS

Living room/kitchen - 6.71m x 3.79m (22'0" x 12'5")

Bedroom - 3.23m x 3.03m (10'7" x 9'11")



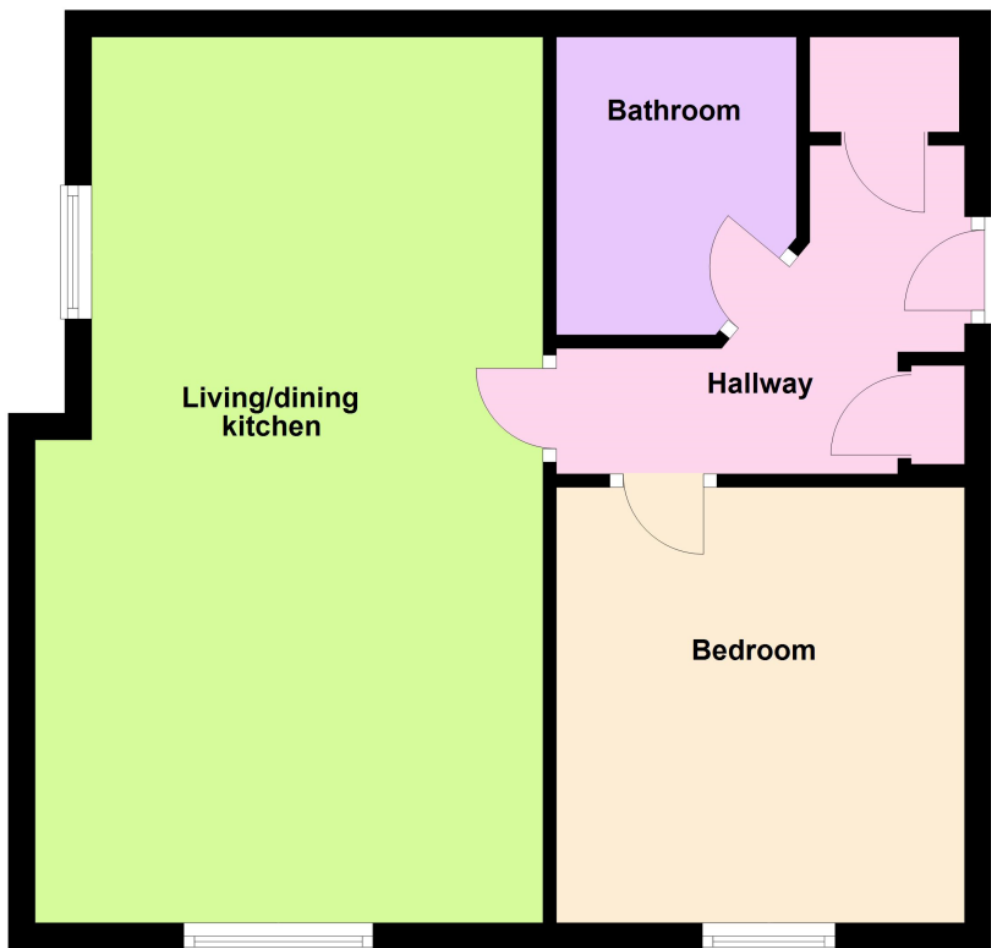

Your Move Roebuck Residential is the trading name of Roebuck Residential Ltd, registered company number 5959791, registered office 73 Moor Close Road Queensbury Bradford BD13 2EB. Your Move Roebuck Residential is an independently owned and operated business, operated under licence from your-move.co.uk Limited

IMPORTANT NOTE TO PURCHASERS: We endeavour to make our sales particulars accurate and reliable, however, they do not constitute or form part of an offer or any contract and none is to be relied upon as statements of representation or fact. The services, systems and appliances listed in this specification have not been tested by us and no guarantee as to their operating ability or efficiency is given. All measurements have been taken as guide to prospective buyers only, and are not precise. Floor plans where included are not to scale and accuracy is not guaranteed. If you require clarification or further information on any points, please contact us, especially if you are travelling some distance to view. Fixtures and fittings other than those mentioned are to be agreed with the seller.

*Source: Hitwise Nov 2011.

**Calls may be recorded and/or monitored for training and/or security purposes.



5 Northgate, Baildon, Shipley, West Yorkshire, BD17 6LX
 tel: 01274 591952 **
 email: Baildon@your-move.co.uk
 www.your-move.co.uk - The UK's most visited estate agency website*

YOUR MOVE
 — Roebuck Residential —
 WWW.YOUR-MOVE.CO.UK