



Islip Street, London

NW5 2DL

£2,150pcm SHORT LET

*Video tour available. A delightful apartment arranged over the raised ground floor of a period conversion. Islip Street is situated within the hub of Kentish Town with a wide array of cafe's, bars, restaurants and strong transport links to the City.



London

NW5

- A Bright & Spacious Reception Room
- Fully Fitted Kitchen
- Double Bedroom
- Shower Room
- High Ceilings & Wooden Flooring Throughout
- Walking Distance to Local Amenities and Transport Links



*Video tour available. A delightful one bedroom apartment arranged over the raised ground floor of a period conversion. The accommodation comprises; a bright and spacious reception room, fully integrated kitchen, double bedroom and a shower room.

The property enjoys an abundance of natural light and further benefits from high ceilings and wooden flooring throughout. Offered unfurnished and available from mid-December.

Islip Street is a conveniently located to the many cafe's, restaurants and bars that Kentish Town has to offer as well as Kentish Town Underground Station (Northern line) with links into the City.

Minimum Term: months
Deposit Required: £0.00
Local Authority:
Council Tax Band:
EPC Rating: C
Part Furnished, Unfurnished

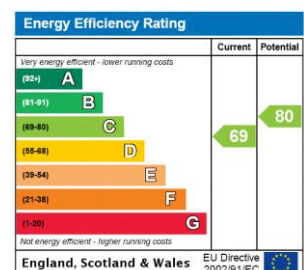

Chestertons Kentish Town Lettings

225 Kentish Town Road
 London
 NW5 2JU
kentishtown@chestertons.co.uk
 02072671010
chestertons.co.uk

Additional tenant charges apply (fees apply to non-AST tenancies only)
 Tenancy Agreement Fee: £300
 References per Tenant/Guarantor: £60
 Inventory check (approx. £100 – £250 inc. VAT)
chestertons.co.uk/property-to-rent/applicable-fees

Islip Street

Approximate Gross Internal Area = 458 sq ft / 42.6 sq m

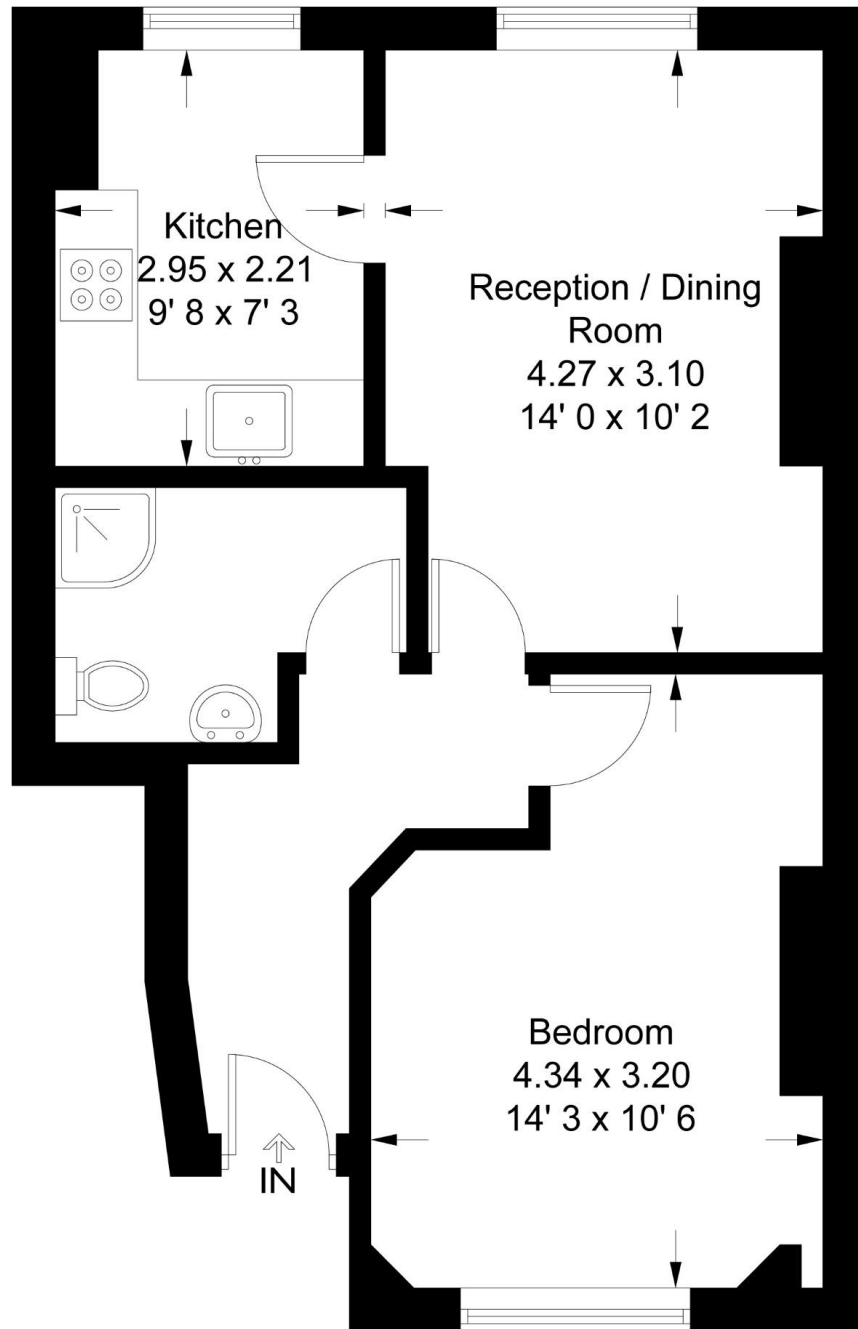

Raised Ground Floor

Not to scale, for guidance only and must not be relied upon as a statement of fact
All measurements and areas are approximate only and have been prepared in
accordance with the current edition of the RICS Code of Measuring Practice

