

Wentwood House, Upper Clapton Road, E5

Approx. Gross Internal Area 610 Sq Ft - 56.67 Sq M (Excluding Balcony)
Approx. Gross Internal Area 718 Sq Ft - 66.70 Sq M (Including Balcony)

OAKWOOD

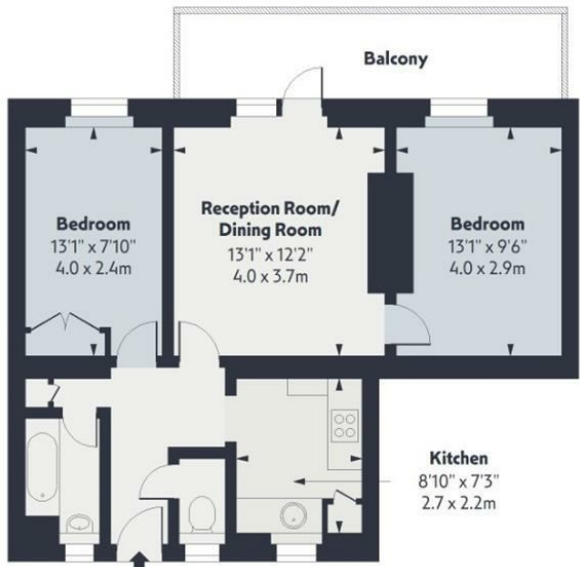

Fourth Floor

Floor Area 610 Sq Ft - 56.67 Sq M



Measured according to RICS IPMS2. Floor plan is for illustrative purposes only and is not to scale. Every attempt has been made to ensure the accuracy of the floor plan shown, however all measurements, fixtures, fittings and data shown are an approximate interpretation for illustrative purposes only. 1 sq m = 10.76sq feet.

lpaplus.com

Date: 21/2/2025

Whilst every attempt has been made to ensure the accuracy of the floor plan contained here, measurements of doors, windows, rooms and any other items are approximate and no responsibility is taken for any error, omission or mis-statement. This plan is for illustrative purposes only and should be used as such by any prospective purchaser. The services, systems and appliances shown have not been tested and no guarantee as to their operability or efficiency can be given.



£1,900

Oakwood are pleased to offer this spacious two-bedroom flat, conveniently situated between Clapton and Stoke Newington stations. Recently redecorated, the property features two generously sized double bedrooms, a good-sized private balcony, and ample storage throughout. Residents' parking is available



- 2 DOUBLE BEDROOMS
- NEWLY DECORATED

- LARGE BALCONY

