

Flanders House, N16

Approx. Gross Internal Area 680 Sq Ft - 63.17 Sq M

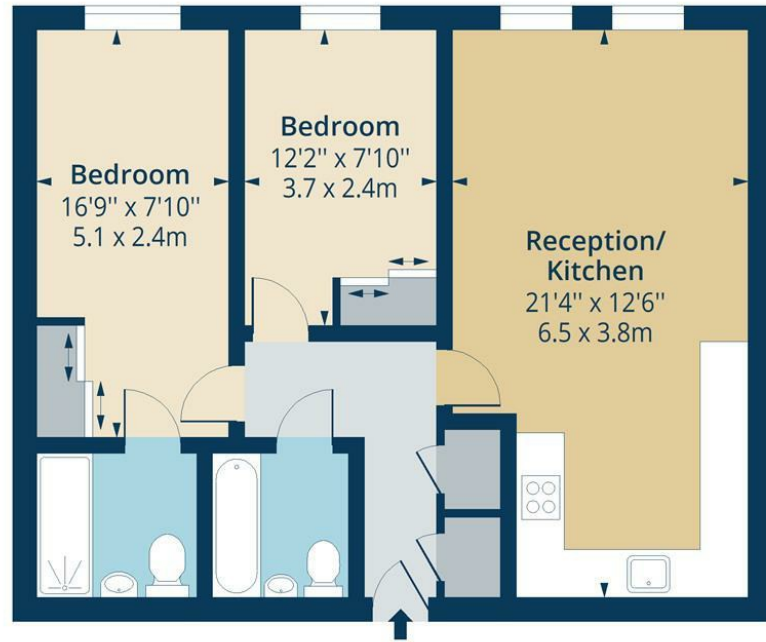

First Floor

Floor Area 680 Sq Ft - 63.17 Sq M



Measured according to RICS IPMS2. Floor plan is for illustrative purposes only and is not to scale. Every attempt has been made to ensure the accuracy of the floor plan shown, however all measurements, fixtures, fittings and data shown are an approximate interpretation for illustrative purposes only. 1 sq m = 10.76 sq feet.

lpaplus.com

Date: 23/9/2024

Whilst every attempt has been made to ensure the accuracy of the floor plan contained here, measurements of doors, windows, rooms and any other items are approximate and no responsibility is taken for any error, omission or mis-statement. This plan is for illustrative purposes only and should be used as such by any prospective purchaser. The services, systems and appliances shown have not been tested and no guarantee as to their operability or efficiency can be given.



While we endeavor to make our sales details accurate and reliable, if there is any point which is of particular importance to you, please contact the office and we will be pleased to confirm the position for you. Particularly if contemplating traveling some distance to view the property. All room sizes have been measured with an electronic sonic tape, the accuracy of which cannot be guaranteed. You are advised to make your own checks before contemplating a purchase, especially if an exact measurement is of particular importance to you.



Defoe Road, N16



£2,250

This spacious and bright two-bedroom, two-bathroom apartment is ideally situated just off of Church Street in the heart of Stoke Newington. The property features two generous double bedrooms, and is flooded with natural light

Located within walking distance of both Stoke Newington and Rectory Road stations with the lovely Clissold Park is only moments away and an array of cafes, restaurants, and boutiques on your doorstep. This is a fantastic opportunity to experience the best of Stoke Newington living!

oakwoodestateagents.com

48 Stoke Newington Church Street
London N16 ONB

Tel 020 7249 1000
Fax 020 7249 2000

Company No. 2995463, Oakwood Estate Agents Limited T/A Oakwood

www.oakwoodestateagents.com



• TWO DOUBLE BEDROOMS

• AMAZING LOCATION

