

Birkbeck Mansions, N8
Approx. Gross Internal Area 541 Sq Ft - 50.26 Sq M

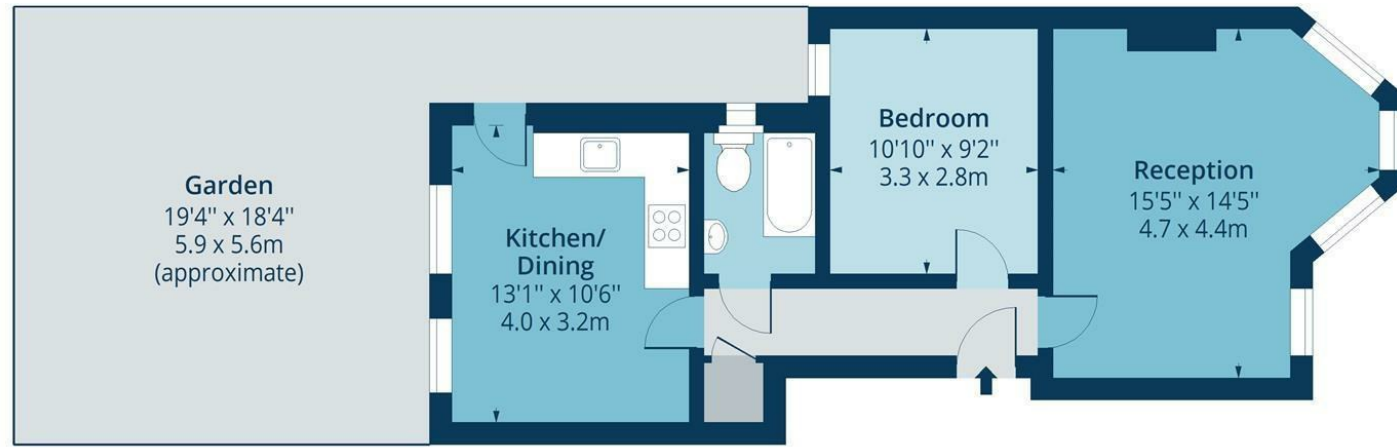

Ground Floor

Floor Area 541 Sq Ft - 50.26 Sq M



Measured according to RICS IPMS2. Floor plan is for illustrative purposes only and is not to scale. Every attempt has been made to ensure the accuracy of the floor plan shown, however all measurements, fixtures, fittings and data shown are an approximate interpretation for illustrative purposes only. 1 sq m = 10.76 sq feet.

lpaplus.com

Whilst every attempt has been made to ensure the accuracy of the floor plan contained here, measurements of doors, windows, rooms and any other items are approximate and no responsibility is taken for any error, omission or mis-statement. This plan is for illustrative purposes only and should be used as such by any prospective purchaser. The services, systems and appliances shown have not been tested and no guarantee as to their operability or efficiency can be given.



£400,000 Leasehold

CHAIN FREE! A one bedroom ground floor garden flat, set in a mansion building on Birkbeck Road, N8. The property offers a large bright reception room with original stripped floorboards, a modern separate kitchen, one double bedroom and tiled bathroom with both bath and shower facilities. An additional benefit is the generously sized PRIVATE REAR GARDEN, which also offers exceptional exterior storage space.

Conveniently located within close walking distance to popular local high street amenities; Crouch End Broadway, Hornsey High Street, and Muswell Hill Broadway, as well as giving easy access to transport links such as Hornsey mainline and Turnpike Lane tube station (Piccadilly Line). The nearby open green spaces of Priory park and Alexandra Palace can be enjoyed as well.



While we endeavor to make our sales details accurate and reliable, if there is any point which is of particular importance to you, please contact the office and we will be pleased to confirm the position for you. Particularly if contemplating traveling some distance to view the property. All room sizes have been measured with an electronic sonic tape, the accuracy of which cannot be guaranteed. You are advised to make your own checks before contemplating a purchase, especially if an exact measurement is of particular importance to you.

oakwoodestateagents.com

48 Stoke Newington Church Street
London N16 0NB
Company No. 2995463, Oakwood Estate Agents Limited T/A Oakwood

Tel 020 7249 1000
Fax 020 7249 2000
www.oakwoodestateagents.com

