

Oakleigh Road North, N20  
Approx. Gross Internal Area 682 Sq Ft - 63.36 Sq M

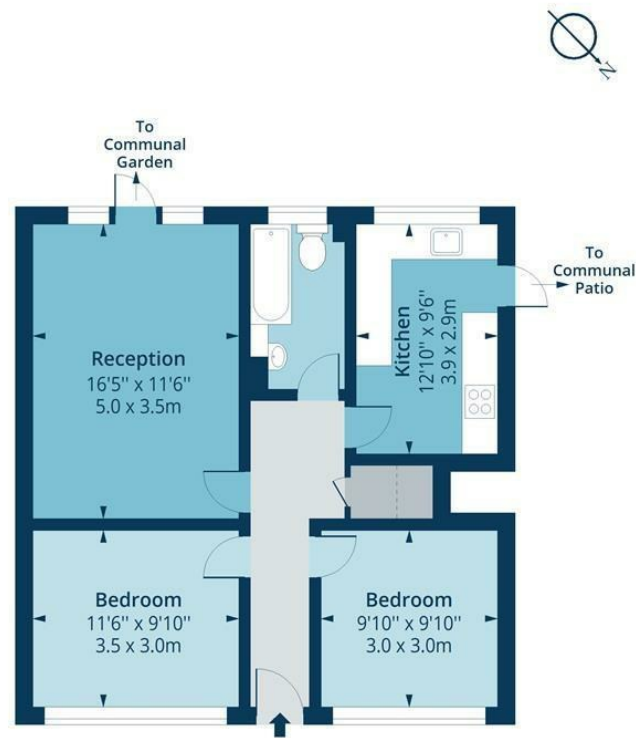

**Ground Floor**  
Floor Area 682 Sq Ft - 63.36 Sq M



Measured according to RICS IPMS2. Floor plan is for illustrative purposes only and is not to scale. Every attempt has been made to ensure the accuracy of the floor plan shown, however all measurements, fixtures, fittings and data shown are an approximate interpretation for illustrative purposes only. 1 sq m = 10.76 sq feet. [ipaplus.com](http://ipaplus.com)

Whilst every attempt has been made to ensure the accuracy of the floor plan contained here, measurements of doors, windows, rooms and any other items are approximate and no responsibility is taken for any error, omission or mis-statement. This plan is for illustrative purposes only and should be used as such by any prospective purchaser. The services, systems and appliances shown have not been tested and no guarantee as to their operability or efficiency can be given.



## Oakleigh Road North, N20



## £400,000 Leasehold

**CHAIN FREE.** An excellently presented two bedroom maisonette, located on Oakleigh Road North, N20. The property is in good condition throughout and comprises a large bright reception room with parquet flooring and access to the extensive green communal space, a modern separate semi-integrated kitchen, two generously sized double bedrooms, and a stylish bathroom with both bath and shower facilities. This home also comes with the added benefit of private patio space. **LEASEHOLD - 120 YEARS.**

Conveniently located within close proximity to Whetstone; ideal for both commuters and families alike. Located in zone 4, Totteridge and Whetstone station tube station (northern line) offers easy access in and out of London. The property is also close to some lovely open green spaces such as Bethune Park and Brunswick Park.



While we endeavor to make our sales details accurate and reliable, if there is any point which is of particular importance to you, please contact the office and we will be pleased to confirm the position for you. Particularly if contemplating traveling some distance to view the property. All room sizes have been measured with an electronic sonic tape, the accuracy of which cannot be guaranteed. You are advised to make your own checks before contemplating a purchase, especially if an exact measurement is of particular importance to you.

[oakwoodestateagents.com](http://oakwoodestateagents.com)

48 Stoke Newington Church Street  
London N16 0NB  
Company No. 2995463, Oakwood Estate Agents Limited T/A Oakwood

Tel 020 7249 1000  
Fax 020 7249 2000  
[www.oakwoodestateagents.com](http://www.oakwoodestateagents.com)

