



£2,496 PER MONTH

CHEYNE PLACE, CHELSEA, LONDON, SW3

PROPERTY  
CHEYNE PLACE, CHELSEA, LONDON, SW3



A well-presented one bedroom apartment situated on the raised ground floor with a lift, resident porter and views over a lovely back garden.



This tranquil apartment comprises of open plan fully fitted kitchen with a reception room, entrance hallway as well as a double bedroom with storage space and a spacious family bathroom.



Cheyne Place, the popular 1920's flat block, is set in one of Chelsea's most popular residential areas, across the road from Chelsea Physic Gardens and moments from Burtons Court and the Royal Hospital Chelsea (home of the annual Chelsea Flower Show) this property truly is located in the heart of Chelsea.

The Kings Road is a short walk to the north and Sloane Square underground station and Sloane Street are within 10 minutes walk.

Available now.





Cheyne Place, SW3

CAPTURE DATE 15/02/2023 LASER SCAN POINTS 39,667,715

GROSS INTERNAL AREA

42.12 sqm / 453.38 sqft

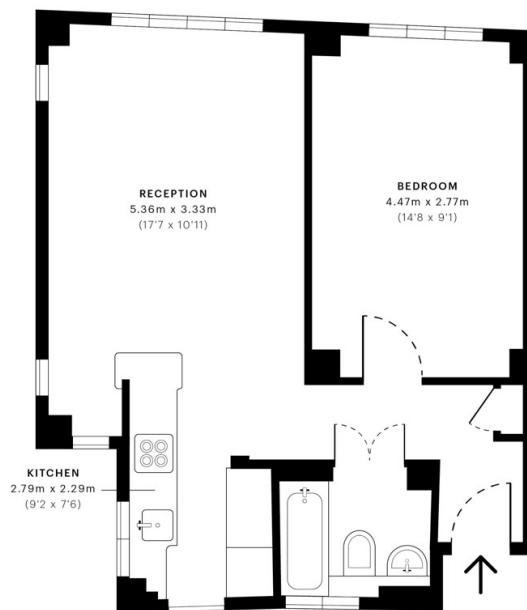

— Ground Floor



Spec Verified floor plans are produced in accordance with Royal Institution of Chartered Surveyors Property Measurement Standards. Plans and gardens are illustrative only and excluded from all area calculations. Due to rounding, numbers may not add up precisely. All measurements shown for the individual room lengths and widths are the maximum points of measurements captured in the scan.

PHS 28 RESIDENTIAL 453.38sqm / 484.29sqft  
PHS 32 RESIDENTIAL 41.48sqm / 444.49sqft

SPEC ID: 563ea463f4c29010dcb228d75