



ESTATE AGENTS

18, Mann Street, Hastings, TN34 1SE

Web: www.pcmestateagents.co.uk
Tel: 01424 839111

Price £318,500

PCM Estate Agents are delighted to present to the market an opportunity to secure this CHAIN FREE END OF TERRACE VICTORIAN BAY FRONTED FOUR BEDROOMED HOUSE with LOFT ROOM located on this sought-after town centre road within walking distance to Hastings mainline railway station with its many direct trains to London, Priory Meadow with a number of retail outlets and of course Hastings seafront and pier.

The property is IN NEED OF MODERNISATION but does offer well-proportioned accommodation arranged over FOUR FLOORS. To the lower floor there is a lounge, SEPARATE DINING ROOM, kitchen, lean to and access onto the COURTYARD TERRACED GARDEN. To the ground floor there are TWO BEDROOMS, bathroom and a separate wc, first floor landing with two bedrooms and to the second floor is a LOFT ROOM that is currently used as a fifth bedroom. The property has gas central heating, double glazed windows and offers VERSATILE ACCOMMODATION that could be arranged in many different ways.

Please call the owners agents now to book your viewing and avoid disappointment.

STAIRS DESCENDING FROM STREET LEVEL

To the lower floor of the property with private front door to:

ENTRANCE HALL

Wall mounted consumer unit for the electrics, tiled flooring, radiator, stairs rising to upper floor accommodation, under stairs storage space.

DOWNSTAIRS WC

Low level wc, wash hand basin.

LIVING ROOM

15'1 into bay x 10'9 (4.60m into bay x 3.28m)

Double radiator, double glazed bay window to front aspect.

DINING ROOM

14'4 x 9'2 narrowing to 8' (4.37m x 2.79m narrowing to 2.44m)

Double radiator, double glazed window to rear aspect.

KITCHEN

13'4 x 7'5 (4.06m x 2.26m)

Fitted with a matching range of eye and base level cupboards and drawers with worksurfaces over, inset drainer-sink unit with mixer tap, space and plumbing for washing machine and dishwasher, space for tall fridge freezer, wall mounted boiler, space for countertop microwave or electric plug in cooker, double glazed pattern glass window to rear aspect, window and door to side providing access and outlook onto:

LEAN TO

14'2 x 5' (4.32m x 1.52m)

Tiled flooring, workbench, double glazed French doors to garden.

GROUND FLOOR HALLWAY

Stairs rising to first floor accommodation, telephone point, double glazed door to front providing another access point to the property, radiator, door to:

BEDROOM

15'4 into bay x 11'1 (4.67m into bay x 3.38m)

Cornicing, picture rail, double radiator, double glazed bay window to front aspect with views of Hastings Castle.

BEDROOM

14'5 x 8'9 narrowing to 7'7 (4.39m x 2.67m narrowing to 2.31m)

Radiator, double glazed window to rear aspect.

BATHROOM

Panelled bath, separate walk in shower, pedestal wash hand basin, part tiled walls, tiled flooring, double aspect with double glazed windows to side and rear.

SEPARATE WC

Loft hatch providing access to loft space, wash hand basin, tiled flooring.

FIRST FLOOR LANDING

Stairs rising to the second floor, double glazed window to rear aspect.

BEDROOM

15'2 x 12'4 (4.62m x 3.76m)

Built in cupboard, fireplace, double glazed windows to front aspect with views towards Hastings Castle.

BEDROOM

14'4 x 9'4 narrowing to 7'9 (4.37m x 2.84m narrowing to 2.36m)

Fireplace, radiator, double glazed window to rear aspect.

SECOND FLOOR LANDING

Door to:

LOFT ROOM

11'9 x 13'7 max narrowing to 9'9 (3.58m x 4.14m max narrowing to 2.97m)

Velux windows to front and rear aspects, radiator, pleasant outlook from the front of the house towards Hastings Castle.

OUTSIDE - FRONT

The property is set back from the road in a slightly elevated position with steps up to one of two front doors, also having stairs descending to the lower floor with courtyard and access to the property.

REAR GARDEN

Courtyard style garden arranged over two terraces, in need of some cultivation and updating, outside storage.

Council Tax Band: C



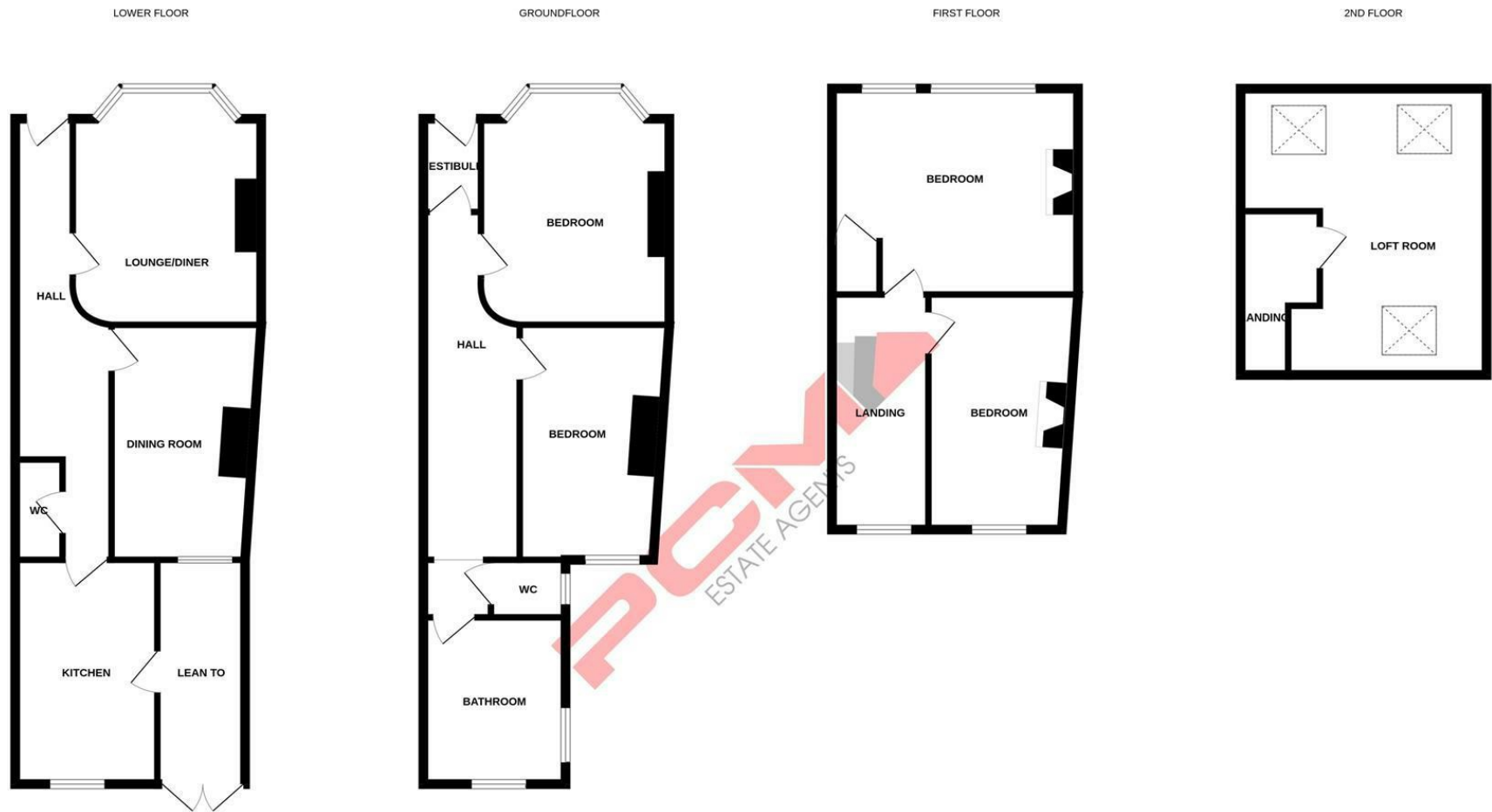

Whilst every attempt has been made to ensure the accuracy of the floorplan contained here, measurements of doors, windows, rooms and any other items are approximate and no responsibility is taken for any error, omission or mis-statement. This plan is for illustrative purposes only and should be used as such by any prospective purchaser. The services, systems and appliances shown have not been tested and no guarantee as to their operability or efficiency can be given.
Made with Metropix ©2023

PCM endeavour to maintain accurate depictions of properties in Floor Plans and descriptions, however, these are intended only as a guide and purchasers must satisfy themselves by personal inspection. PCM have not tested any services, appliances, equipment or facilities, and nothing in these details should be deemed to be a statement that they are in good working order or that the property is in good structural condition or otherwise.

