



5 Andrews Close, Theale, Reading, Berkshire, RG7 5BH

£1,300 PCM

- FIRST FLOOR MAISONETTE
- KITCHEN
- FAMILY BATHROOM
- GAS CENTRAL HEATING
- 2 BEDROOM
- LOUNGE/DINER
- DOUBLE GLAZED WINDOWS
- OWN ENTRANCE TO GARDEN
- AVAILABLE IMMEDIATELY

Ground Floor

Approx. 48.7 sq. metres (524.2 sq. feet)

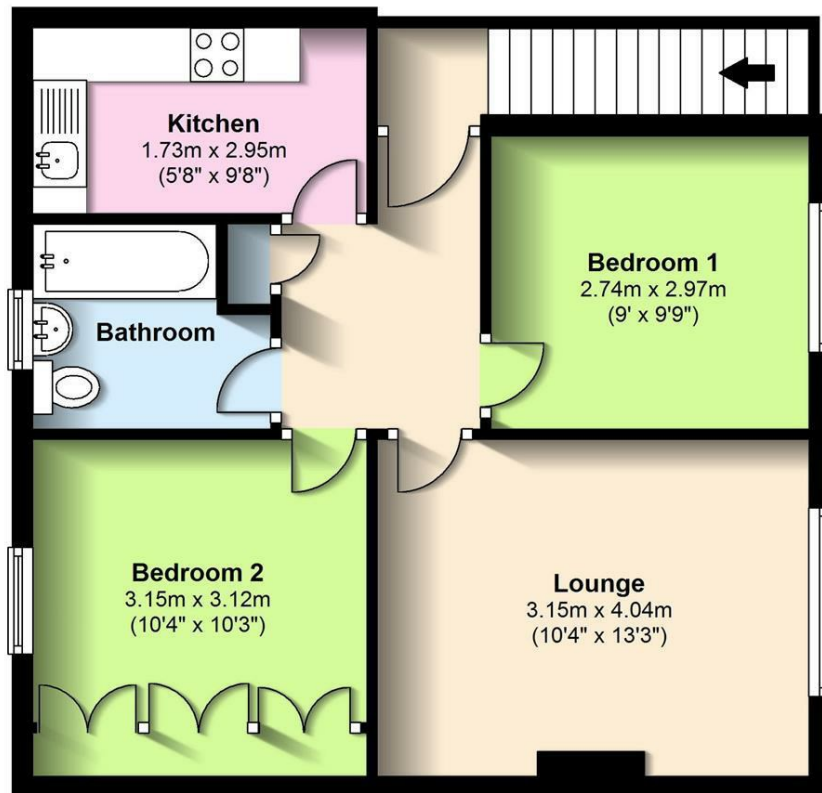

Total area: approx. 48.7 sq. metres (524.2 sq. feet)

1st floor maisonette situated in the quaint village of Theale. This property features 2 good sized bedrooms, lounge/diner, kitchen, family bathroom, double glazed windows and gas central heating. It also has its own entrance to a very sizable garden. Superb travel links easily accessible with bus route, train station and M4 access. AVAILABLE IMMEDIATELY.

| Energy Efficiency Rating | | |
|---|---------|-------------------------|
| | Current | Potential |
| Very energy efficient - lower running costs | | |
| (92 plus) A | | |
| (81-91) B | | |
| (69-80) C | | |
| (55-68) D | | |
| (39-54) E | | |
| (21-38) F | | |
| (1-20) G | | |
| Not energy efficient - higher running costs | | |
| England & Wales | | |
| | | EU Directive 2002/91/EC |

INTERESTING INFO

DIRECTIONS

CONTACT

92 School Lane

TileHurst

RG31 5AU

0118 9433 9000

Nikki@villageproperties.org