



7 Ronver Lodge Newgate Street

, London, E4 6JF

Offers Over £299,995

CHAIN FREE Roselins have great pleasure in offering to the market this 2 bedroom apartment situated on the top floor of the well kept, modern Ronver Lodge complex.

Located in close proximity to Friday Hill and within walking distance of Chingford Hatch facilities and a short bus ride to North Chingford as well as Highams Park, both offering mainline stations serving Liverpool Street.

Benefits to the property includes: 2 bedrooms, spacious lounge, modern fitted kitchen and bathroom. This property also has the benefit of nicely maintained communal gardens and its own private garage.

Please contact Roselins to arrange an internal inspection.

Viewing

Please contact our Chingford Office on 0208 529 8700 if you wish to arrange a viewing appointment for this property or require further information.

- 2 Bedroom top floor apartment
- Spacious Lounge
- Modern fitted Kitchen
- Well maintained communal gardens
- Excellent transport links
- Own private garage



Floor Plan

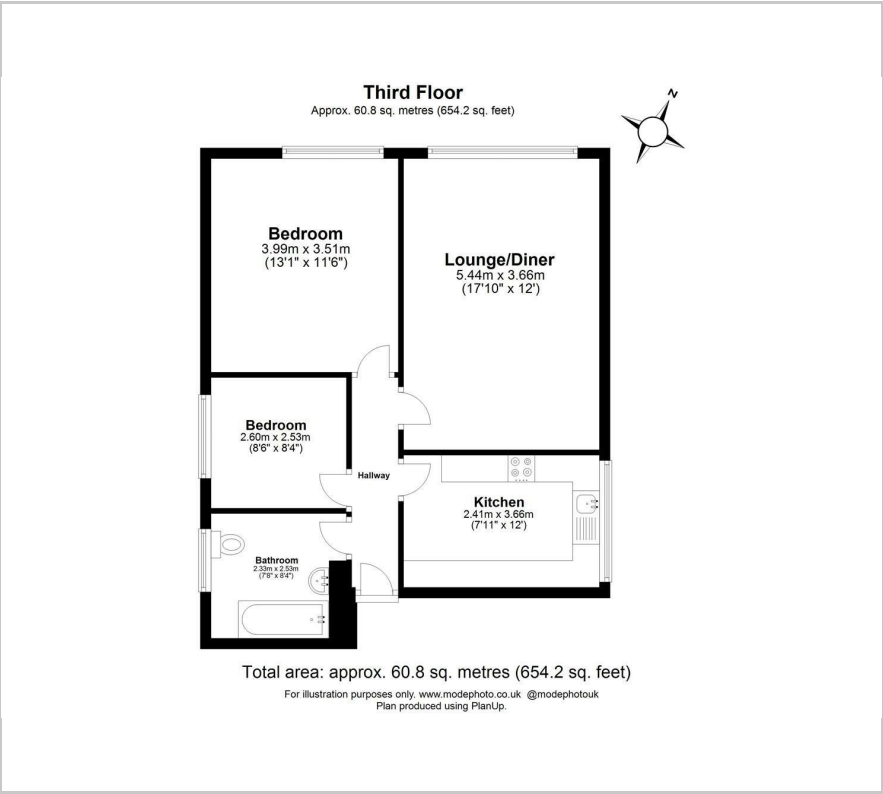

Area Map

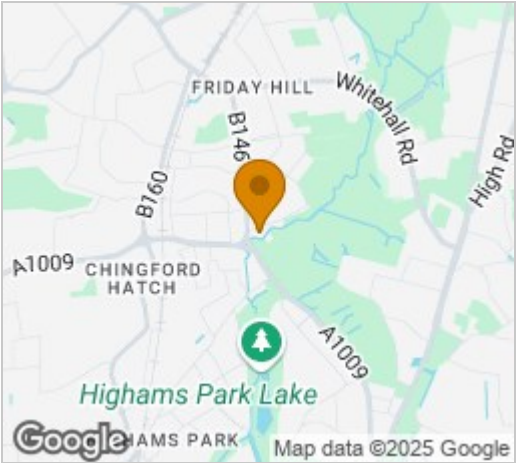

Energy Efficiency Graph

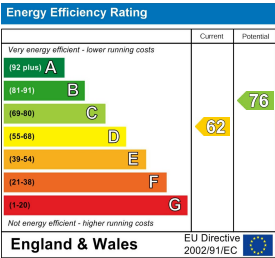

These particulars, whilst believed to be accurate are set out as a general outline only for guidance and do not constitute any part of an offer or contract. Intending purchasers should not rely on them as statements of representation of fact, but must satisfy themselves by inspection or otherwise as to their accuracy. No person in this firms employment has the authority to make or give any representation or warranty in respect of the property.