



**Taylors**



## Beeches Road, Rowley Regis, B65 0BB

Offers In Region Of £135,000

🛏 2 🍳 1 🛋 2

- Two double bedrooms
- Two reception rooms
- Modern ground floor wet room
- Good size rear garden
- No upward chain
- Council tax band A
- Highly convenient location
- Double glazing and gas central heating



A spacious traditional terraced home offering two generous double bedrooms and the advantage of no upward chain. Ideally positioned on a highly convenient and well-regarded road, the property benefits from double glazing and gas central heating throughout. The accommodation comprises a welcoming living room, an inner lobby with useful under stairs storage, a separate dining room, a rear vestibule, a fitted kitchen and a rear lobby with airing cupboard leading to the ground-floor shower room. To the first floor, there is a landing area giving access to two well-proportioned double bedrooms. Externally, the property enjoys a good-sized rear garden, offering excellent potential for outdoor seating or landscaping. An ideal purchase for first-time buyers, downsizers or investors, this property presents an excellent opportunity in a popular location. Early viewing is recommended. All main services connected. Tenure Freehold. Council Tax Band A. EPC C. Broadband/ Mobile coverage: <https://checker.ofcom.org.uk/en-gb/broadband-coverage>. Construction, brick built and tiled (Flat roof to rear extension). Long term flood risk, surface water - very low, rivers - very low.

**Living Room** - 3.58m x 3.48m (11'9" x 11'5")

**Inner lobby with store**

**Dining Room** - 3.61m x 3.4m (11'10" x 11'2")

**Vestibule**

**Kitchen** - 3.12m x 2.9m (10'3" x 9'6")

**Bathroom** - 2.01m x 1.8m (6'7" x 5'11")

**First floor landing**

**Bedroom Two** - 3.43m x 3.18m (11'3" x 10'5" into wardrobe)

**Bedroom One** - 3.58m x 3.43m (11'9" x 11'3")

**Rear garden**







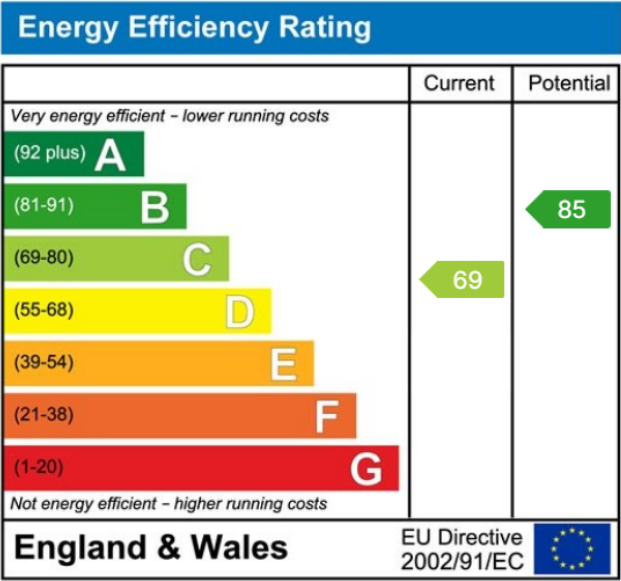
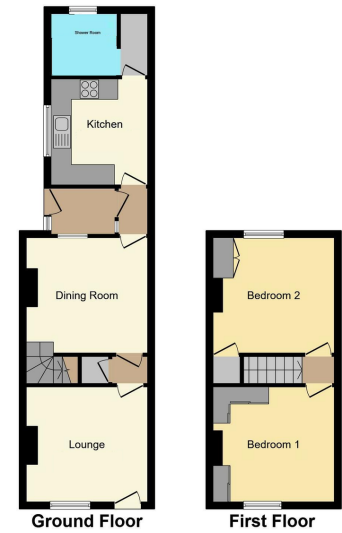

**MISREPRESENTATION ACT 1967:** These particulars do not constitute any part of an offer or a contract. Whilst every care is taken to ensure accuracy, no responsibility for errors or misdescription is accepted. Any intending purchaser must satisfy themselves by inspection or otherwise as to the correctness of each of the statements in these particulars. The vendor does not make nor give, and neither Taylors nor any person in their employment has any authority to make or give any representation or warranty whatsoever about this property. As the seller's estate agents, we are not surveyors or conveyancing experts, and we cannot comment on the property's condition or issues relating to the title or other legal issues that may affect this property unless we have been made aware of such matters. Interested parties should employ professionals to make such enquiries before making transactional decisions. **EPC:** can be supplied free of charge. **CONSUMER PROTECTION REGULATIONS (2008):** These particulars have been prepared with care and approved by the vendors (where possible) but are intended as a guide only, with measurements being approximate and usually the maximum size, which may include alcoves, recesses or otherwise as described, and you must NOT rely on them for any other purpose. The appearance of an item in any photograph does not mean that it forms part of the property or sale price. **FIXTURES AND FITTINGS:** Only those items specifically mentioned in these sales particulars are included in the sale price. Taylors have NOT tested any apparatus, equipment, fixture or fitting and cannot verify they are in working order or fit for their purpose. **PLANNING PERMISSION / BUILDING REGULATIONS:** Any reference to the property being extended, altered or converted in any way does not infer that planning permission or building regulations have been granted or applied for, nor do Taylors accept any responsibility for such not having been obtained. **FLOOR PLAN:** This plan is for illustrative purposes only. The services, systems and appliances shown have not been tested and no guarantee as to their operability or efficiency can be given.