

IMPORTANT NOTICE
Peter Roffeys Estate Agents Limited trading as Roffeys for themselves and for the sellers, or lessees of properties for whom they act, give notice that these particulars are intended as a general outline only as guidance for prospective purchasers, lessees or tenants, and do not constitute the whole or any part of an offer or contract. Peter Roffeys Estate Agents Limited, trading as Roffeys, cannot guarantee the accuracy of any descriptions, dimensions, floor plans, distances, references to condition and other details contained herein. All details in these particulars are given in good faith and believed to be correct however any prospective purchasers should not rely on them as statements or representations of fact but satisfy themselves by inspection or otherwise as to their accuracy prior to entering into any contractual obligation. No person in the employment of Peter Roffeys Estate Agents Limited has any authority to make or give any representation or warranty or enter into any contract whatsoever in relation to this property. Peter Roffeys Estate Agents Limited will not be liable, in negligence or otherwise, for any loss arising from the use of, or reliance upon, these particulars. All negotiations prior to exchange of formal contracts shall be deemed to be subject to Contract.

NOTES FOR INTERESTED PARTIES
No warranties are given in respect of the lawful planning use of the property and interested parties should satisfy themselves by making their enquiries with the local planning authority or otherwise, prior to entering into any contractual obligation. No services (including drains), apparatus, fixtures and fittings have been tested nor are they guaranteed and interested parties should carry out their own testing prior to entering into any contractual obligation. Any photographs are for identification purposes only and may include part of a neighbouring property which is not offered in this transaction, where for example it has not been possible to obtain a clear view of the property.

Total area: approx. 64.9 sq. metres (699.0 sq. feet)

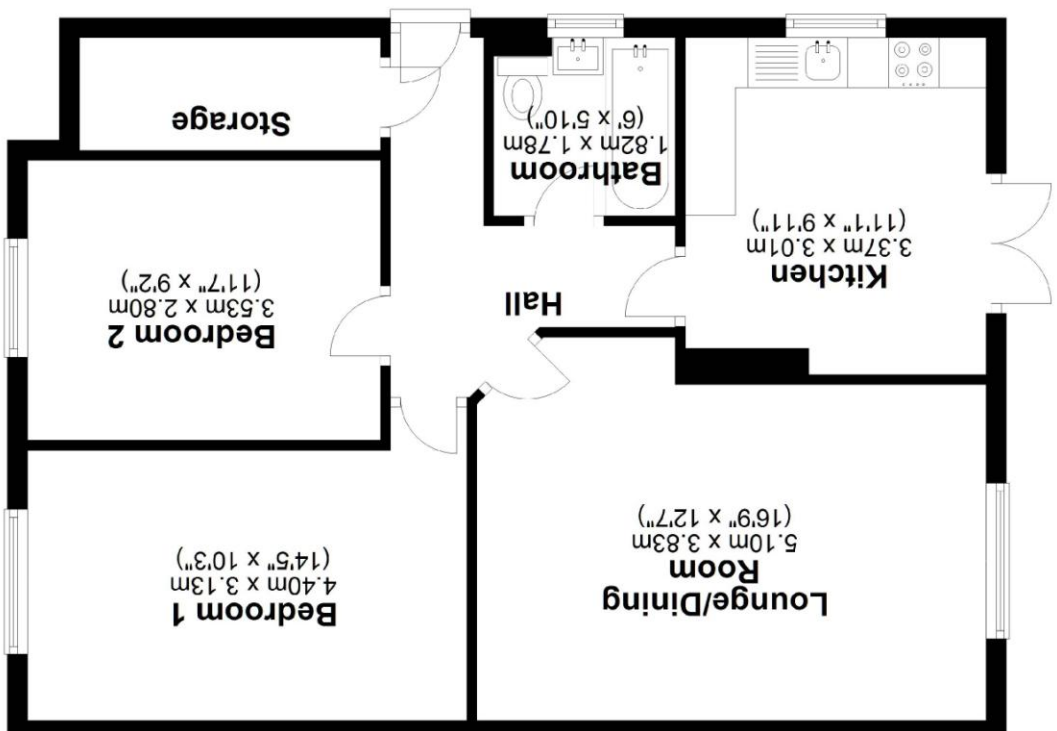

Floor plans are not to scale and are for illustrative purposes only.

YOU MAY BE ASSURED

SAFE AGENT
The National Approved Letting Scheme

THE PROPERTY OMBUDSMAN

THE GUILD OF PROFESSIONAL PROPERTY MANAGERS

PROTECTED propertymark

PROTECTED propertymark

TDSP
Tenancy Deposit Scheme member

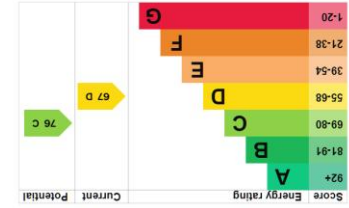

ROUNDHILLS, WALTHAM ABBEY, ESSEX



For an appointment to view call 01992 788088
or email enquiries@roffeys.net

Introduction

This ground floor maisonette with two double bedrooms benefits from secluded gardens to three sides and a garage en-bloc.

Accommodation includes lounge/diner, modern kitchen and bathroom and entrance hall with storage space.

The property has a long lease (940 years) with ground rent of just £20 pa

Summary

- Ground floor maisonette
- Two double bedrooms
- Lounge / diner
- Modern kitchen and bathroom
- Front, rear and side gardens
- Garage en-bloc
- Popular location
- Long leasehold
- Council Tax band 'C'

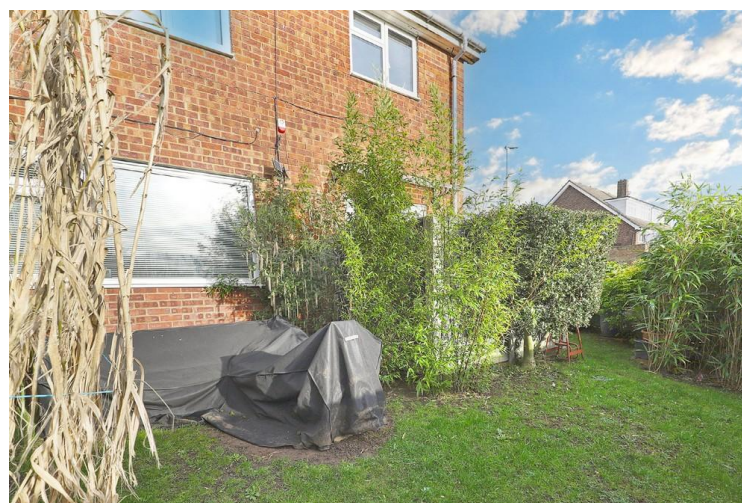

ENTRANCE HALL

BUILT-IN STORAGE SPACE

LOUNGE / DINING ROOM

16' 9" x 12' 7" (5.11m x 3.84m)

KITCHEN

11' 1" x 9' 11" (3.38m x 3.02m)

BATHROOM

6' 0" x 5' 10" (1.83m x 1.78m)

BEDROOM ONE

14' 5" x 10' 3" (4.39m x 3.12m)

BEDROOM TWO

11' 7" x 9' 2" (3.53m x 2.79m)

EXTERIOR:-

SECLUDED GARDENS TO THREE SIDES

GARAGE EN-BLOC

Approx.gross internal area: 699 sq.ft. (65 sq.m.)

GENERAL INFORMATION :-

Tenure: Leasehold
Term of lease: 999 years from 25 December 1967
Ground rent: £20 per annum
Energy rating: C
Borough: Epping Forest
Council Tax band: C
Energy Rating (EPC) current D (potential C)

