

STEPPING STONES

3-4 Horsefair • Banbury • Oxfordshire • OX16 0AA
Telephone: 01295 275909 • **Email:** info@steppingstonesletting.com



CHURCH LANE, BANBURY, OXON, OX16 5LR

£825pcm



A beautifully presented first floor one bedroom apartment situated conveniently in the town centre. The property offers integrated white goods, built in wardrobe and electric heating.

EPC Rating: C. Available: 12th June.

- 1 Bedroom
- 1 Bathroom
- First floor
- Electric heating
- Integrated appliances
- Town centre location

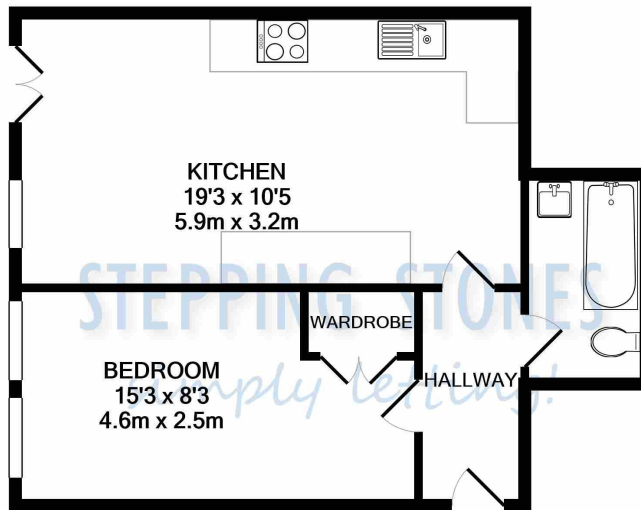

TOTAL APPROX. FLOOR AREA 395 SQ.FT. (36.7 SQ.M.)

Whilst every attempt has been made to ensure the accuracy of the floor plan contained here, measurements of doors, windows, rooms and any other items are approximate and no responsibility is taken for any error, omission, or mis-statement. This plan is for illustrative purposes only and should be used as such by any prospective purchaser. The services, systems and appliances shown have not been tested and no guarantee as to their operability or efficiency can be given
Made with Metropix ©2020

Score	Energy rating	Current	Potential
92+	A		
81-91	B		
69-80	C	73 c	75 c
55-68	D		
39-54	E		
21-38	F		
1-20	G		

RENT: £ 825.00
 TOTAL DEPOSIT: £ 951.92
 HOLDING DEPOSIT: £ 190.38

Holding deposit is payable when the application is made and is deducted from the initial rent if the application is successful.

Please Note: This is **non-refundable** should any relevant person (including any guarantor(s)) withdraw from the tenancy, fail a Right-to-Rent check, provide materially significant false or misleading information, or fail to sign their tenancy agreement (and / or Deed of Guarantee) within 15 calendar days (or other Deadline for Agreement as mutually agreed in writing).

ENTRANCE HALL: Door to front communal aspect. Video intercom entry phone security system.

LOUNGE/KITCHEN: 8'9 x 10'8 Window and Juliet balcony to front aspect. Kitchen area with modern kitchen units. Built in four ring electric hob and oven below. Washing machine. Undercounter fridge and freezer.

BEDROOM ONE: 14'10 x 8'11 Window to front aspect. Built in wardrobe.

BATHROOM: Comprising suite of bath with shower over, wash hand basin and low level w/c. Chrome towel radiator.

HEATING: Electric heating

PARKING: No allocated car parking

COUNCIL TAX: Band A

EPC RATING: C

REFERENCE: 413

Important Notice

Every care has been taken with the preparation of these particulars but they are for general guidance only and complete accuracy cannot be guaranteed. If there is any point which is of particular importance then professional verification should be sought. These particulars do not constitute part, or all of, an offer or contract and are not to be relied upon as statement of representation or fact. Stepping Stones have not carried out a structural survey and the services, appliances, equipment, fixtures and fittings have not been tested and no guarantees as to their operating ability or efficiency are given. The measurements and floorplans supplied are for general guidance only and are not to scale. All dimensions and compass positions are approximate and for guidance only and should not be relied upon. Photographs are reproduced for general information and it cannot be inferred that any item shown is included in the letting.

