

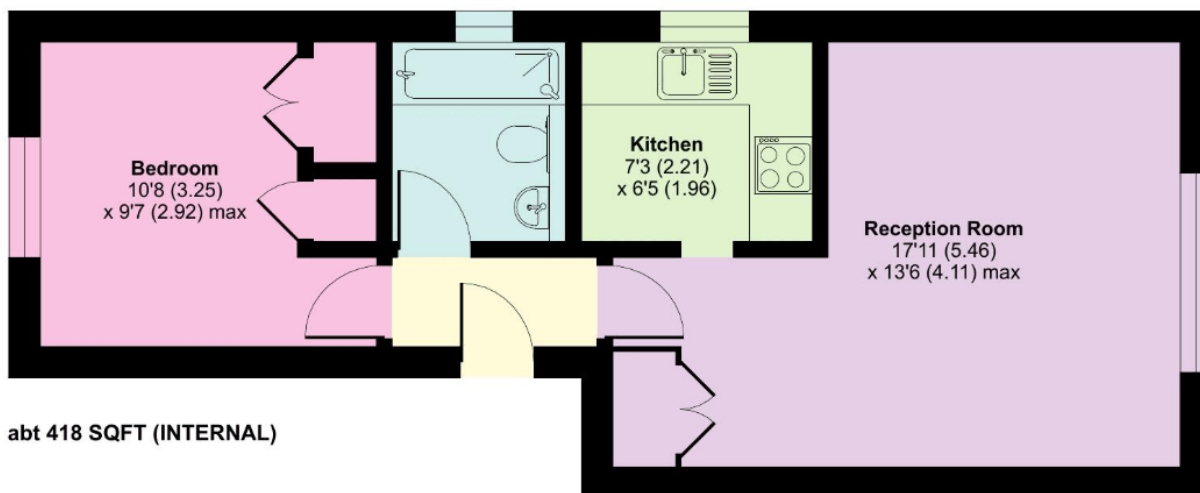

## **Ainsley Close, London, N9**

Paul Simon are pleased to present this stunning refurbished one-bedroom apartment, on the first floor of this well-maintained purpose-built building. Located in a quiet residential turning bordering Bush Hill Park, Winchmore Hill & Edmonton. This property is ideal for first-time buyers or investors looking for a fantastic rental opportunity! The property comprises a spacious reception room, separate fully fitted kitchen, double bedroom with fitted wardrobes and modern fitted bathroom suite. Newly decorated and newly laminate flooring throughout. Additional benefits include double glazing, entry phone system and the property also comes with its own allocated parking space. You'll love the easy access to local transport links, connecting you to Enfield Town shopping centre as well as Bush Hill Park Station (0.8 miles) Edmonton Green station (0.9 miles) & Winchmore Hill Station (1.0 miles). Don't miss out on the opportunity to own a fantastic flat in a highly desirable location.

**Asking Price £230,000**



Score	Energy rating	Current	Potential
92+	A		
81-91	B		
69-80	C		78 C
55-68	D	68 D	
39-54	E		
21-38	F		
1-20	G		



Paul Simon Estate Agents  
786-788 Green Lanes, Winchmore Hill, N21 3RE  
T: 020 8800 1155 | E: info@paul-simon.co.uk  
VAT number: 439 956 200 | www.paulsimonestateagents.co.uk



Photographs are for illustration purposes and may depict items not included in the sale. If you have any queries relating to fixtures and fittings please refer to your legal advisor. These particulars provide an approximate description of the property. Accuracy is not guaranteed. Our description or mention of any appliances or services is not to be taken as guarantee that they are in working order. Purchasers are advised to make their own enquiries.