

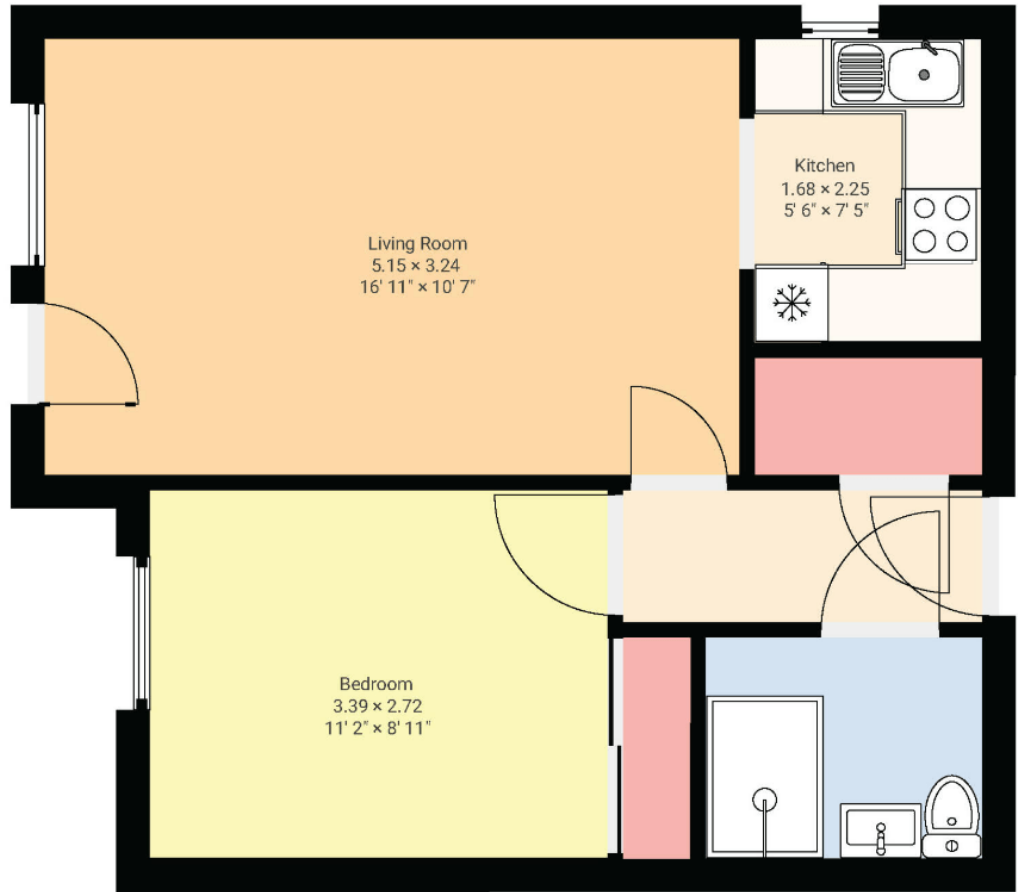

1 Bedroom Retirement Flat in North Finchley Paul Simon is pleased to offer this 1-bedroom ground floor warden assisted retirement flat (over 60's), perfectly situated in the heart of North Finchley. Designed for those aged 60 and above, this property offers both comfort and convenience. Upon entering, you'll appreciate the ease of ground floor living, eliminating the need for stairs, double bedroom, separate reception room with an open kitchen and door leading to patio. The flat also provides warden assistance, offering residents peace of mind and support whenever needed and a large communal residents' lounge.

DETAILS
Total area: 37.86 m² • 407.49 sq ft

▼ Ground Floor



THIS FLOORPLAN IS PROVIDED WITHOUT WARRANTY OF ANY KIND. SENSOPIA DISCLAIMS ANY WARRANTY, INCLUDING, WITHOUT LIMITATION, SATISFACTORY QUALITY OR ACCURACY OF DIMENSIONS.

