



Green Lanes N4
£1000 Per Calendar Month :

P00103

Green Lanes N4

Please review the floor plan for measurements before enquiring

Newly decorated first floor one bedroom flat. The property features open-plan kitchen and lounge, bathroom with shower facilities and separate double bedroom. Further benefits include brand new wood flooring and gas central heating.

The flat is located within easy reach to Arena shopping centre, local shops, restaurants, and the popular Green Lanes N4 shopping district. Transport links include Harringay Green Lanes BR, Manor House, and Turnpike Lane Stations (Piccadilly line). Excellent bus and train routes to central London and the City. Unfurnished / Part Furnished. Available February 2022.



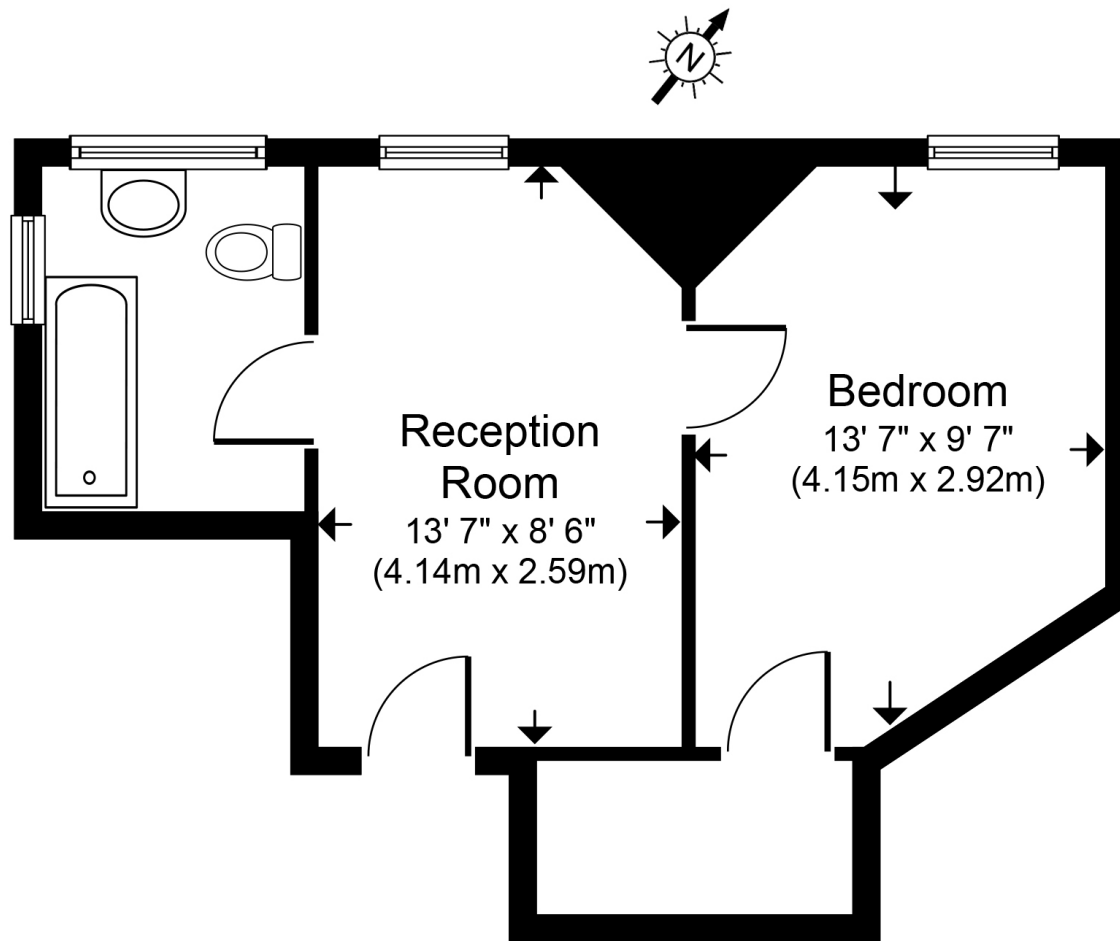

Floor Plan

High Road, London, N4
Gross internal area 321 sq ft /30 sq metres
Not to Scale. Produced by The Plan Portal 2017
For Illustrative Purposes Only.