



Flat 3, Church Mews Church Lane, Knaresborough, HG5 9AR
£169,995

The Property Perspective

Garden Place, Victoria Street, Altrincham, WA14 1ET

Tel: 08456 800 262 Fax: 08456 800 272

Email: enquiries@thepropertyperspective.co.uk www.thepropertyperspective.co.uk

PROPERTY
PERSPECTIVE

We are delighted to offer for sale this well presented apartment located in a popular position in the heart of Knaresborough with access to amenities and transport links.

The property benefits from central heating and double glazing. There is a modern dining kitchen with appliances plus a modern bathroom. Items of note include fitted wardrobes to the bedroom plus window shutters to the front rooms. There are ample sockets and media points to the property. The home is ready to move in with flooring included as fitted.

The property consists of an entrance hall, lounge, dining kitchen, double bedroom and bathroom.

There are well presented communal areas. There is a covered off road parking space.

Tenure - Leasehold (Owner is also 1 of the 4 Freeholders)

Ground Rent - Nil

Estate Management Fee - £480 pa

Council Tax - Band B

The property comprises.

INTERNAL

Entrance Hall

With fitted carpets.

Lounge 11'11" x 9'8" (3.64m x 2.97m)

With recessed spot lights, carpets and shutters.

Dining Kitchen 12'0"(max) x 8'1"(max) (3.68m(max) x 2.47m(max))

Having a comprehensive range of gloss wall and base units with complimenting laminate worktops and upstands plus stainless steel splash back. With oven, hob, hood, dishwasher, fridge and washing machine.

Bedroom 14'7"(max) x 8'2"(max) (4.47m(max) x 2.50m(max))

A double bedroom with built in wardrobes, carpets and shutters.

Bathroom 8'0" x 5'9" (2.44m x 1.77m)

Having modern white sanitary ware with shower to bath and screen plus tiling, vanity unit, chrome ladder radiator, vinyl flooring and shutters.

COMMUNAL

There are well presented communal areas. There is a covered off road parking space.

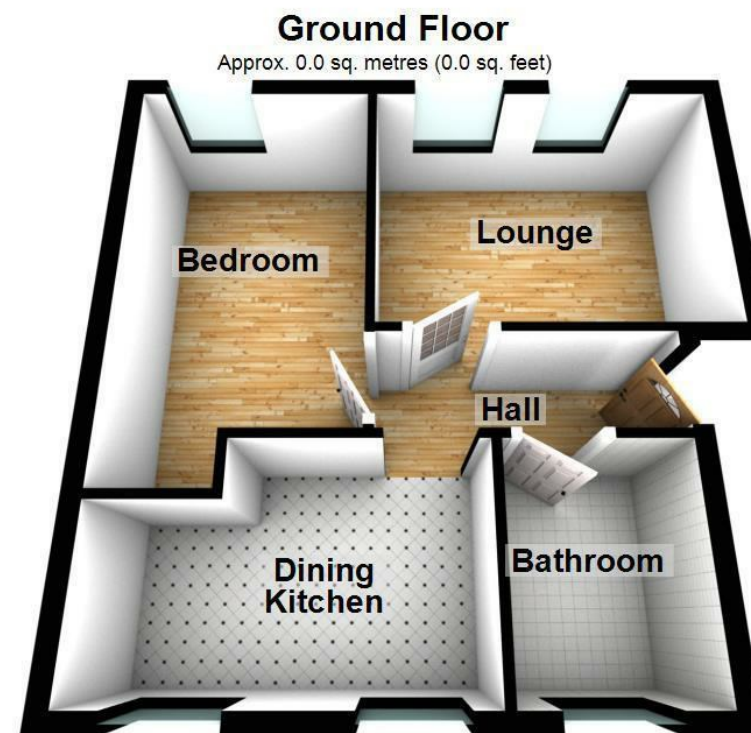

Total area: approx. 0.0 sq. metres (0.0 sq. feet)