



1 Mossfields, Alsager, ST7 2LA
£215,000

GROUND FLOOR

Lounge 10'6" x 12'1" (3.22 x 3.69m)

Carpet flooring with open fire and blind

Kitchen/diner 12'1" x 18'3" (3.70 x 5.58m)

High quality vinyl flooring with patio doors leading to the rear garden, spotlighting and blind. A range of fitted kitchen units, worktops and integrated kitchen appliances, including double oven, hob, hood and fridge-freezer

FIRST FLOOR

Bedroom 10'4" x 11'0" (3.16 x 3.36m)

Carpet flooring with window to the rear elevation, curtains, blind and fitted wardrobes

Bedroom 11'10" x 8'9" (3.63 x 2.69m)

Carpet flooring with window to the front elevation and blind

Bedroom 9'2" x 9'0" (2.81 x 2.76m)

Carpet flooring with windows to the side/rear elevation and blind

Bathroom

Tile flooring with 3 piece bathroom suite in white, shower over bath with glass splash-back screen, spotlighting, heated towel rail and partially tiled decor

EXTERNAL

Beautifully presented and private rear garden with laid to lawn and patio area. Ample off-road parking to the front of the property, capable of accommodating 4/5 vehicles.

FREEHOLD

COUNCIL TAX BAND - B

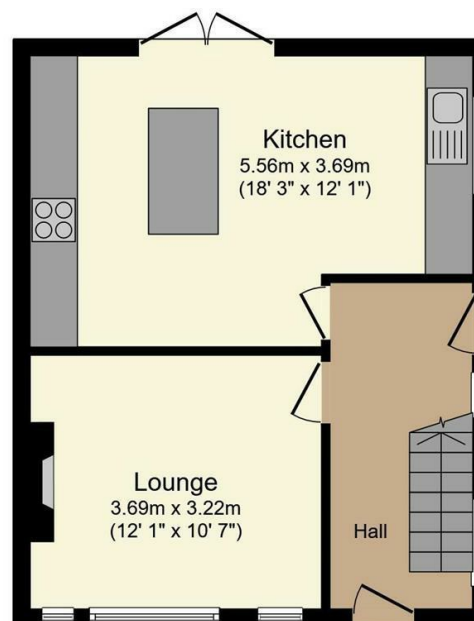

Ground Floor

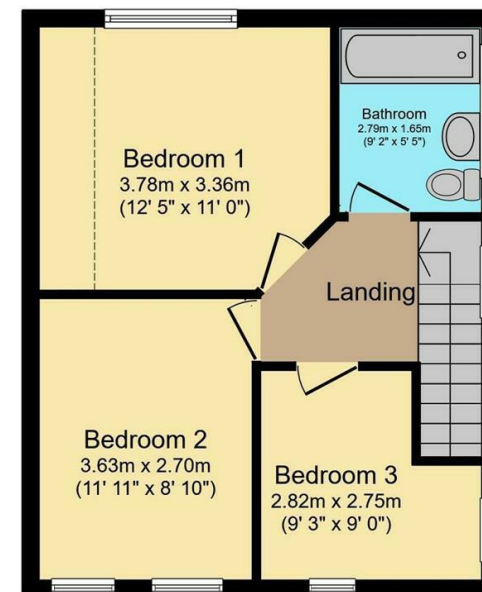

First Floor

Total floor area 78.5 m² (845 sq.ft.) approx

This floor plan is for illustrative purposes only. It is not drawn to scale. Any measurements, floor areas (including any total floor area), openings and orientation are approximate. No details are guaranteed, they cannot be relied upon for any purpose and they do not form part of any agreement. No liability is taken for any error, omission or misstatement. A party must rely upon its own inspection(s). Plan produced for Purplebricks. Powered by www.focalagent.com