

OFFERS IN THE REGION OF

£275,000

12 Waters Edge, Langsett

S36 4GY

PROPERTY SUMMARY

Nestled in the charming village of Langsett, near Penistone and Stocksbridge, this delightful cottage offers a perfect blend of rural tranquility and modern convenience. With three bedroomed accommodation this property is ideal for families or those seeking a peaceful retreat.

3



1



1









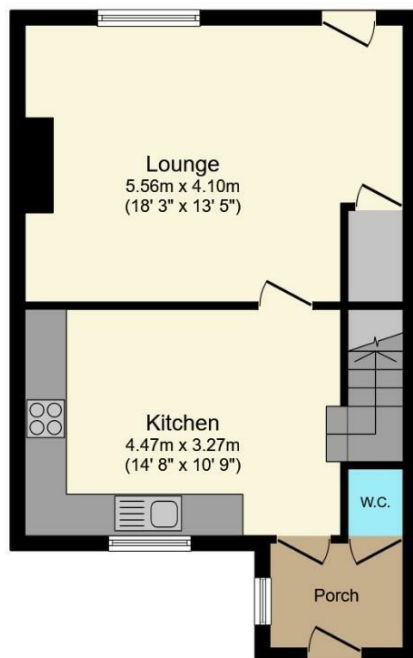

Ground Floor

Floor area 43.4 sq.m. (467 sq.ft.)

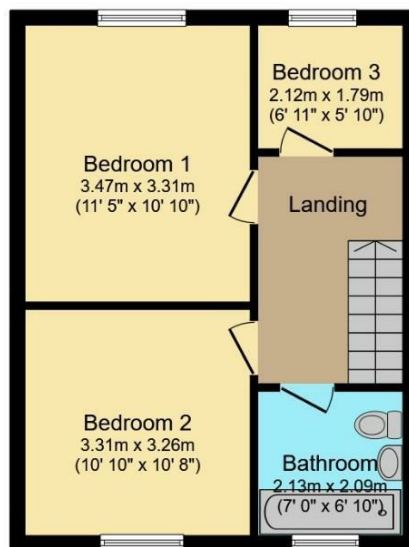

First Floor

Floor area 56.3 sq.m. (606 sq.ft.)

LOCAL AUTHORITY

BMBC

TENURE

Freehold

COUNCIL TAX BAND

C

VIEWINGS

By prior appointment only

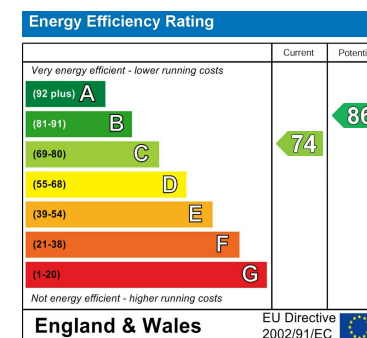

Agents Note: Whilst every care has been taken to prepare these particulars, they are for guidance purposes only. All measurements are approximate and are for general guidance purposes only and whilst every care has been taken to ensure their accuracy, they should not be relied upon and potential buyers/tenants are advised to recheck the measurements

Total floor area: 99.6 sq.m. (1,072 sq.ft.)

This floor plan is for illustrative purposes only. It is not drawn to scale. Any measurements, floor areas (including any total floor area), openings and orientations are approximate. No details are guaranteed, they cannot be relied upon for any purpose and do not form any part of any agreement. No liability is taken for any error, omission or misstatement. A party must rely upon its own inspection(s). Powered by www.Propertybox.io

OFFICE ADDRESS

12 St Marys Street
Penistone
Sheffield
South Yorkshire
S36 6DT

OFFICE DETAILS

01226 766755
info@pennineproperty.co.uk