



OFFERS IN THE REGION OF

£225,000

Inchburn Crescent

Penistone, S36 6FE

## PROPERTY SUMMARY

A charming modern home located in the picturesque market town of Penistone, within a short walk to the pennine trail and train station providing a perfect blend of convenience and tranquillity. Having three bedrooms well presented accommodation with parking for two plus fully enclosed rear garden.

3



1



1









GROUND FLOOR  
416 sq.ft. (38.6 sq.m.) approx.

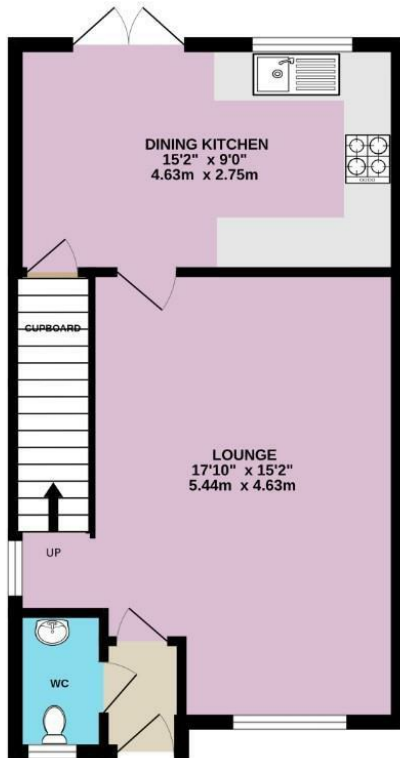

1ST FLOOR  
408 sq.ft. (37.9 sq.m.) approx.

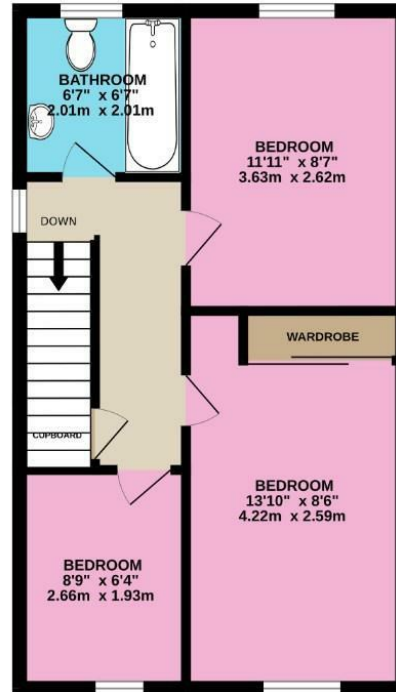

TOTAL FLOOR AREA : 824 sq.ft. (76.6 sq.m.) approx.

Whilst every attempt has been made to ensure the accuracy of the floorplan contained here, measurements of doors, windows, rooms and any other items are approximate and no responsibility is taken for any error, omission or mis-statement. This plan is for illustrative purposes only and should be used as such by any prospective purchaser. The services, systems and appliances shown have not been tested and no guarantee as to their operability or efficiency can be given.  
Made with Metropix ©2024

**LOCAL AUTHORITY**  
BMBC

**TENURE**  
Freehold

**COUNCIL TAX BAND**  
B

**VIEWINGS**  
By prior appointment only

Energy Efficiency Rating		Current	Potential
<i>Very energy efficient - lower running costs</i>			
(92 plus) <b>A</b>			<b>87</b>
(81-91) <b>B</b>		<b>72</b>	
(69-80) <b>C</b>			
(55-68) <b>D</b>			
(39-54) <b>E</b>			
(21-38) <b>F</b>			
(1-20) <b>G</b>			
<i>Not energy efficient - higher running costs</i>			
<b>England &amp; Wales</b>		EU Directive 2002/91/EC	

Agents Note: Whilst every care has been taken to prepare these particulars, they are for guidance purposes only. All measurements are approximate and are for general guidance purposes only and whilst every care has been taken to ensure their accuracy, they should not be relied upon and potential buyers/tenants are advised to recheck the measurements

**OFFICE ADDRESS**

12 St Marys Street  
Penistone  
Sheffield  
South Yorkshire  
S36 6DT

**OFFICE DETAILS**

01226 766755  
info@pennineproperty.co.uk