



7 Horsefair Close Picklenash Grove
Newent GL18 1SD



STEVE GOOCH
ESTATE AGENTS | EST 1985

7 Horsefair Close Picklenash Grove

£469,950

Newent GL18 1SD

BUILT IN 2021 is this **SPACIOUS FOUR BEDROOM DETACHED HOUSE, LARGE OPEN PLAN KITCHEN / DINING / FAMILY ROOM, SEPARATE SITTING ROOM, DOWNSTAIRS STUDY, MASTER EN-SUITE, SEPARATE GYM / OFFICE.**

COUNTRYSIDE VIEWS TO THE FRONT, OFF ROAD PARKING FOR FOUR CARS, 7 YEARS NHBC WARRANTY REMAINING situated **CLOSE TO THE MARKET TOWN OF NEWENT.**

We are delighted to offer for sale this immaculately presented four bedroom detached family home located on the fringe of the market town of Newent, a historical, picturesque town on the edge of the Forest of Dean.

KEY FEATURES:

- Spacious Four Bedroom Detached House
- Large Open Plan Kitchen/Dining/Family Room
- Kitchen Upgrade installed Since Current Ownership
- Separate Sitting Room
- Downstairs Study
- Master En-Suite
- Separate Gym/Office Space
- Driveway Parking To Accommodate Four Cars
- Landscaped Garden
- Countryside Views
- 7 Years NHBC Warranty Remaining
- EPC Rating - B
- Council Tax - E, Freehold

LOCATION:

Situated in close proximity is Newent Lake - known as the 'jewel in the crown' which is a haven for wildlife and home to a variety of freshwater fish and Newent Arboretum - offering a tranquil environment for leisurely dog walks.

Newent is served by three schools, with others on offer just a short drive away. A doctors and dentist surgery, sports and leisure facilities and local sports clubs to include Newent and Gorsley Youth FC, Newent AFC, Newent RFC and Newent Cricket Club. There are several golf clubs within close proximity. For those cycling enthusiasts there is the Newent Loop, a 28 mile on road cycling route through the quiet roads and lanes of the Gloucestershire countryside.



The property is accessed via a composite door into:

ENTRANCE HALL

11'01 x 10'07 (3.38m x 3.23m)

Power points, radiator, stairs leading to the first floor, under stairs storage cupboard.

CLOAKROOM

5'03 x 5'01 (1.60m x 1.55m)

Low-level WC, wall mounted wash hand basin, part tiled walls, radiator, fitted mirror on the back wall, door to further under stairs storage cupboard.

KITCHEN / DINING / FAMILY ROOM

31'0 x 10'07 (9.45m x 3.23m)

The kitchen has a range of base, wall and drawer mounted units, composite moulded worktops, Shaker style units, integrated fridge / freezer, bin, and dishwasher, undermount stainless steel sink with mixer tap above, power points, appliance points, inset ceiling spotlights, side aspect double glazed UPVC windows. The kitchen has a peninsula with storage to both sides.

The dining area has radiators, power points, feature panelled walls, front and side aspect double glazed UPVC windows.

The family room has a radiator, power points, feature panelled walls, television point, rear aspect double glazed UPVC double doors and windows out onto the decking and the garden beyond.

Door through to:

UTILITY ROOM

9'03 x 4'03 (2.82m x 1.30m)

Base and wall mounted units, rolled edge worktops, single bowl single drainer stainless steel sink unit with mixer tap above, space and plumbing for washing machine, radiator, wall mounted gas fired combi boiler, rear aspect double glazed composite door leading out to the garden.





STUDY

6'08 x 6'06 (2.03m x 1.98m)

Radiator, power points, feature panelled walls, television point, front aspect double glazed UPVC window.

SITTING ROOM

15'02 x 10'03 (4.62m x 3.12m)

Radiator, power points, feature panelled walls, television point, rear aspect double glazed UPVC double doors and windows out onto the decking and the garden.

FROM THE ENTRANCE HALL, STAIRS LEAD TO THE FIRST FLOOR.

LANDING

Spacious landing area, suitable for chair and desk if required, power points, radiator, inset ceiling spotlights, access to loft space, door to airing cupboard, rear aspect double glazed UPVC window.

BEDROOM 1

15'0 x 11'10 into wardrobe recess (4.57m x 3.61m into wardrobe recess)

Power points, radiator, feature panelled walls, mirrored sliding doors to built-in wardrobe, front aspect double glazed UPVC window affording lovely views towards the park and the countryside beyond.

EN-SUITE SHOWER ROOM

7'02 x 4'06 (2.18m x 1.37m)

Tiled flooring, part tiled walls, double shower unit with shower off the mains, low-level WC, wall mounted wash hand basin, heated towel rail, inset ceiling spotlight and front aspect double glazed UPVC frosted window.

BEDROOM 2

12'01 x 10'09 (3.68m x 3.28m)

Radiator, power points, feature panelled wall, rear aspect double glazed UPVC window.

BEDROOM 3

11'09 x 10'05 (3.58m x 3.18m)

Radiator, power points, door to built-in wardrobe, front aspect double glazed UPVC window with lovely countryside views to the front.



BEDROOM 4

10'06 x 9'01 (3.20m x 2.77m)

Radiator, power points, rear aspect double glazed UPVC window.

BATHROOM

7'02 x 6'03 (2.18m x 1.91m)

Tiled flooring, part tiled walls, white panelled bath with shower over, wall mounted wash hand basin, low-level WC, heated towel rail, inset ceiling spotlights, side aspect double glazed UPVC window.

OUTSIDE

A block paved private drive in turn leads to the driveway for the property which has off road parking for three vehicles. The front garden is laid to lawn with shrubs and landscaped with pebbles and a patio paved path leads to the front door. At the end of the driveway is:

GARAGE

Accessed via an up and over door and split into three sections.

10'07 x 5'10 - storage compartment to the front.

10'02 x 6'11 - double doors in from the rear, this section is currently being used as a gym.

10'07 x 6'11 - additional storage room accessed via the gym.

Gated access leads to the rear garden where there is a large decked seating area suitable for outside table and chairs, outside tap, outside power points. The rear garden has been landscaped and is laid to lawn with a pebbled border and shrubs. The garden wraps round to behind the garage where there is extra space.

SERVICES

Mains water, electricity and drainage. Gas-fired heating.

Fibre broadband is available at the property.

WATER RATES

Severn Trent - to be confirmed.

AGENT'S NOTE

£300 per annum payable for maintenance of the public areas.





LOCAL AUTHORITY

Council Tax Band: E
Forest of Dean District Council, Council Offices, High Street, Coleford, Glos. GL16 8HG.

TENURE

Freehold.

VIEWING

Strictly through the Owners Selling Agent, Steve Gooch, who will be delighted to escort interested applicants to view if required. Office Opening Hours 8.30am - 7.00pm Monday to Friday, 9.00am - 5.30pm Saturday.

DIRECTIONS

From Newent, head out on the Ross Road on the B4221. Take the right hand turning into Valegro Avenue. Follow this road along and Horsefair Close will be found on the left hand side. Proceed along Horsefair Close and the property will be found on your left hand side.

PROPERTY SURVEYS

Qualified Chartered Surveyors (with over 20 years experience) available to undertake surveys (to include Mortgage Surveys/RICS Housebuyers Reports/Full Structural Surveys).

AWAITING VENDOR APPROVAL

These details are yet to be approved by the vendor. Please contact the office for verified details.

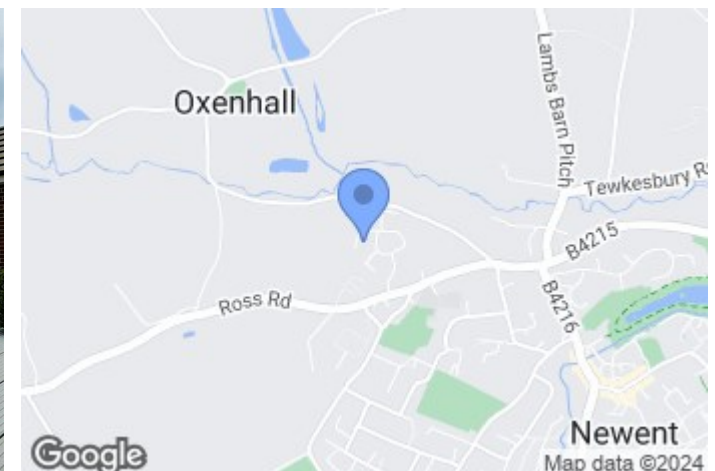

GROUND FLOOR



1ST FLOOR

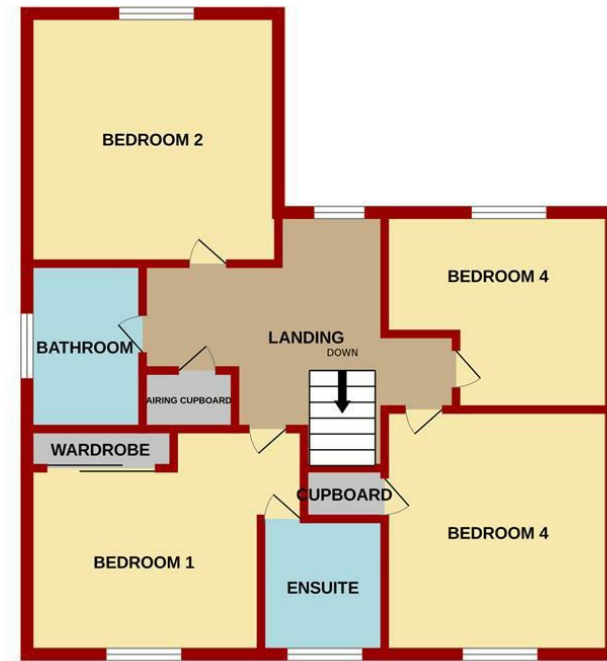

Measurements are approximate. Not to scale. Illustrative purposes only
Made with Metropix ©2023

MISREPRESENTATION DISCLAIMER

All reasonable steps have been taken with the preparation of these particulars but complete accuracy cannot be guaranteed. If there is any point which is of particular importance to you, please obtain professional confirmation. Alternatively, where possible we will be pleased to check the information for you. These particulars do not constitute a contract or part of a contract. All measurements quoted are approximate. The fixtures, fittings and appliances have not been tested and therefore no guarantee can be given that they are in working order. Any drawings, sketches or plans are provided for illustrative purposes only and are not to scale. All photographs are reproduced for general information and it cannot be inferred that any items shown are included in the sale.

Energy Efficiency Rating		Environmental Impact (CO ₂) Rating	
	Current	Potential	
Very energy efficient - lower running costs (92 plus) A (81-91) B (69-80) C (55-68) D (39-54) E (21-38) F (1-20) G Not energy efficient - higher running costs	86	93	Very environmentally friendly - lower CO ₂ emissions (92 plus) A (81-91) B (69-80) C (55-68) D (39-54) E (21-38) F (1-20) G Not environmentally friendly - higher CO ₂ emissions
England & Wales	EU Directive 2002/91/EC	EU Directive 2002/91/EC	England & Wales





4 High Street, Newent, Gloucestershire. GL18 1AN | (01531) 820844 | newent@stevegooch.co.uk | www.stevegooch.co.uk

Residential Sales | Residential Lettings | Auctions | Surveys