

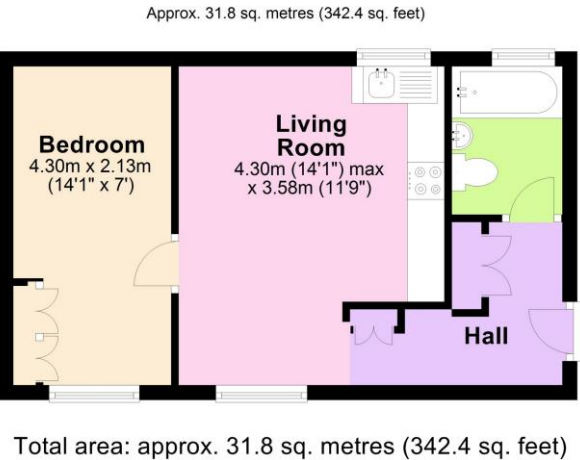

1 Bedroom Flat  
Belsize Road  
London NW6

- Purpose Built Block
- Open plan fitted kitchen
- Laminate floors
- Three piece bathroom

Price: £300 pw / £1,300 pcm



Environmental Impact (CO <sub>2</sub> ) Rating		
	Current	Potential
Very environmentally friendly - lower CO <sub>2</sub> emissions		
(92-100) <b>A</b>		
(81-91) <b>B</b>		
(69-80) <b>C</b>		
(55-68) <b>D</b>		<b>61</b>
(39-54) <b>E</b>	<b>43</b>	
(21-38) <b>F</b>		
(1-20) <b>G</b>		
Not environmentally friendly - higher CO <sub>2</sub> emissions		
England, Scotland & Wales		EU Directive 2002/91/EC

Energy Efficiency Rating		
	Current	Potential
Very energy efficient - lower running costs		
(92-100) <b>A</b>		
(81-91) <b>B</b>		
(69-80) <b>C</b>		<b>77</b>
(55-68) <b>D</b>	<b>55</b>	
(39-54) <b>E</b>		
(21-38) <b>F</b>		
(1-20) <b>G</b>		
Not energy efficient - higher running costs		
England, Scotland & Wales		EU Directive 2002/91/EC

Newly redecorated one double bedroom second floor apartment (342 Sq Ft.) within this purpose built block located between South Hampstead and Swiss Cottage. Comprising fitted wardrobes to the master bedroom, dual aspect open plan kitchen/reception room and a three piece bathroom suite. Further benefits include laminate floors, double glazing and good storage. Belsize Road is ideally placed for easy access to the many amenities and transport links offered at South Hampstead, Swiss Cottage and Finchley Road. Available part furnished from 9th August.

ML Estates wish to advise prospective purchasers that we have not checked the services or appliances. These particulars have been prepared as a guide only, any floor-plan or map is for illustrative purposes only. ML Estates, for themselves and for the vendors or lessors of this property whose agents they are given notice that: the particulars have been produced in good faith; do not constitute any part of a contract; no person in the employment of ML Estates has any authority to make or give any representation of warranty in relation to this property.