



HEARNES

WHERE SERVICE COUNTS

Oakwood Park  
Wimborne, Dorset, BH21 1SF



# Oakwood Park, Wimborne, Dorset, BH21 1SF

## FREEHOLD PRICES FROM: £450,000 - £500,000

Striking in size, shape and design, The Everglade is a family home to aspire to. Downstairs it's the expansive sitting room and spacious kitchen/dining/family room that dominate, with both running the length of the home. Extra-large windows in the former also flood the room with natural light, while the latter has a set of French doors leading out to the garden.

On the first floor, it's the primary bedroom that makes an immediately strong impression, with a fitted wardrobe and en suite, thought generous size bedroom two and three, sharing a separate family bathroom, are impressive too.

This property is situated in a popular location, conveniently located close to local amenities, parks and well sought after schools. Wimborne town centre is approximately 2 miles away offering further amenities including shops, restaurants, coffee shops and the popular Art Deco Tivoli theatre.



AGENTS NOTES: The heating system, mains and appliances have not been tested by Hearn's Estate Agents. Any areas, measurements or distances are approximate. The text, photographs and plans are for guidance only and are not necessarily comprehensive. Whilst reasonable endeavours have been made to ensure that the information in our sales particulars are as accurate as possible, this information has been provided for us by the seller and is not guaranteed. Any intending buyer should not rely on the information we have supplied and should satisfy themselves by inspection, searches, enquiries and survey as to the correctness of each statement before making a financial or legal commitment. We have not checked the legal documentation to verify the legal status, including the leased term and ground rent and escalation of ground rent of the property (where applicable). A buyer must not rely upon the information provided until it has been verified by their own solicitors.





Note: Measurements were not taken by LJT Surveying and we cannot guarantee their accuracy.

## Ground Floor

Approx. 54.0 sq. metres (580.8 sq. feet)

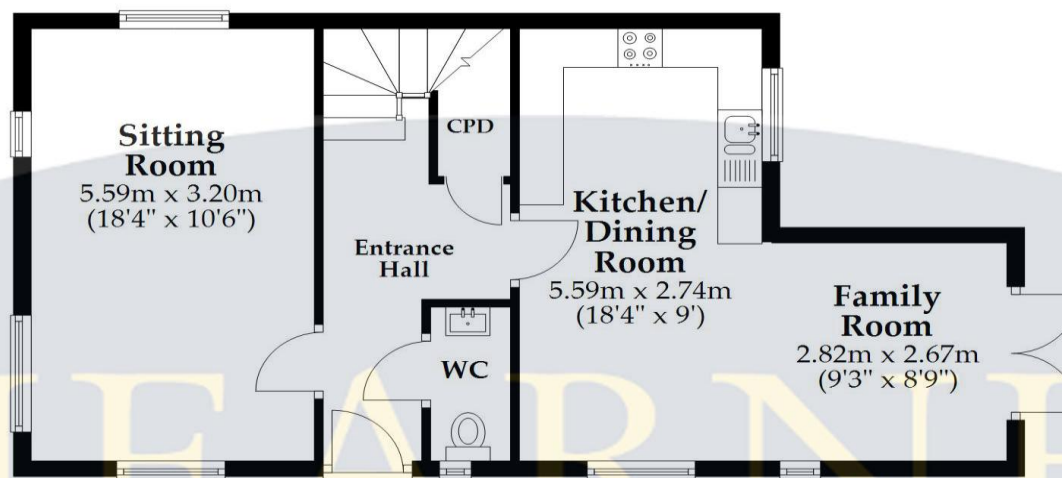

## First Floor

Approx. 46.2 sq. metres (496.8 sq. feet)

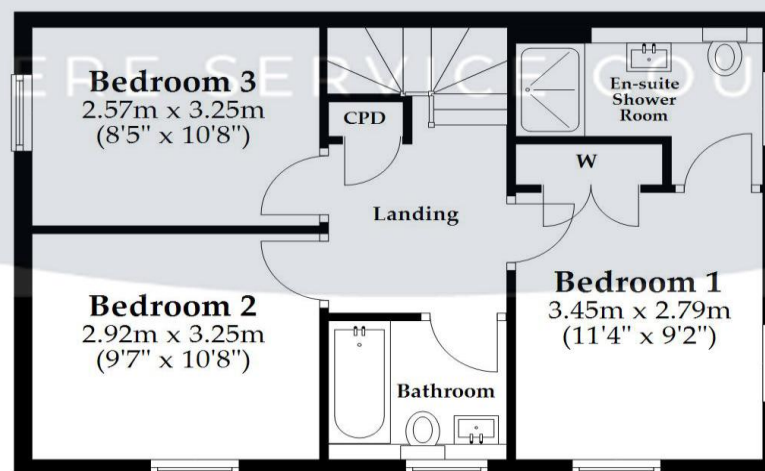

Total area: approx. 100.1 sq. metres (1077.5 sq. feet)

This plan is not to scale and is for general guidance only. LJT Surveying Ltd Ringwood





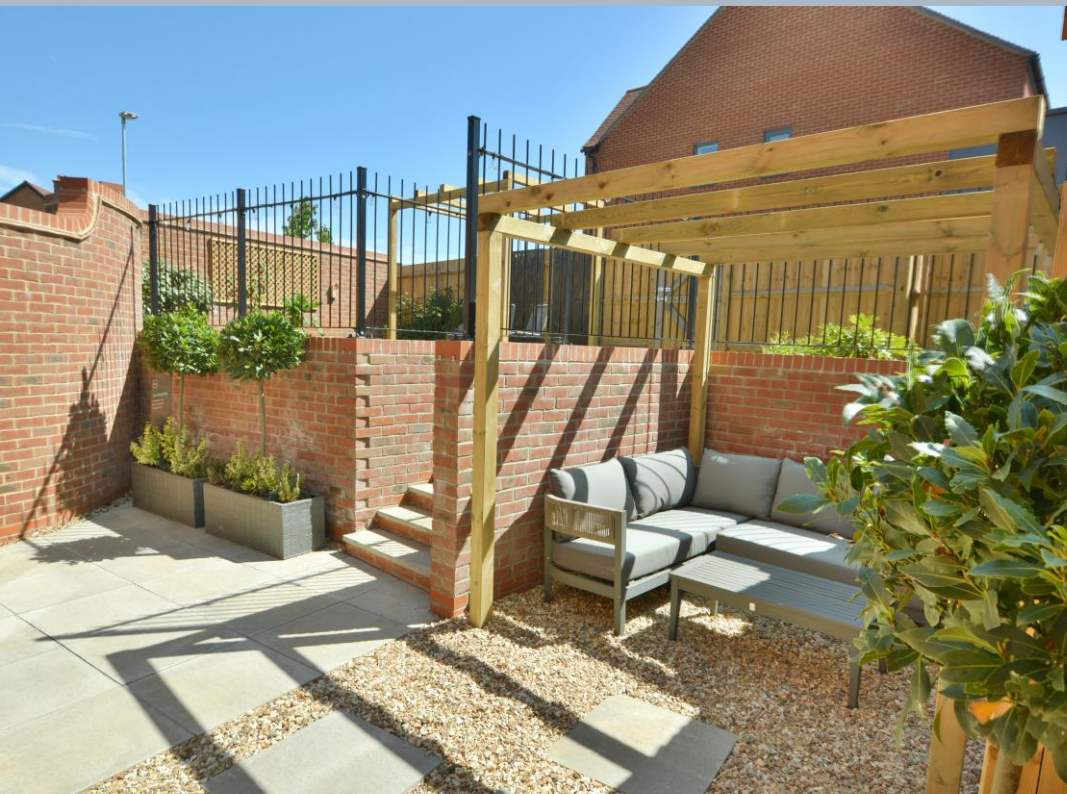



Riverside walks from the doorstep



Riverside walks from the doorstep



**HEARNES**

WHERE SERVICE COUNTS

[www.hearnes.com](http://www.hearnes.com)

6 Cook Row, Wimborne, Dorset BH21 1LB

Tel: 01202 842922 Email: [Wimborne@hearnes.com](mailto:Wimborne@hearnes.com)

OFFICES ALSO AT: BOURNEMOUTH, FERNDOWN, POOLE & RINGWOOD