



HEARNES

WHERE SERVICE COUNTS

Wimborne, Dorset, BH21 1SF

Wimborne, Dorset, BH21 1SF

FREEHOLD PRICES FROM: £595,000 - £625,000

With its flexible layout and generous proportions, The Laurel is a home designed to more than meet the demands of a family lifestyle. The extensive, dual aspect sitting room at the front is the perfect haven for some valuable 'me' time, while the spacious kitchen/dining/family room at the back opens out to the garden through a set of French doors. A handy utility room completes the impressive ground floor.

Upstairs the primary bedroom has an en suite, while bedrooms two, three and four share a family bathroom. Complete with garage and driveway parking.

This property is situated in a popular location, conveniently located close to local amenities, parks and well sought after schools. Wimborne town centre is approximately 2 miles away offering further amenities including shops, restaurants, coffee shops and the popular Art Deco Tivoli theatre.

AGENTS NOTES: The heating system, mains and appliances have not been tested by Hearn's Estate Agents. Any areas, measurements or distances are approximate. The text, photographs and plans are for guidance only and are not necessarily comprehensive. Whilst reasonable endeavours have been made to ensure that the information in our sales particulars are as accurate as possible, this information has been provided for us by the seller and is not guaranteed. Any intending buyer should not rely on the information we have supplied and should satisfy themselves by inspection, searches, enquiries and survey as to the correctness of each statement before making a financial or legal commitment. We have not checked the legal documentation to verify the legal status, including the leased term and ground rent and escalation of ground rent of the property (where applicable). A buyer must not rely upon the information provided until it has been verified by their own solicitors.





Note: Measurements were not taken
by LJT Surveying and we cannot
guarantee their accuracy.

Ground Floor

Approx. 66.6 sq. metres (716.7 sq. feet)

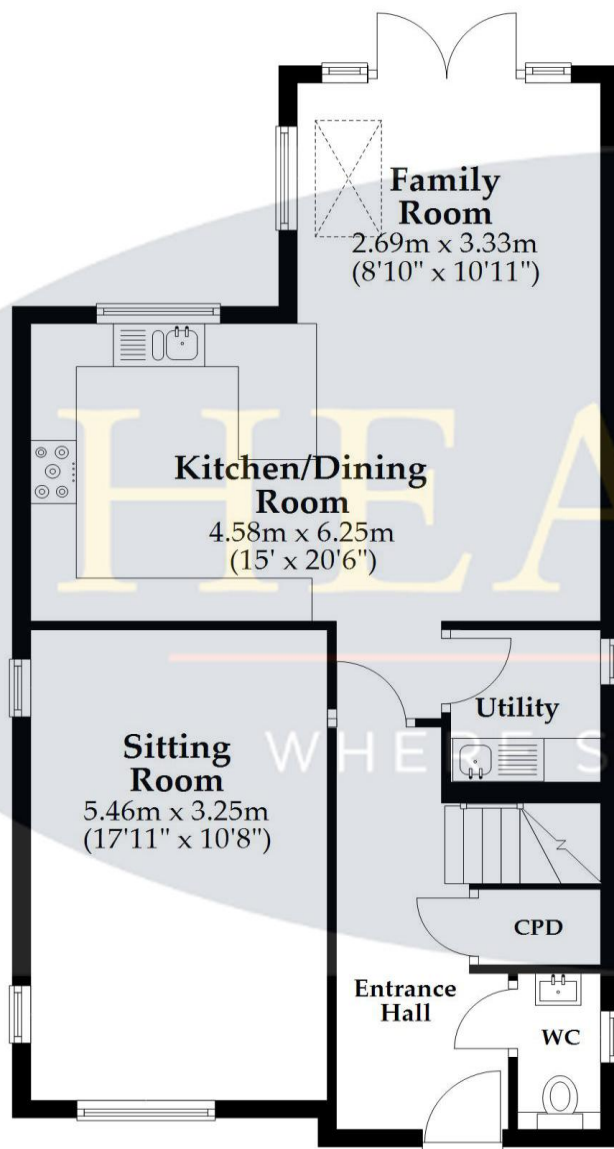

First Floor

Approx. 57.5 sq. metres (619.0 sq. feet)

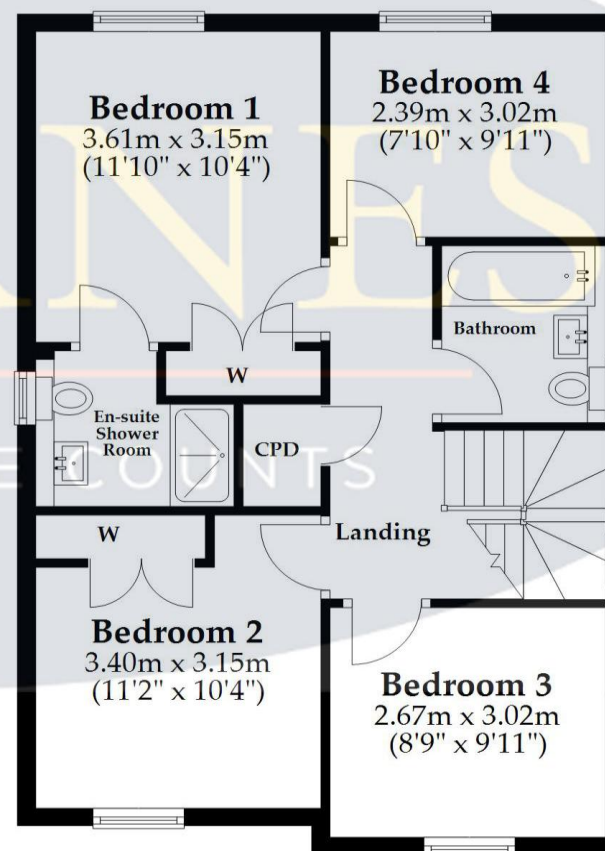

Total area: approx. 124.1 sq. metres (1335.7 sq. feet)

This plan is not to scale and is for general guidance only. LJT Surveying Ltd Ringwood





HEARNES

WHERE SERVICE COUNTS

www.hearnes.com

6 Cook Row, Wimborne, Dorset BH21 1LB

Tel: 01202 842922 Email: Wimborne@hearnes.com

OFFICES ALSO AT: BOURNEMOUTH, FERNDOWN, POOLE & RINGWOOD