



 **2**
Bedrooms

 **1**
Bathroom

Tenure :
Freehold



To be sold with no onward chain is this two bedroom end terrace property located on Wood Street in Castleford.

Call Tudor Sales & Lettings on 0113 282 3056 for more information or to arrange a viewing!

To be sold with no onward chain is this two bedroom end terrace property located on Wood Street in Castleford. This would make the perfect investment opportunity with there been a high level of demand for rental properties within this area. The internal layout comprises in brief: - ground floor: - entrance hallway, lounge and a kitchen. First floor: - landing, two double bedrooms and a bathroom. Benefits from double glazing and gas central heating. Externally, you have a low maintenance yard to the rear and a garage. Wood Street is within close proximity of Castleford Bus Station, making this the ideal base for those who daily commute. Castleford Town Centre and it's wide range of amenities are also within easy reach. Call Tudor Sales & Lettings on 0113 282 3056 for more information or to arrange a viewing!

Kitchen 14' 27" x 14' 31" (4.95m x 5.05m)

Fitted with a range of wall and base units. Laminated worktops. Sink and tap. Integrated oven and hob with extractor hood over. Tiled splashbacks. Laminated flooring. Plumbing for washing machine. Three double glazed windows. Central heating radiator.

Lounge 14' 27" x 12' 61" (4.95m x 5.21m)

Double glazed window. Central heating radiator. Laminated flooring.

Bedroom 1 15' 20" x 14' 27" (5.08m x 4.95m)

Double bedroom with laminated flooring. Double glazed window and a central heating radiator.

Bedroom 2 12' 85" x 8' 99" (5.82m x 4.95m)

Double bedroom with laminated flooring. Double glazed window and a central heating radiator.

Bathroom 9' 61" x 4' 92" (4.29m x 3.56m)

Three piece white suite comprising of: - bath with a shower over, wash hand basin and a wc. Part tiled walls. Double glazed window. Heated towel rail.

GROUND FLOOR

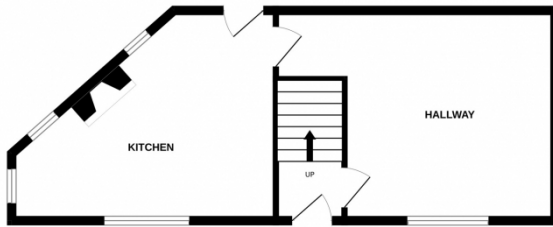

1ST FLOOR

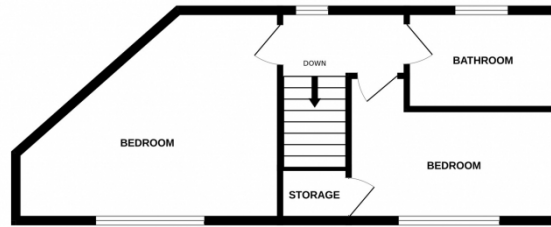

Whilst every attempt has been made to ensure the accuracy of the floorplan contained here, measurements of doors, windows, rooms and any other items are approximate and no responsibility is taken for any error, omission or mis-statement. This plan is for illustrative purposes only and should be used as such by any prospective purchaser. The services, systems and appliances shown have not been tested and no guarantee as to their operability or efficiency can be given.
Made with Metropix ©2024

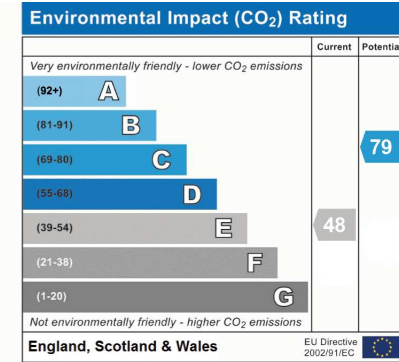
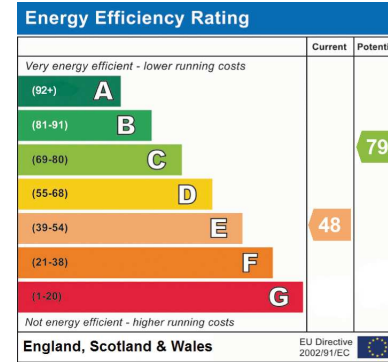

Address: Wood Street, Castleford

