



 **2**
Bedrooms

 **1**
Bathroom

Tenure :
Leasehold



Cash buyers only!

Call Tudor Sales & Lettings on 0113 282 3056 for more information or to arrange a viewing.

*****CASH BUYER ONLY*****

To be sold with no onward chain is this two bedroom, 10th floor flat, located in Greenwood House, on George Street in Wakefield. The internal layout of the flat comprises in brief: - entrance hallway, lounge, kitchen, two double bedrooms and a bathroom. Benefits from double glazed windows and electric heating. From the lounge area you have access to a balcony, giving you far reaching views over Wakefield Cathedral and further afield. The block has the benefit of a fully serviced lift. An allocated parking space and garage can be applied for through the council. Greenwood House is in Central Wakefield giving you easy access to all of the amenities Wakefield has to offer. For those who daily commute, Wakefield Train Station is within easy reach. Call Tudor Sales & Lettings on 0113 282 3056 for more information or to arrange a viewing! Estimated Leasehold Service charge for 2024 / 2025 is £922.36.

GROUND FLOOR

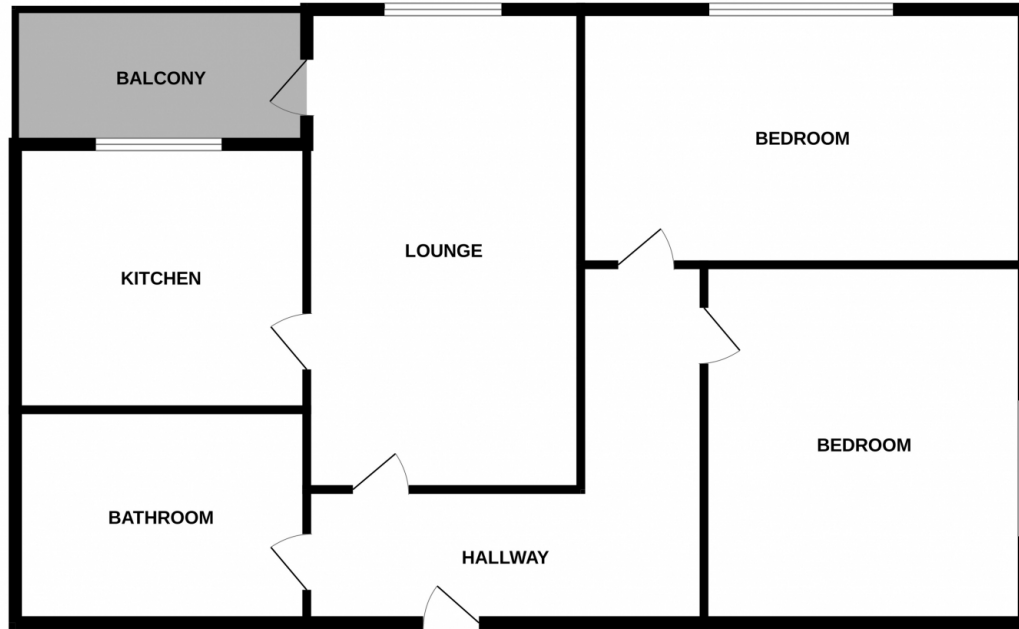

Whilst every attempt has been made to ensure the accuracy of the floorplan contained here, measurements of doors, windows, rooms and any other items are approximate and no responsibility is taken for any error, omission or mis-statement. This plan is for illustrative purposes only and should be used as such by any prospective purchaser. The services, systems and appliances shown have not been tested and no guarantee as to their operability or efficiency can be given.
Made with Metropix ©2024

