



 **2**  
Bedrooms

 **1**  
Bathroom

**Tenure :**  
**Freehold**



To be sold with no onward chain is this superb two bedroom mid terrace. Call Tudor Sales & Lettings on 0113 282 3056 for more information or to arrange a viewing.

To be sold with no onward chain is this superb, two bedroom mid terrace property located on West Street in Castleford. This would make the perfect first home and is well presented throughout. The internal layout comprises in brief: - ground floor: - lounge and a kitchen diner. First floor: - landing, two bedrooms and a bathroom. Benefits from double glazing and gas central heating. Externally there is a low maintenance garden to the rear. To the front, there is on street permit parking. West Street is within close proximity of Castleford Town Centre and it's wide range of amenities. Call Tudor Sales & Lettings today on 0113 282 3056 for more information or to arrange a viewing!

### **Kitchen / Diner**

Fit with wall and base units. Laminated worktops. Sink and tap. Integrated oven, hob and extractor hood over. Tiled splashback. Part tiled flooring. Plumbing for washing machine. Central heating radiator. Double glazed window.

### **Lounge**

Feature fireplace. Double glazed window. Central heating radiator. Coving to ceiling.

### **Bedroom 1**

Double bedroom with a central heating radiator and double glazed window. Coving to ceiling.

### **Bedroom 2**

Double glazed window and a central heating radiator. Coving to ceiling.

### **Bathroom**

Three piece white suite comprising of: - bath with shower over, wash hand basin and a wc. Heated towel rail. Double glazed window.

Offers in the region of £150,000  
West Street, Castleford

GROUND FLOOR

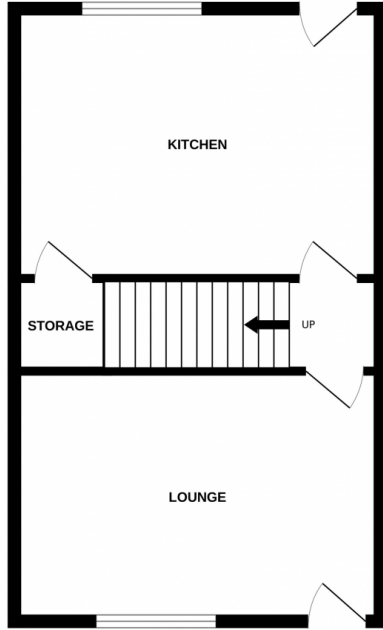

1ST FLOOR

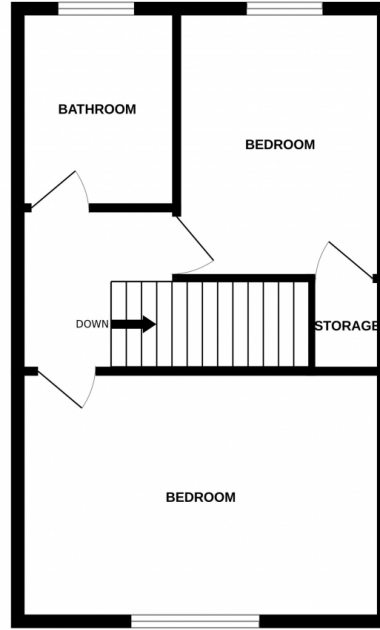

Whilst every attempt has been made to ensure the accuracy of the floorplan contained here, measurements of doors, windows, rooms and any other items are approximate and no responsibility is taken for any error, omission or mis-statement. This plan is for illustrative purposes only and should be used as such by any prospective purchaser. The services, systems and appliances shown have not been tested and no guarantee as to their operability or efficiency can be given.  
Made with Metropix ©2024

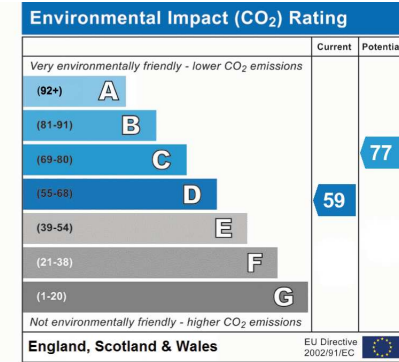
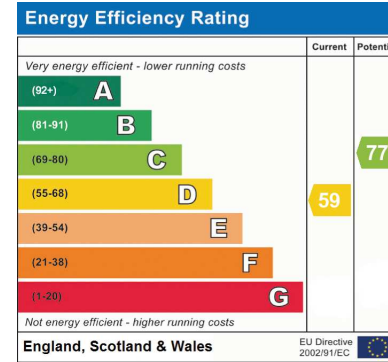

Address: West Street, Castleford

