



 **2**
Bedrooms

 **1**
Bathroom

Tenure :
Freehold



To be sold with no onward chain is this two bedroom mid terrace property located on Cyprus Grove in Garforth.

Call Tudor Sales & Lettings today on 0113 282 3056 for more information or to arrange a viewing!

To be sold with no onward chain is this two bedroom mid terrace property located on Cyprus Grove in Garforth. The internal layout comprises in brief: - ground floor: - kitchen and a lounge. First floor: - landing, two bedrooms and a bathroom. Externally, there is a low maintenance yard to the front. To the rear, is a larger than average garden and garage. Cyprus Grove is within close proximity of Garforth Train Station and the National Motorway Network, making this the perfect base for those who daily commute. Garforth Main Street is also only a short distance away giving access to a wide range of amenities. Call Tudor Sales & Lettings on 0113 282 3056 for more information or to arrange a viewing!

Kitchen 13' 9" x 11' 9" (4.19m x 3.58m)

Living room 11' 9" x 11' 7" (3.58m x 3.53m)

Bedroom 1 11' 9" x 11' 7" (3.58m x 3.53m)

Bedroom 2 8' 8" x 7' 8" (2.64m x 2.34m)

Bathroom 11' 9" x 4' 9" (3.58m x 1.45m)

GROUND FLOOR

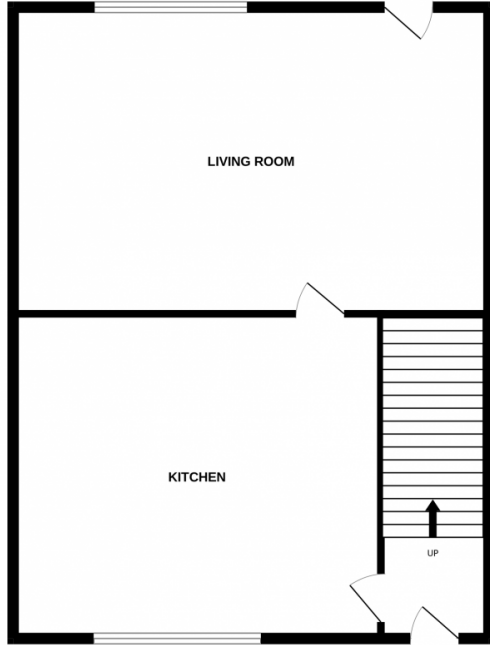

1ST FLOOR

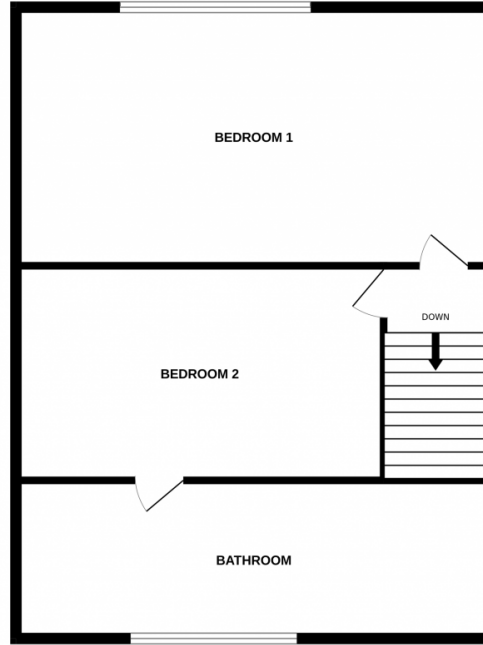

Whilst every attempt has been made to ensure the accuracy of the floorplan contained here, measurements of doors, windows, rooms and any other items are approximate and no responsibility is taken for any error, omission or mis-statement. This plan is for illustrative purposes only and should be used as such by any prospective purchaser. The services, systems and appliances shown have not been tested and no guarantee as to their operability or efficiency can be given.
Made with Metropix ©2024