



Great North Way, NW4

£325,000

An excellent opportunity to purchase this two bed ground floor flat located within this purpose built block. This home comes with two bathrooms, communal gardens, a private parking space and is offered chain free.

Lime Court is ideally located close to Copthall Playing Fields, Sunny Hill Park and the Laboratory Health Club and Spa.

Features

- Two Bedrooms
- Chain Free
- Two Bathrooms
- Private Parking Space
- Ground Floor
- Separate Kitchen

Great North Way, London, NW4

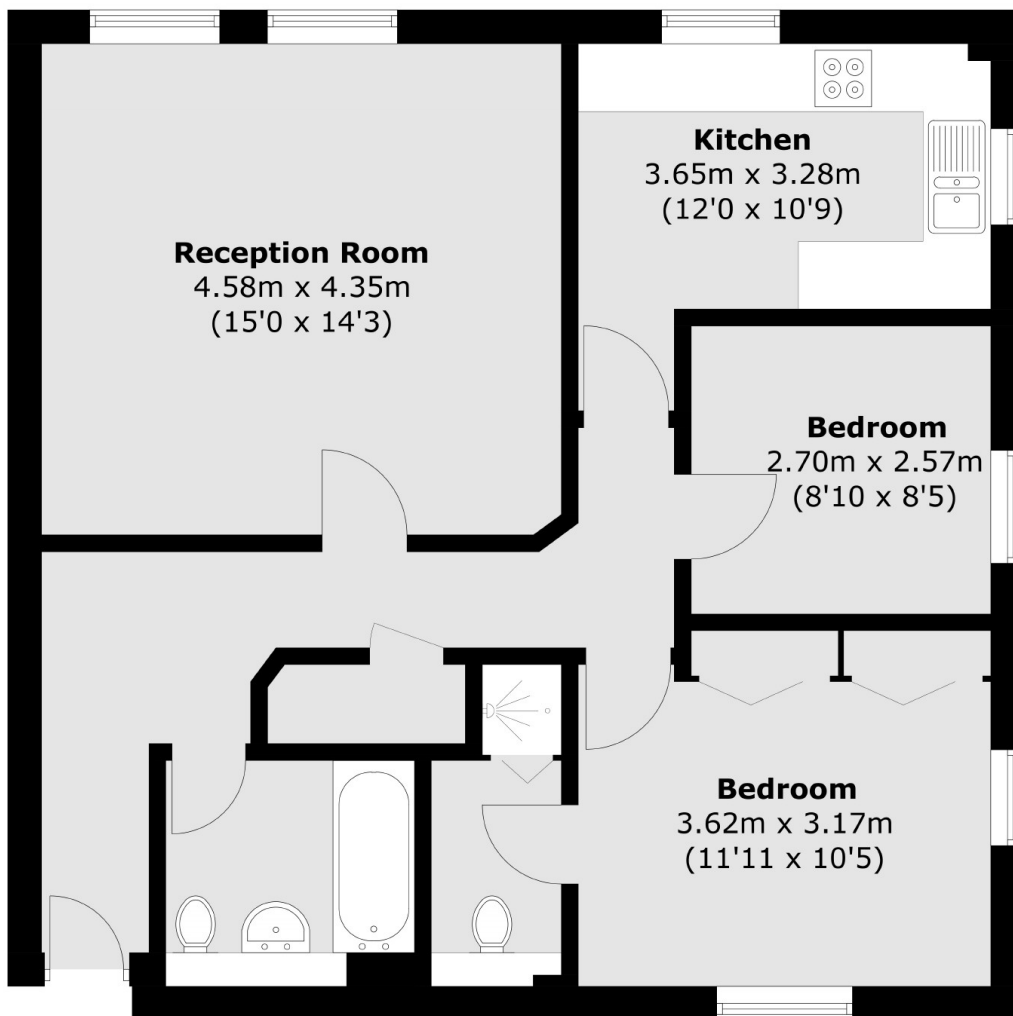

Total area (approx.): 69.9 sq. m (752.4 sq. ft)