



## Mornington Close, NW9

£1,900 Per calendar month

A modern two bedroom apartment on the second floor in this sought after block with a lovely kitchen open plan to living room and access to private balcony, spacious bedrooms with en-suite shower/WC's to main bedroom, family bathroom/WC, communal gardens, and secure gated parking.

Within easy reach of all amenities on Edgware Road (NW9) and moments from Colindale underground station and local shops.

### Features

Modern Spacious Property  
Close to Local Amenities  
Balcony  
Communal Gardens  
Two Bathroom/WC's  
Gated Parking

# Mornington Close, London, NW9

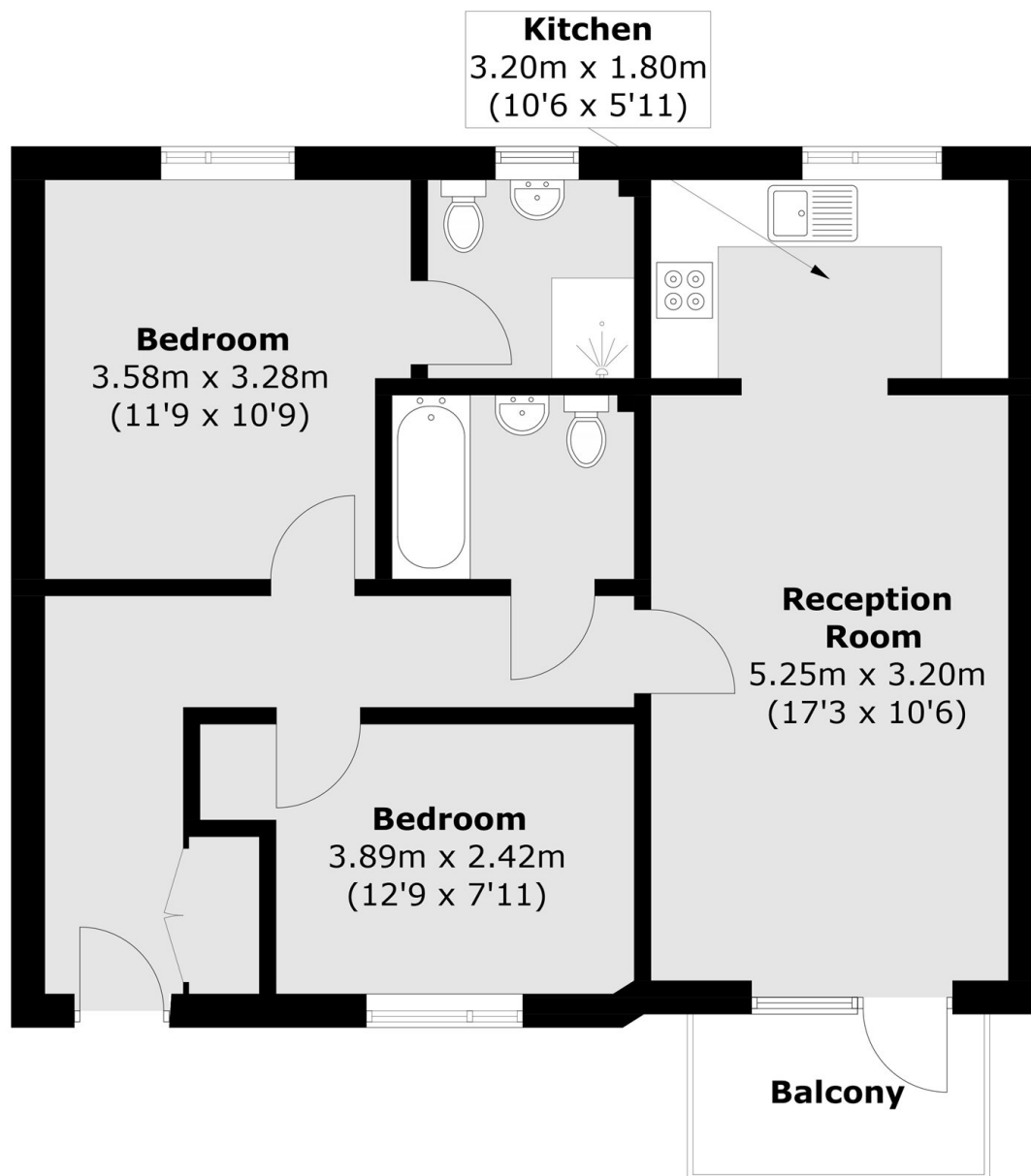

Total area (approx.): 63.0 sq. m (678.1 sq. ft)  
Balcony: 3.7 sq. m (39.8 sq. ft)